

A5900AA 15mm IS Underbasin Thermostatic Mixing Valve
A5901AA 22mm IS Underbasin Thermostatic Mixing Valve

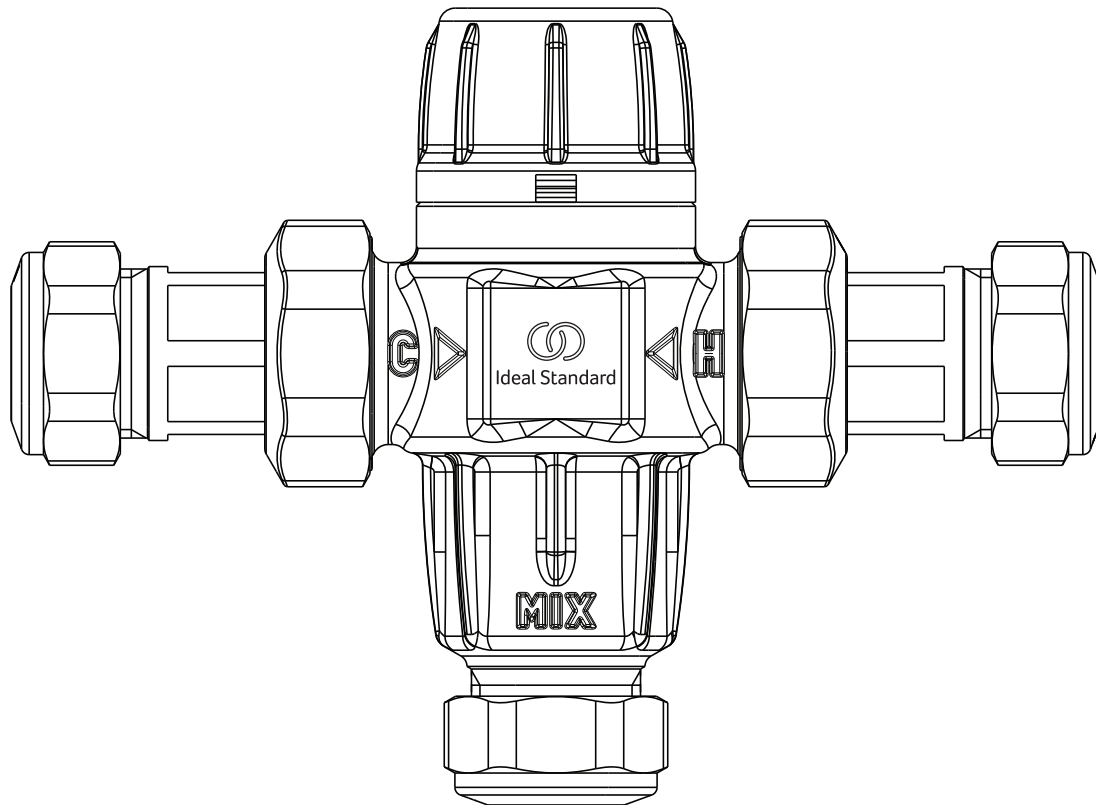

CERTIFICATION MARK



A5900/1 type 2

The following information is required for use when the Ideal A5900/1 AA thermostatic mixing valves are used in a TMV2 Applications under the requirements of BS EN 1111: 2017 “Sanitary tapware. Thermostatic Mixing Valve (PN 10). General Technical Specification” and BS EN 1287: 2017 “Sanitary tapware. Low pressure thermostatic mixing valves. General technical specifications”.

Introduction

The Ideal A5900/1 AA thermostatic mixing valves have been specifically designed and manufactured to meet the requirements of BS EN 1111: 2017 and BS EN 1287: 2017 and TMV Type 2 scheme. The valves have been independently tested and approved by Kiwa Watertec as a TYPE 2 valve under the Kiwa Watertec TMV Type 2 scheme.

TMV Type 2 scheme certified products comply with Building Regulation G3.

Technical Specification / Conditions for use Type 2 Valves

	High Pressure	Low Pressure
Max.Static Pressure	10 bar	10 bar
Flow Pressure, Hot & Cold	0.5 - 5 bar	0.1 - 1.0 bar
Hot Supply Temperature	55°C - 65°C	55°C - 65°C
Cold Supply Temperature	≤25°C	≤25°C
Temperature Stability	±2°C	±2°C
Min. Temp Differential (Mix to Hot) for fail-safe	10°C	10°C
Max. Pressure Inlet Differential	5:1	5:1

- NOTE: i) Valves operating outside these conditions cannot be guaranteed by the Scheme to operate as Type 2 valves.
ii) To ensure and maintain water quality, system water supply temperature should be maintained within certain criteria. This is laid out in a legal obligation document HSG247.
iii) HSG247 part 2 , Cold water should be stored and distributed at less than 20°C. Hot water should be stored at least 60°C and be delivered at 50°C in less than 1 minute of the outlet device being activated.

NB: If the outlet device is a mixing valve, the temperature of the hot water is 50°C, is measured at the hot water inlet to the mixing valve and not the mixing valve’s outlet.

TMV Type 2 mixing valves require a 55°C minimum hot supply.

Approvals

Kiwa Watertec Scheme Approval Number	Details Available on Request
WRAS Scheme Approval Number	Details Available on Request

Application

The valves designation of use, LP if tested against BS EN 1287, HP if tested against BS EN 1111 and HP and LP if tested against both standards.

The A5900/1 AA thermostatic mixing valves have been independently tested by Kiwa Watertec and certified as meeting the requirements of the BS EN 1111:2017 and BS EN 1287: 2017 under the TMV Type 2 scheme as being suitable for use on the following designations.

	High Pressure (HP 0.5 to 5 bar)	Low Pressure (LP 0.1 to 1 bar)
Wash Hand Basin (W)	HP-W	LP-W
Shower (S)	HP-S	LP-S
Bidet (B)	HP-B	LP-B
Bath Fill (T)*	HP-T	*22mm model only

If a water supply is fed by gravity then the supply pressure should be verified to ensure the conditions of use are appropriate for the valve. The installation of thermostatic mixing valves must comply with the requirements of the Water Supply (Water Fittings) Regulations 1999.

Recommended Outlet Temperatures

The Kiwa Watertec TMV scheme recommends the following set maximum mixed water outlet temperatures for use in all premises and then verified by undertaking the cold water isolation test.

Application	Recommended Set Mixed Water Temp.
Wash Hand Basin	41°C
Shower	41°C
Bidet	38°C
Bath Fill	44°C

- NOTE: i) The maximum mixed water outlet temperature i.e. 41°C max, 44°C etc being delivered during normal use can deviate by 2°C above the recommended set outlet temperature detailed in the table.
- ii) The tub/bath fill temperature in the table is not a safe bathing temperature for adults or children, it is a value that allows for heat loss during tub/bath filling. The British Burns Association recommends 37 to 37.5°C as a comfortable bathing temperature for children. In premises covered by the Care Standards Act 2000, the maximum water outlet temperature is 43°C.
- iii) All temperature measuring equipment should be calibrated and appropriate for measurement.

Installation

IMPORTANT: - The following instructions must be read prior to the installation of the A5900/1AA thermostatic mixing valves, the installer should also be aware of their responsibility and duty of care to ensure that all aspects of the installation comply with all current regulations and legislation.

It has been brought to our attention that flushing through water systems using certain chemicals may wholly or partially remove the lubricant from the internal workings of the valve, which may adversely affect its performance. We recommend that following flushing of the system with chemicals; valves are checked for correct operations.

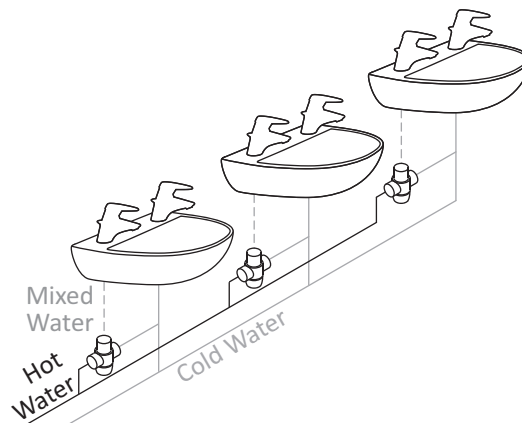

- The installation of thermostatic mixing valves must comply with the requirements of the Water Supply (Water Fittings) Regulations 1999 and Scottish Water Byelaws.
- The Thermostatic mixing valve must be installed in such a location that maintenance of the TMV using its isolating valves and that the commissioning and testing of the TMV can be undertaken.
- If isolation valves are not provided by the manufacturer, the fitting of isolation valves is required as close as is practicable to the water supply inlets of the thermostatic mixing valve.
- If strainers are not provided by the manufacturer, the fitting of strainers is recommended as close as is practicable to the water supply inlets of the thermostatic mixing valve.
- The temperature differential between the hot supply temperature and the maximum mixed water temperature is appropriate for the valve.
- Backflow prevention devices may be required to prevent contamination of the water supply from the downstream risk, see the Water Supply (Water Fittings) Regulations 1999, and Scottish Water Byelaws and the manufacturer's instructions.

Installation

- 1 It is essential that before installing any A5900/1 AA valves ensure that the supply conditions of the system to which the valve is intended to be fitted are checked to confirm compliance with the parameters as quoted within the Technical Specification and conditions on which the approval is granted i.e. verify supply temperatures, supply pressures, risk assessment.
- 2 Consideration must be made for the possibility of multiple/simultaneous demands being made on the supply system whilst the A5900/1 AA valves are in use, all practical precautions must be made to ensure that the valve is not affected. Failure to make provision within the pipe sizing etc. will affect the performance of the valve.
- 3 The supply system to which the A5900/1 AA valves are to be installed into must be thoroughly flushed and cleaned to remove any debris, which may have accumulated during the installation. Failure to remove any debris will affect the performance and the manufacturer's warranty of the product. Independent filters and isolation valves must be fitted in conjunction with the valve, as close as practically possible to the water supply inlets of the A5900/1 AA thermostatic valve. In areas that are subject to aggressive water, provision must be made to treat the water supply prior to the supply entering any Ideal product.
- 4 A5900/1 AA valves have been designed to ensure that the valve can be installed in any position whether vertical or horizontal, it can be surface mounted or within a supply duct. It is essential that the access to the valve is not obstructed for any future maintenance that may be required to the valve or associated fittings.
- 5 We recommend that the A5900/1 AA thermostatic mixing valves be installed as close as practically possible to the outlet, which it is serving. In this situation attention must be paid to the maximum distance of pipe work from the mixed water outlet of the valve to any terminal fitting.
- 6 Current guidelines recommend a maximum distance of 2 metres from the outlet of any mixing valve to the furthest terminal fitting/outlet to which the mixing valve is to serve.
- 7 The hot and cold water supplies must be connected to the valve strictly in accordance with the indications on the body of the valve i.e. hot water supply to the hot port of the valve.
- 8 In a situation where one or both of the water supplies are excessive, it is possible to fit a pressure reducing valve to reduce the pressure(s) to within the limits as quoted previously.
- 9 Any thermostatic mixing valve must be fitted with a back flow prevention device, such as check valves to prevent the cross contamination of supplies. The A5900/1 AA valves are complete with integral insert check valves and strainers.
- 10 Y Pattern strainers and full-bore isolation valves must be installed in conjunction with the A5900/1 AA fail-safe thermostatic mixing valves as close as is practically possible to the location of the valve.
- 11 It is essential that the A5900/1 AA thermostatic mixing valves should not be installed in situations where there is a possibility of the valve being deprived of water or where demands for water are greater than the actual stored supplies.
- 12 To ensure that the performance levels of the A5900/1 AA thermostatic mixing valves are maintained (in the event of cold water failure), the temperature of the hot water supply at the point of entry to the valves must be a minimum of 10°C above the commissioned mixed water discharge temperature.
- 13 The A5900/1 AA thermostatic mixing valves must not be subject to any extreme temperature variations either during the installation or under normal operating conditions.

Method of Adjusting the Mixed Water Outlet Temperature

IMPORTANT: - The following instructions must be read and understood prior to the adjustment of the mixed water outlet temperature and this action **MUST** only be carried out by a suitably qualified person.

The numerical indicator on the cap is indicative of the mixed water temperature, but when commissioning it is the temperature of the water for the outlet(s) that is important.

- 1 Remove the cap from the valve.
- 2 Remove the temperature locking ring from the spindle using a suitably sized spanner.
- 3 Open the outlet to which the mixing valve is supplying and establish a stable flow and temperature.
- 4 Using a calibrated thermometer place the sensing part of the thermometer probe under the flowing water.
- 5 Using a suitably sized Allen key turn the temperature adjustment spindle anticlockwise to increase the mixed water temperature or clockwise to reduce the mixed water temperature – at all times ensuring the probe of the thermometer is under the flowing water.
- 6 Once the desired temperature is reached replace the temperature locking ring on the spindle and re fit the cap of the valve.
- 7 The temperature at the terminal fitting must never exceed 46°C.

Commissioning

IMPORTANT: - The following instructions must be read and understood prior to the commissioning of the A5900/1 AA fail-safe thermostatic mixing valves. If under any circumstances there are aspects to the installation / system which do not comply with the specification laid down, the valve **MUST NOT** be put into operation until the system / installation complies with our specification.

1 Before commissioning the thermostatic valve check the following;

- The supply pressures are within the valve's operating range.
- The supply temperatures are within the valve's operating range.
- The temperature differential is appropriate for the supply conditions.
- Isolation valves are fitted, accessible and open.
- Strainers are fitted and clean.
- Appropriate backflow prevention devices are fitted.
- The system has been thoroughly cleaned and free from debris.

Providing that all of these conditions are met, please follow the following steps to commission this product.

- 2 Commissioning the temperatures must be carried out using a suitably calibrated thermometer, preferably a digital thermometer, the sensing part of the thermometer probe must be fully submerged in the water when testing.
- 3 Each valve must be commissioned taking into consideration any fluctuations, which may occur within the system due to simultaneous demands. It is advisable that any outlets which are connected to the same supply as the mixing valve is connected to, open during the setting of the mixed water temperature. During commissioning it is advisable to ensure that the water temperatures are established before any attempt to commission.
- 4 Once the supply temperatures are stable and the normal operating conditions are established, the valve can be commissioned, the temperature setting can be adjusted by removing the cap and temperature locking ring from the valve body (see section method of adjusting mixed water temperature). We suggest that the following sequence is followed when commissioning the valve;
 - 4.1 Set the mixed water temperature to the required temperature, the temperature at the terminal fitting must never exceed 46°C.
 - 4.2 Measure and record the temperature of the hot and cold water supplies at the connection to the valve.
 - 4.3 Measure and record the temperature of the water discharging from the valve.
 - 4.4 Isolate the cold water supply to the valve and monitor the mixed water temperature.
 - 4.5 Measure and record the maximum mixed water temperature and the final temperature. The final temperature found during the test should not exceed the values quoted.
 - 4.6 Record all the equipment used during the commissioning.
 - 4.7 The mixed water temperature at the terminal fitting must never exceed 2°C above set temperature.
 - 4.8 The maximum mixed water supply temperature at the terminal fitting should not exceed 46°C.
- 5 When satisfied that the mixed water outlet temperature is correct, check that it is consistently repeatable by turning the mixing valve on and off a number of times and rechecking the mixed water temperature. If the mixed water outlet is stable carry out the cold water isolation test.
- 6 Once the desired temperature is established remove the cap and secure the temperature spindle with the locking ring and replace the cap into its original position to prevent tampering by unauthorized persons. Ensure that the application, in which the valve will be used, is appropriate for the approved designation.
- 7 The above information must be recorded and updated on every occasion when any work is carried out on the valve.

Cold Water Isolation Test

The purpose of the cold water isolation test is to ensure that the thermal performance of the TMV is adequate at the time of installation and annually thereafter.

Procedure:

- 1 Operate the TMV and achieve a normal flowrate for the application and record the initial mixed water outlet temperature.
- 2 Isolate the cold water supply to the valve.
- 3 Collect the water discharged from the TMV outlet for 5 seconds.
- 4 Continue to collect the water discharged from the TMV outlet in a second vessel for a further period of 30 seconds.

Cold Water Isolation Test Continued

5 Re-open (restore) the cold water supply and after 30 seconds measure the mixed water temperature.

If there is residual flow during commissioning or the annual verification (cold water supply isolation test), then this is acceptable providing the temperature of the water seeping from the valve is no more than 2°C above the designated maximum mixed water outlet temperature setting of the valve.

Acceptance Criteria For Tub/Bath:

The volume collected in the first period of 5s shall not exceed 400 ml.

The volume collected in the second period of 30s shall not exceed an additional 500 ml.

After restoration of the cold water supply (30s) the mixed water outlet temperature shall not differ by more than 2°C from the initial set mixed water temperature.

Acceptance Criteria For All Other Outlets:

The volume collected in the first period of 5s shall not exceed 200ml.

The volume collected in the second period of 30s shall not exceed an additional 300 ml.

After restoration of the cold water supply (30s) the mixed water outlet temperature shall not differ by more than 2°C from the initial set mixed water temperature.

In Service Testing

The A5900/1 AA thermostatic mixing valves should be tested against the original set temperature results once a year. It is a requirement that all Type 2 approved valves shall be verified against the original set temperature results once a year.

Whilst this is a recommendation in user/owner domestic dwellings, a duty of care obligation should be considered in commercial bathrooms or subletting situations. When in-service testing is undertaken the following performance checks shall be carried out.

When commissioning/testing is due the following performance checks shall be carried out. When measuring any mixed water outlet temperature reading the sensing part of the thermometer probe must be fully submerged in the water

When testing is due the following performance checks shall be carried out;

- 1 Measure the mixed water temperature at the outlet.
- 2 Carry out the cold water supply isolation test by isolating the cold water supply to the TMV, wait for five seconds if water is still flowing check that the temperature is below 46°C.
- 3 If there is no significant change to the set outlet temperature ($\pm 2^\circ\text{C}$ or less change from the original settings) and the fail-safe shut off is functioning, then the valve is working correctly and no further service work is required.
- 4 If there is a residual flow during the commissioning or the annual verification (cold water supply isolation test), then this is acceptable providing the temperature of the water seeping from the valve is no more than 2°C above the designated maximum mixed water outlet temperature setting of the valve. Temperature readings should be taken at the normal flow rate after allowing for the system to stabilise
- 5 If the A5900/1 AA thermostatic mixing valves has been adjusted or serviced it must be re-commissioned and re-tested in accordance with these instructions.

Dimensions

For dimensions see page 11.

Flowrates

For Kv values and flowrate - pressure loss chart see page 11

Spares

For component identification see page 12

Problem Solving

For resolving on site problems see page 13.

A5900/1 type 3

Introduction

The Ideal A5900/1 AA thermostatic mixing valves have been specifically designed and manufactured to meet the requirements of BS 7942: 2000 and NHS/DoH HTM 04-01 Supplement D08. The valve has been independently tested and approved by Kiwa Watertec as a TYPE 3 valve under the Kiwa Watertec TMV Type 3 scheme.

Technical Specification / Conditions for use TMV Type 3 Valves

Outlet Temperature Adjustment Range	30°C to 50°C
Temperature Stability	±2°C
Maximum Hot Inlet Temperature	85°C
Inlet Temperature Range	52°C to 65°C : Hot Supply 5°C to 20°C : Cold Supply
Max. Working Pressure	10 bar : Static
Min. Working Pressure	0.2 bar : Dynamic
DO8 Working Pressure Range	0.2 to 1.0 bar : Low Pressure 1.0 to 5.0 bar : High Pressure
Min Temp Differential (Mix to Hot) for Fail-Safe	10°C
Max. Pressure Inlet Differential	5 : 1
Max. Flow Rate @ 1 bar Differential	Ø15mm 1500 l/hr (25 l/m) Ø22mm 1700 l/hr (28.3 l/m)

NOTE: Valves operating outside these conditions cannot be guaranteed by the Scheme to operate as Type 3 valves.

Approvals

Kiwa Watertec Scheme Approval Number	Details Available on Request
WRAS Scheme Approval Number	Details Available on Request

Fail Safe Function

The A5900/1 AA (15 mm & 22 mm) valves are designed to stop the mixed water flow in the event of either the hot or cold water supply failing when installed in accordance with these instructions. To ensure full closure of the mixed water flow the minimum temperature differential between the hot water inlet to the valve and the mixed water outlet **MUST** be at least 10°C.

Application

The A5900/1 AA (15 mm and 22 mm) thermostatic mixing valves have been independently tested by Kiwa Watertec and certified as meeting the requirements of the NHS D08 specification under the Type 3 Scheme as being suitable for use on the following designations.

Code	Application	Range	Code	Application	Range
HP-W	Basin	High Press	LP-WE	Basin	Low Press
HP-B	Bidet	High Press	LP-BE	Bidet	Low Press
HP-S	Shower	High Press	LP-SE	Shower	Low Press
HP-T44	Bath Assisted*	High Press	* 22mm size only		
HP-T46	Bath Assisted*	High Press			

Dimensions

For dimensions see page 11.

Flowrates

For Kv values and flowrate - pressure loss chart see page 11.

Installation

IMPORTANT - The following instructions must be read prior to the installation of any A5900/1 AA (15 mm & 22 mm) valves. The installer should also be aware of their responsibility and duty of care to ensure that all aspects of the installation comply with all current regulations and legislation.

Flushing through water systems using certain chemicals may wholly or partially remove the lubricant from the internal workings of the valve, which may adversely affect its performance. We recommend that following a flushing of the system with chemicals, valves are checked for correct operation.

- The installation of thermostatic mixing valves must comply with the requirements of the Water Supply (Water Fittings) Regulations 1999 and Scottish Water Byelaws.
 - The Thermostatic mixing valve must be installed in such a location that maintenance of the TMV using its isolating valves and that the commissioning and testing of the TMV can be undertaken.
- 1 It is essential that before installing any Ideal (15 mm & 22 mm) valves ensure that the supply conditions of the system to which the valve is intended to be fitted are checked to confirm compliance with the parameters as quoted within the Technical Specification and conditions on which the approval is granted i.e. verify supply temperatures, supply pressures, risk assessment.

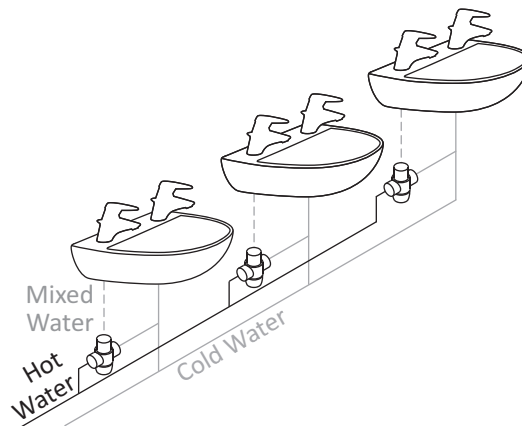

- 2 Consideration must be made for the possibility of multiple/simultaneous demands being made on the supply system whilst the A5900/1 AA valves (15 mm & 22 mm) are in use, all practical precautions must be made to ensure that the valve is not affected. Failure to make provision within the pipe sizing etc. will affect the performance of the valve.
- 3 The supply system to which the A5900/1 AA valves (15 mm & 22 mm) are to be installed into must be thoroughly flushed and cleaned to remove any debris, which may have accumulated during the installation. Failure to remove any debris will affect the performance and the manufacturer's warranty of the product. Independent filters and isolation valves must be fitted in conjunction with the valve, as close as practically possible to the water supply inlets of the thermostatic mixing valve. In areas that are subject to aggressive water, provision must be made to treat the water supply prior to the supply entering any Ideal product.
- 4 The maximum flow rate of the valve will only be achieved when the supply conditions are achieved as quoted within the Technical Specification, with a flow condition under 1 bar differential pressure.
- 5 Ideal A5900/1 AA (15 mm & 22 mm) valves have been designed to ensure that the valve can be installed in any position whether vertical or horizontal, it can be surface mounted or within a supply duct. It is essential that the access to the valve is not obstructed for any future maintenance that may be required to the valve or associated fittings.
- 6 We recommend that A5900/1 AA (15 mm & 22 mm) thermostatic mixing valves are installed as close as practically possible to the outlet, which it is serving. In this situation attention must be paid to the maximum distance of pipe work from the mixed water outlet of the valve to any terminal fitting. NHS/DoH HTM 04-01 Part A guidelines recommend a maximum distance of 2 metres from the outlet of the mixing valve to the terminal fitting, which the mixing valve is to serve.
- 7 The hot and cold water supplies must be connected to the valve strictly in accordance with the indications on the body of the valve i.e. hot water supply to the hot port of the valve.
- 8 In a situation where one or both of the water supplies are excessive, it is possible to fit a pressure reducing valve to reduce the pressure(s) to within the limits as quoted previously.

Installation

- 9 Any thermostatic mixing valve must be fitted with a back flow prevention device, such as check valves to prevent the cross contamination of supplies. The A5900/1 AA (15 mm & 22 mm) valves are complete with integral insert check valves and strainers. However if required, additional WRAS approved backflow prevention devices should be positioned as close as practically possible to the water supply inlets of the thermostatic mixing valve. A complete range of backflow prevention devices are available to complement this product.
- 10 Y Pattern strainers and full-bore isolation valves must be installed in conjunction with the A5900/1 AA (15 mm & 22 mm) fail-safe thermostatic mixing valves as close as is practically possible to the location of the valve.
- 11 It is essential that the A5900/1 AA (15 mm & 22 mm) thermostatic mixing valves should not be installed in situations where there is a possibility of the valve being deprived of water or where demands for water are greater than the actual stored supplies.
- 12 To ensure that the performance levels of the A5900/1 AA (15 mm & 22 mm) thermostatic mixing valves are maintained (in the event of cold water failure), the temperature of the hot water supply at the point of entry to the valves must be a minimum of 10°C above the commissioned mixed water discharge temperature.
- 13 The A5900/1 AA (15 mm & 22 mm) thermostatic mixing valves must not be subject to any extreme temperature variations either during the installation or under normal operating conditions.

Method of Adjusting the Mixed Water Outlet Temperature

IMPORTANT - The following instructions must be read and understood prior to the adjustment of the mixed water outlet temperature and this action **MUST** only be carried out by a suitably qualified person.

- 1 Remove the cap from the valve
- 2 Remove the temperature locking ring from the spindle using a suitably sized spanner
- 3 Open the outlet to which the mixing valve is supplying and establish a stable flow and temperature
- 4 Using a calibrated thermometer place the sensing part of the thermometer probe under the flowing water
- 5 Using a suitably sized Allen key turn the temperature adjustment spindle anticlockwise to increase the mixed water temperature or clockwise to reduce the mixed water temperature – at all times ensuring the probe of the thermometer is under the flowing water.
- 6 Once the desired temperature is reached – replace the temperature locking ring on the spindle and re fit the cap of the valve.
- 7 The temperature at the terminal fitting must never exceed 46°C.

Commissioning

IMPORTANT - The following instructions must be read and understood prior to the commissioning of the A5900/1 AA (15 mm & 22 mm) fail-safe thermostatic mixing valves. If under any circumstances there are aspects to the installation / system which do not comply with the specification laid down, the valve **MUST NOT** be put into operation until the system / installation complies with our specification. However if all these conditions are met, proceed to set the temperature as follows;

- 1 Ensure that the system is thoroughly cleaned and free from any debris prior to the commissioning the Ideal fail-safe thermostatic mixing valves.
- 2 Commissioning the temperatures must be carried out using a suitably calibrated thermometer - preferably a digital thermometer.
- 3 In the absence of other temperatures being specified, we recommend the outlet temperatures quoted in Table 1.
- 4 Each valve must be commissioned taking into consideration any fluctuations, which may occur within the system due to simultaneous demands. It is advisable that any outlets which are connected to the same supply as the mixing valve are opened during the setting of the mixed water temperature. During commissioning it is advisable to ensure that the water temperatures are established before any attempt to commission.

Commissioning Continued

Table 1

Application	Recommended Set Mixed Water Temp.
Wash Hand Basin	41°C
Shower	41°C
Bidet	38°C
Bath Fill	44°C

Note 1: The maximum mixed water outlet temperature i.e. 41°C max, 44°C etc. being delivered during normal use can deviate by 2°C above the recommended set outlet temperature detailed in the table.

Note 2: For washbasins, washing under running water is assumed.

Note 3: Bath fill temperatures of more than 44°C should only be available when the bather is always under the supervision of a competent person (e.g. nurse or care assistant).

Note 4: The A5900/1 AA thermostatic mixing valve is capable of satisfying all the individual applications and should be re-set on-site to meet the designated application.

5 Once the supply temperatures are stable and the normal operating conditions are established, the valve can be commissioned. The temperature setting can be adjusted by removing the cap and locking ring from the valve body and adjusting the temperature adjustment spindle. We suggest that the following sequence is followed when commissioning the valve:

5.1 Set the mixed water temperature to the required temperature.

5.2 Measure and record the temperature of the hot and cold water supplies at the connection to the valve.

5.3 Measure and record the temperature of the water discharging from the valve from the largest and smallest draw off point.

5.4 Isolate the cold water supply to the valve and monitor the mixed water temperature.

5.5 Measure and record the maximum mixed water temperature and the final temperature.

The final temperature found during the test should not exceed the values quoted in Table 2.

5.6 Record all the equipment used during the commissioning.

Table 2

Application	Maximum Set Mixed Water Temp.
Wash Hand Basin	43°C
Shower	43°C
Bidet	40°C
Bath Fill	46°C

Note: Bath fill temperatures of more than 44°C should only be available when the bather is always under the supervision of a competent person (e.g. nurse or care assistant).

6 Once the desired temperature is established remove the cap and secure the temperature spindle with the locking ring and replace the cap into its original position to prevent tampering by unauthorized persons.

7 Ensure that the application, in which the valve will be used, is appropriate for the approved designation. The above information must be recorded and updated on every occasion when any work is carried out on the valve.

In-service Test Procedure

- 1 Carry out the following In-service test sequence
 - a) For all outlets measure and record the temperature of the mixed water at the maximum available flow. If required, the mixed water temperature may be readjusted up to a maximum temperature as indicated in table 2.
Note: - After risk assessment a temperature that is lower than the maximum temperature allowable for the designated installation (vulnerable people) can also be set if deemed appropriate to do so.
 - b) Isolate the cold-water supply to the mixing valve and observe the mixed water outlet.
- 2 If there is a flow stream after 5 s then collect any water discharging into a suitably graduated measuring vessel for 60 seconds if the volume of water collected is greater than 120ml then re-commissioning or service work is needed.
- 3 If there is no flow or if the volume of water collected is less than or equal to 120ml, then restore the cold-water supply, after 15 seconds record the mixed water temperature.
- 4 Verify that this temperature does not differ from the temperature taken in a) above by 2°C (this is a restoration test after a failure of the cold-water supply and some deviation of the mixed water outlet temperature may be expected).
- 5 If the mixed water temperature differs by more than 2°C from the set temperature taken at a) above, then recheck the supply conditions or re-commission (see 6 below).
- 6 The valve must then be re-adjusted and re-commissioned in accordance with these instructions.

Maintenance

To ensure that the A5900/1 AA (15 mm & 22 mm) valves maintain a high level of protection, we advise the following in service testing is conducted (the same equipment used to commission the valve initially must be used in the following tasks).

- 1 After a period of between 6 and 8 weeks from commissioning carry out the following;
 - 1.1 Record the temperature of the hot and cold water supplies.
 - 1.2 Record the temperature of the mixed water at the largest draw off flow rate.
 - 1.3 Record the temperature of the mixed water at the smallest draw off flow rate.
- 2 If the mixed water temperature has changed significantly from the previous test results (e.g. >1°C), record the change and before resetting the mixed water temperature check that:
 - 2.1 All the strainers are clean (see Installation 3).
 - 2.2 All the check valves are in good working order (see Installation 9).
 - 2.3 The isolation valves are fully open.
- 3 If the mixed water temperatures are acceptable, carry out the following:
 - 3.1 Record the temperature of the hot and cold water supplies.
 - 3.2 Record the temperature of the mixed water at the largest draw off flow rate.
 - 3.3 Record the temperature of the mixed water at the smallest draw off flow rate.
 - 3.4 Isolate the cold water supply to the mixing valve and monitor the mixed water temperature.
 - 3.5 Record the maximum temperature achieved as a result of (3.4) and the final temperature (the final temperature should not exceed the values quoted in table 2).
 - 3.6 Record the equipment used during these tests.
- 4 If the mixed water temperature is greater than the values quoted in table 2 or the maximum the corresponding values from previous test results by more than 2°C, the valve must be serviced.
- 5 After a period of between 12 to 15 weeks from commissioning, carry out the sequence of tests as described in Maintenance sections 1, 2, 3 and 4.

Maintenance

- 6 Dependant upon the results obtained from the first two series of tests; there are a number of possible outcomes:
 - 6.1 If no significant change in the mixed water temperatures (e.g. $\leq 1^{\circ}\text{C}$) is recorded between commissioning and Maintenance sections 1 or between commissioning and Maintenance sections 5, the next in service testing should be carried out at a period of 24 to 28 weeks after initial commissioning.
 - 6.2 If a small change (e.g. 1 to 2°C) in the mixed water temperature is recorded in only one of these periods, necessitating adjustment of the mixed water temperature, then the next in service can be deferred to 24 to 28 weeks after commissioning.
 - 6.3 If small changes (e.g. 1 to 2°C) in the mixed water temperature are recorded in both of these periods, necessitating adjustment of the mixed water temperature, then the next in service test can be deferred to 18 to 21 weeks after commissioning.
 - 6.4 If significant changes (e.g. $> 2^{\circ}\text{C}$) in the mixed water temperature are recorded in both of these periods necessitating service work, then the next in service test should be carried out at 18 to 21 weeks after commissioning.
- 7 The general principle to be observed after the first 2 or 3 in-service tests is that the intervals for future tests should be set to those which previous tests have shown can be achieved with no more than a small change in mixed water temperature.
- 8 In all areas periodic maintenance of the valve and associated fittings i.e. strainers, check valves will ensure optimum performance levels are maintained.

Spares

For component identification see page 13.

Problem Solving

For resolving on site problems see page 14.

A5900/1 type 2/3

Flowrates

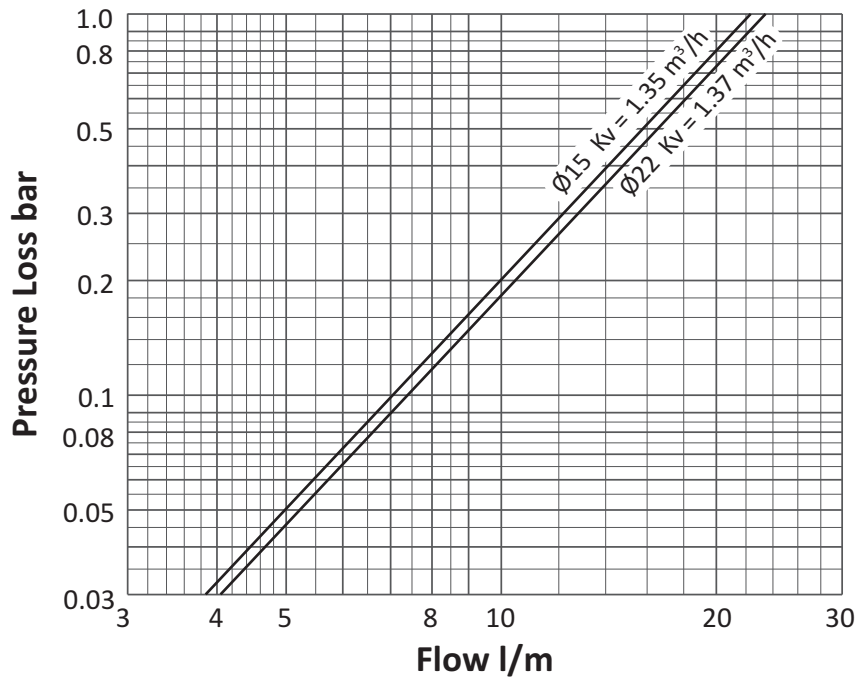

Dimensions

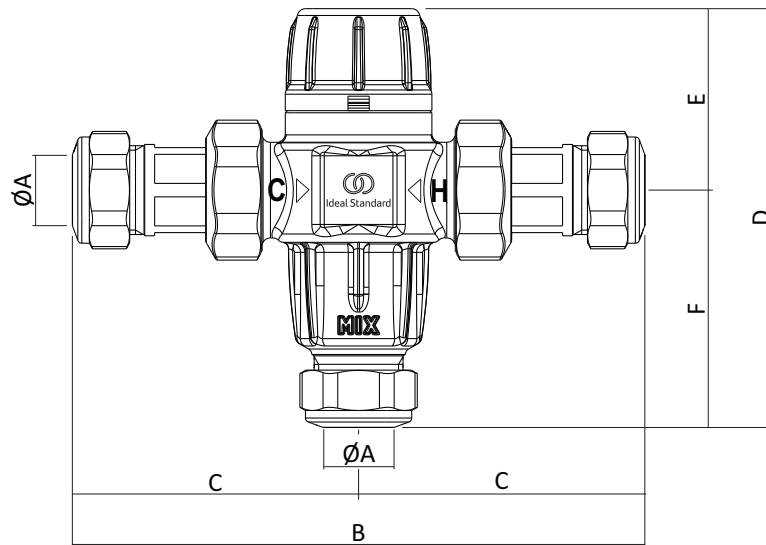

A mm	B mm	C mm	D mm	E mm	F mm	Wt. kg
15	134.7	67.35	98.6	42.7	55.9	0.5
22	150.3	75.15	100.7	42.7	58	0.6

Spares

The following two maintenance/repair kits are available from Ideal Standard as detailed below:

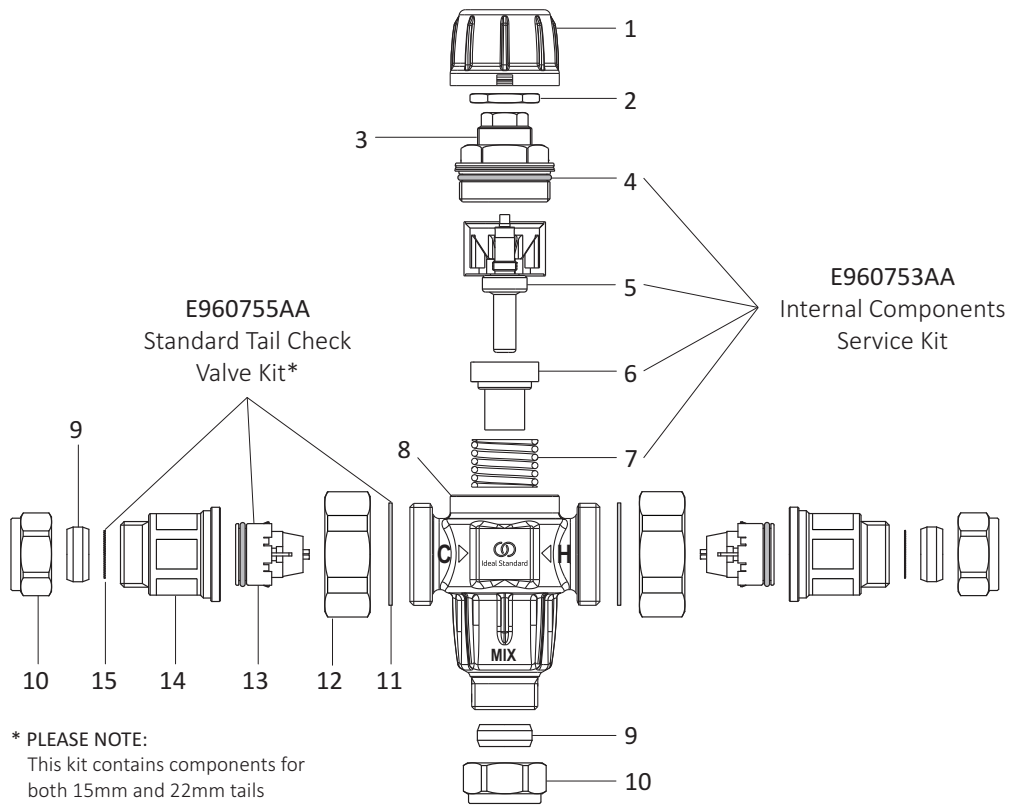

* PLEASE NOTE:
This kit contains components for
both 15mm and 22mm tails

Item	Description	Quantity per Service Kit		
		E960755AA Standard Tail Check Valve Kit*		E960753AA Internal Component Kit
	Service Kit Code	A5900AA 15mm	A5901AA 22mm	A590AA & A5901AA
1	Cap			
2	Temperature Locking Ring			
3	Valve Head Assembly			
4	Head Assembly 'O' Ring			1 off
5	Thermostatic Element & Shuttle			1 off
6	Flow Conveyor			1 off
7	Spring			1 off
8	Valve Body			
9	Olive			
10	Compression Nut			
11	Gasket	2 off	2 off	
12	Union Nut			
13	Check Valve Cartridge	2 off	2 off	
14	Inlet Tail Housing			
15	Inlet Tail Filter	2 off	2 off	
16	Instruction Leaflet (Not Shown)	1 off		1 off

Problem Solving

The following details are supplied for on site queries, should you require any further assistance contact our Technical Department.

1 Hot water at the cold tap

- Operation of the insert check valves is hindered, check the valve is seated correctly.
- Check Valves not fitted.
- Unbalanced hot/cold supply pressure.

2 Fluctuating mixed water temperature

- Erratic supply temperatures at the inlets of the valve.
- Starvation of the water supplied at the inlets of the valve.
- Incorrect commissioning of the valve.

3 Erratic flow

- Insufficient water supplies.
- Fluctuations in the supply pressures/temperatures.
- Adverse effect created by other draw off points on the system.

4 No flow/reduced flow from valve

- In line filters are blocked.
- Insufficient supply pressure.
- Debris obstructing valve operation.
- Valve requires servicing (Servicing kits available on request).

5 Valve does not fail safe when tested

- Installation not in accordance with our recommendations.
- The minimum temperature differential not achieved.
- Internal mechanism hindered by debris.

Full and detailed instructions are supplied with service kits and are available on request.

Please leave these instructions for the user

**For more information about our products &
spares visit our website: www.idealstandard.co.uk**

Ideal Standard pursues a policy of continuing improvement in design and performance of its products. The right is therefore reserved to vary specification without notice.

Ideal Standard International BVBA
Corporate Village - Gent Building
Da Vincilan 2
1935 Zaventem
Belgium

E966003

Ideal Standard,
The Bathroom Works, National Avenue
Kingston-upon-Hull, HU5 4HS, England

CUSTOMER CARE HELP LINE

Tel: 0870 129 6085

Fax: 01482 495 611

E-MAIL

Ukcustcare@idealstandard.com

IOM174 29-02-24



Ideal Standard