

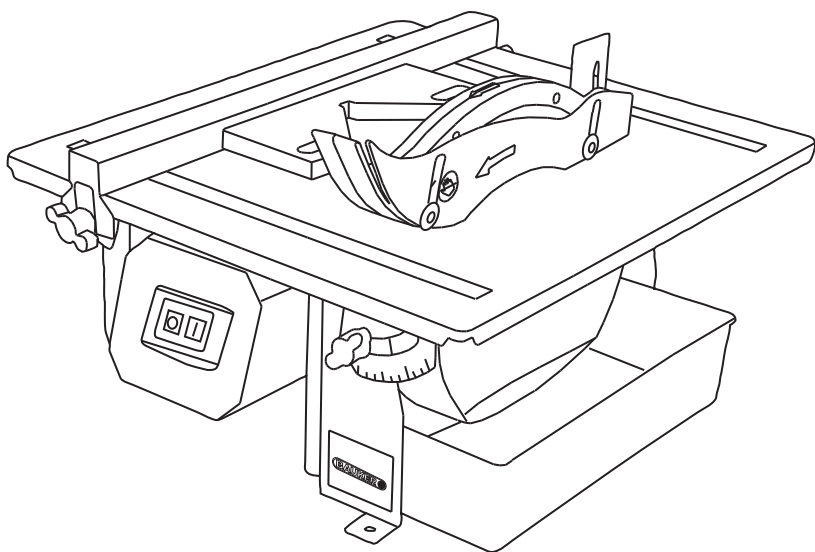

BAUKER

BTC180B



600W TILE CUTTER ORIGINAL INSTRUCTION MANUAL

SAFETY INFORMATION

 **WARNING!** When using electric tools basic safety precautions should always be followed to reduce the risk of fire, electric shock and personal injury including the following. Read all these instructions before attempting to operate this product and save these instructions".

Maintenance and Servicing

Remove the plug before carrying out any adjustment, servicing or maintenance.

Safe operation

1. Keep work area clear
 - Cluttered areas and benches invite injuries.
2. Consider work area environment
 - Do not expose tools to rain.
 - Do not use tools in damp or wet locations.
 - Keep work area well lit.
 - Do not use tools in the presence of flammable liquids or gases.
3. Guard against electric shock
 - Avoid body contact with earthed or grounded surfaces {e.g. pipes, radiators, ranges, refrigerators}.
4. Keep other persons away
 - Do not let persons, especially children, not involved in the work touch the tool or the extension cord and keep them away from the work area.
5. Store idle tools
 - When not in use, tools should be stored in a dry locked-up place, out of reach of children.
6. Do not force the tool
 - It will do the job better and safer at the rate for which it was intended.
7. Use the right tool
 - Do not force small tools to do the job of a heavy duty tool.
 - Do not use tools for purposes not intended; for example do not use circular saws to cut tree limbs or logs.
8. Dress properly
 - Do not wear loose clothing or jewellery, they can be caught in moving parts.

- Non-skid footwear is recommended when working outdoors.
- Wear protective hair covering to contain long hair.
- 9. Use protective equipment
 - Use safety glasses.
 - Use face or dust mask if working operations create dust.
- 10. Connect dust extraction equipment
 - If the tool is provided for the connection of dust extraction and collecting equipment, ensure these are connected and properly used.
- 11. Do not abuse the cord
 - Never yank the cord to disconnect it from the socket Keep the cord away from heat, oil and sharp edges.
- 12. Secure work
 - Where possible use clamps or a vice to hold the work. It is safer than using your hand.
- 13. Do not overreach
 - Keep proper footing and balance at all times.
- 14. Maintain tools with care
 - Keep cutting tools sharp and clean for better and safer performance.
 - Follow instruction for lubricating and changing accessories.
 - Inspect tool cords periodically and if damaged have them repaired by an authorized service facility.
 - Inspect extension cords periodically and replace if damaged.
 - Keep handles dry, clean and free from oil and grease.
- 15. Disconnect tools
 - When not in use, before servicing and when changing accessories such as blades, bits and cutters, disconnect tools from the power supply.
- 16. Remove adjusting keys and wrenches
 - Form the habit of checking to see that keys and adjusting wrenches are removed from the tool before turning it on.
- 17. Avoid unintentional starting
 - Ensure switch is in "off" position when plugging in
- 18. Use outdoor extension leads
 - When the tool is used outdoors, use only extension cords intended for outdoor use and so marked.
- 19. Stay alert
 - Watch what you are doing, use common sense and do not

operate the tool when you are tired.

20. Check damaged parts

- Before further use of tool, it should be carefully checked to determine that it will operate properly and perform its intended function.
- Check for alignment of moving parts, binding of moving parts, breakage of parts, mounting and any other conditions that may affect its operation.
- A guard or other part that is damaged should be properly repaired or replaced by an authorized service centre unless otherwise indicated in this instruction manual.
- Have defective switches replaced by an authorized service centre.
- Do not use the tool if the switch does not turn it on and off.

21. Warning

- The use of any accessory or attachment other than one recommended in this instruction manual may present a risk of personal injury.

22. Have your tool repaired by a qualified person

- This electric tool complies with the relevant safety rules. Repairs should only be carried out by qualified persons using original spare parts, otherwise this may result in considerable danger to the user.

23. If the replacement of the supply cord is necessary, this has to be done by the manufacturer or his agent in order to avoid a safety hazard.

24. For tools intended to be connected to a water supply:

- Never use the tool without the PRCD delivered with the tool,
- Replacement of the plug or the supply cord shall always be carried out by the manufacturer of the tool or his service organisation,
- Keep water clear off the electrical parts of the tool and away from persons in the working area.

SYMBOLS



To reduce the risk of injury, user must read instruction manual



Wear eye protection



Wear ear protection



Wear dust mask



Warning



Double insulation



Always wear gloves



Remove plug from mains before maintenance or if cord is damaged.



Waste electrical products must not be disposed of with household waste. Please recycle where facilities exist. Check with your local authorities or retailer for recycling advice.



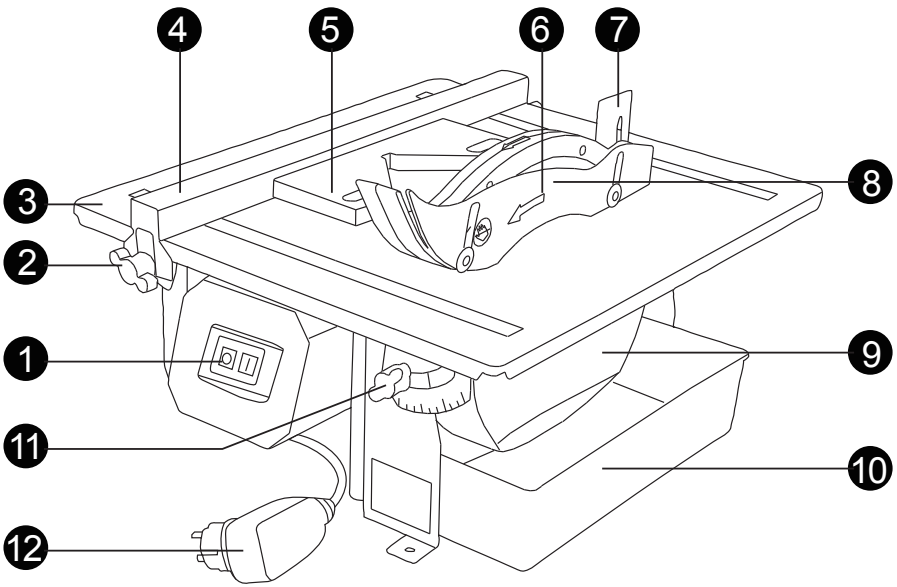

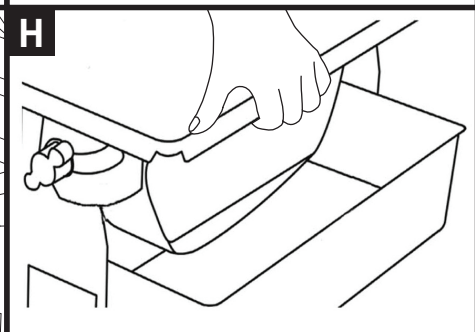
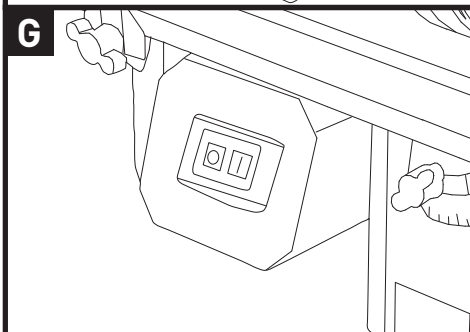
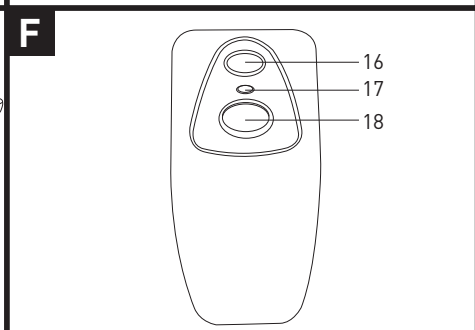
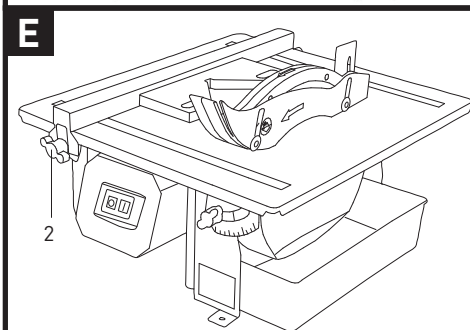
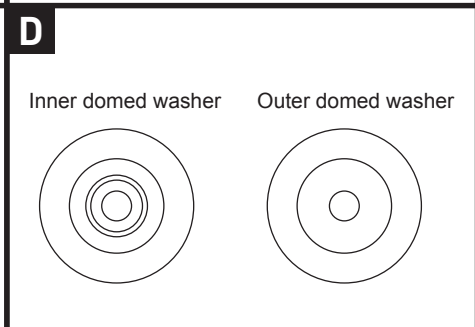
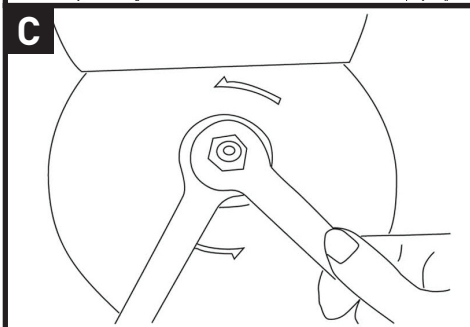
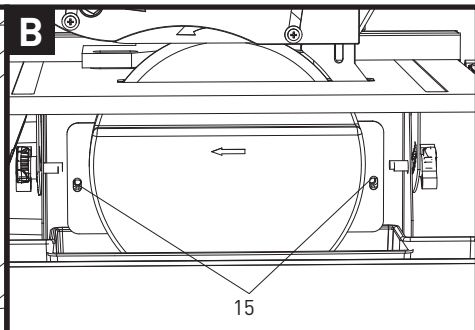
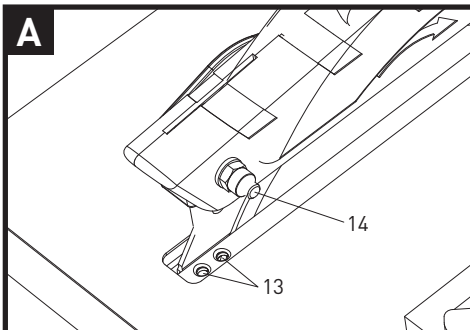

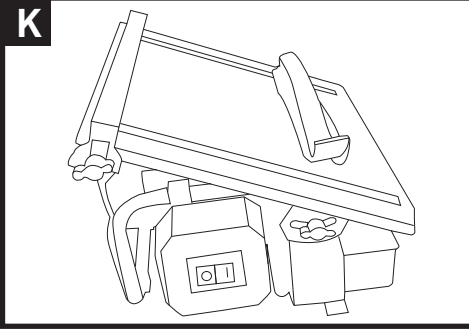
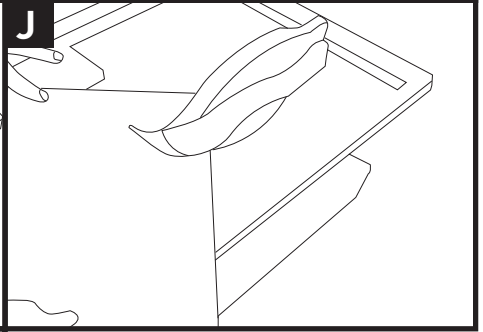
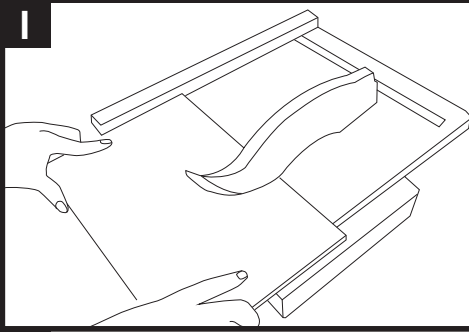

COMPONENT LIST

1. ON/OFF SWITCH
2. PARALLEL GUIDE SECURING KNOB (ONE EACH SIDE)
3. FIXING PLATE(UNDER THE TABLE EDGE)
4. PARALLEL GUIDE
5. MITER GAUGE
6. BLADE GUARD
7. BLADE GUARD BRACKET
8. DIAMOND CUTTING BLADE
9. BLADE GUARD COVER AND SPACING PLATE
10. WATER TRAY
11. TABLE ANGLE SECURING KNOB (ONE EACH SIDE)
12. RCD SWITCH (ONLY FOR BTC180B.1)

Not all the accessories illustrated or described are included in standard delivery.

TECHNICAL DATA

Voltage	230V~ 50Hz
Power input	600W S2:10 Min
No load speed	2,950 /min
Blade size	Φ180 x 2.2 xΦ25.4 mm
Cutting depth 90 degree	34 mm
Table bevel range	0-45°
Table size	330 x 360 mm
Machine weight	8.4 kg
Protection class	□/ I

ACCESSORIES

Parallel guide	1
Water tank	1
45° miter gauge	1
Spanner	2
Blade	1

We recommend that you purchase your accessories from the same store that sold you the tool. Refer to the accessory packaging for further details. Store personnel can assist you and offer advice.

NOISE AND VIBRATION DATA

A weighted sound pressure $L_{pA} = 92\text{dB(A)}$

$K_{pA} = 3.0\text{dB(A)}$

A weighted sound power $L_{wA} = 105\text{dB(A)}$

$K_{wA} = 3.0\text{dB(A)}$

Wear ear protection. 

OPERATING INSTRUCTIONS



NOTE: Before using the tool, read the instruction book carefully.

Caution: Always be sure that the tool is switched off and unplugged before adjusting or checking function on the tool.

1. FITTING AND ADJUSTING THE BLADE GUARD BRACKET/BLADE GUARD

Before use, the blade guard bracket and blade guard must be fitted to the cutter.

Remove machine from packaging, loosen the securing plate slightly by unscrewing the two screws(13).

Note the screws and securing plate is preassembled on the worktable. (See A)

Align blade guard bracket on top of table and tighten the two screws(13).

Unscrew the bolt(14) on blade guard, insert the blade guard bracket into the guard through the slot. Re-fit the bolt on blade guard.

2. FITTING AND CHANGING THE BLADE

1) Loose the screws(15), remove the blade guard cover (See B).

2) Undo the securing nut using two wrenches (See C).

3) Remove the outer domed washer and the blade.

4) Mount the new blade recommended by the manufacture on the arbor and place back the outer domed washer. Turn the blade 360 degrees to make sure it matches with the domed washers properly.

Fully tighten the securing nut.

Note:

- Fit the inner and outer domed washers in proper order. They have the different centre holes. (See D)
 - Ensure that the arbor and domed washer are clean.
 - Match blade direction arrow to blade rotation direction (wording on wheel facing you).
 - Use a protective glove to hold the diamond wheel during tightening.
- 5) Fit the blade guard cover over the blade. Re-tighten the screws (15).

3. FITTING THE PARALLEL GUIDE (SEE E)

Position the parallel guide on worktable as shown. Align the holes in the fixing plates with the holes in the upright ends of the parallel guide fix with the two securing knobs (2) provided.

Note: The fixing plate should be fitted on the inside surface of the work table edges.

OPERATING INSTRUCTIONS

Residual circuit device (RCD) operation (see F) (only for BTC180B.1)

Function

This RCD device will cut off the power immediately when it detects an electricity leakage in your power tool.

How to use

1.Connect the RCD device into a main power supply. Push the “RESET” button and confirm that the pilot lamp lights.

2.Press the “TEST” button on the RCD, the RCD will cut off the power supply. The pilot lamp is off.

3.Press the “RESET” button again, the RCD is ready to use and the pilot lamp turns red. If the pilot lamp does not turn red, wait 6 seconds before pressing again. Repeat until the pilot lamp turns red. If after several attempts, the pilot lamp still fails to turn red, please check the fuse of the plug and replace if necessary (only for UK).

Note: When pressing the “TEST (16)” and “RESET (18)” button, do not hold for more than 1 second.

4.When the pilot lamp (17) is off, the RCD is power off (electricity leakage occurs or the RCD is on test).

 **WARNING:** Please perform an RCD test before using your tool and follow the above instruction. If the RCD repeatedly is power off with an appliance connected or if it fails to power off when tested following the above instructions, please do not use the RCD and you must seek advice from a qualified electrician.

1. ON/OFF OPERATION WITH RCD SWITCH

Connect the plug to the power supply, press the RESET button, the pilot lamp turns red.

The blade can be operated by pressing the "I" on switch.

Before you begin cutting, the blade must achieve the max. speed.

To stop the tool, you must press "O" on the switch.

2. ON/OFF OPERATION WITHOUT RCD SWITCH (See G)

Connect the plug to the power supply. The blade can be operated by pressing the "I" on switch.

Before you begin cutting, the blade must achieve the max. speed.

To stop the tool, you must press "O" on the switch.

3. FITTING THE WATER TRAY (SEE H)

Before the cutter can be used, the water tray must be filled.

To remove the tray, slide it outwards until it comes into contact with the blade housing. Lift the tray side of the machine until the tray can be removed completely. Fill the tray to 3/4 full with water. Do not add chemicals or detergents to the water. Insert the tray in the opposite manner to removal.

4. SECURING THE TILE CUTTER

The tool can be secured to a workbench by using 3 suitable screws (Not provided) through two lugs and the hole in the frame.

5. MAKING A STRAIGHT CUT

Adjust the parallel guide to the desired width from the blade using the scale rules on the table surface for reference. Loosen and adjust the two securing knobs. (See E)

Position the tile firmly against the parallel guide and pass through the blade in a smooth action. Do not force the tile to be cut too quickly. (See I)

6. MAKING A MITER CUT (SEE J)

Follow the same procedure for a straight cut but employ the miter guide in conjunction with the parallel side fence. The miter guide simply runs up against the edge of the parallel side fence.

Ensure that the tile is held firmly into the guide before making the cut.

7. CUTTING WITH THE TABLE AT AN ANGLE (SEE K)

Use this facility if you wish to cut an angle on the tile cutter.

Loosen the two table securing knobs (one at each side of table).

Tilt the table to the desired angle using the scale on the table.

Re-secure the table and make the cut as before.

ENVIRONMENTAL PROTECTION



Waste electrical products should not be disposed of with household waste. Please recycle where facilities exist. Check with your Local Authority or retailer for recycling advice.

PLUG REPLACEMENT (ONLY FOR REWIRABLE PLUG OF UK & IRELAND)

If you need to replace the fitted plug then follow the instructions below.

IMPORTANT

The wires in the mains lead are colored in accordance with the following code:

BLUE – NEUTRAL

BROWN – LIVE

As the colors of the wires in the mains lead of this appliance may not correspond with the coloured markings identifying the terminals in your plug, proceed as follows. The wire which is coloured blue must be connected to the terminal which is marked with N. The wire which is coloured brown must be connected to the terminal which is marked with L.



WARNING:

Never connect live or neutral wires to the earth terminal of the plug. Only fit an approved BS1363/A plug and the correct rated fuse.

NOTE: If a moulded plug is fitted and has to be removed take great care in disposing of the plug and severed cable, it must be destroyed to prevent engaging into a socket.

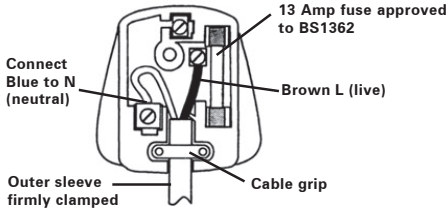

DECLARATION OF CONFORMITY

We,
Positec Power Tools (Europe) Ltd,
PO Box 6242, Newbury, RG14 9LT, UK

Declare that the product
Description **Electric Tile Cutting Machine**
Type Designation **BTC180B (TC-designation of machinery, representative of Tile Cutting Machine)**
Function **Cutting tile or analog materials**

Complies with the following Directives:
2006/42/EC, 2011/65/EU, 2014/30/EU

Standards conform to
EN 61029-1, prEN 61029-2-7, EN 12418, EN 55014-1, EN 55014-2, EN 61000-3-2, EN 61000-3-3

The person authorized to compile the technical file:
Name **Jim Kirkwood**
Address **Positec Power Tools (Europe) Ltd,**
PO Box 6242, Newbury, RG14 9LT, UK



2018/01/08
Allen Ding
Deputy Chief Engineer, Testing & Certification
Positec Technology (China) Co., Ltd
18, Dongwang Road, Suzhou Industrial
Park, Jiangsu 215123, P. R. China

