



INTERIOR  
USE ONLY



FREE  
STANDING



TIMER  
24/7



THERMAL  
PROTECTION



INGRESS  
PROTECTION



## USER OPERATING MANUAL

PRODUCT CODE: **HP2WHSM**

**READ INSTRUCTIONS CAREFULLY:** Read and follow all instructions. Place instructions in a safe place for future reference. Do not allow anyone who has not read these instructions to assemble, light, adjust or operate the heater. This product is only suitable for well insulated spaces or occasional use.



This product is only suitable for well insulated spaces or occasional use.

### **SAFETY INSTRUCTIONS**

Before use make sure to read all of the below instructions in order to avoid injury or damage, and to get the best results from the appliance. Make sure to keep this manual in a safe place. If you give or transfer this appliance to someone else make sure to also include this manual.

In case of damage caused by user failing to follow the instructions in this manual the warranty will be void. The manufacturer/importer accepts no liability for damages caused by failure to follow the manual, a negligent use or use not in accordance with the requirements of this manual.

1. This appliance can be used by children aged from 8 years and above and persons with reduced physical, sensory or mental capabilities or lack of experience and knowledge if they have been given supervision or instruction concerning use of the appliance in a safe way and understand the hazards involved.
2. Children shall not play with the appliance.
3. Cleaning and user maintenance shall not be made by children without supervision.
4. Children of less than 3 years should be kept away unless continuously supervised.
5. Children aged from 3 years and less than 8 years shall only switch on/off the appliance provided that it has been placed or installed in its intended normal operating position and they have been given supervision or instruction concerning use of the appliance in a safe way and understand the hazards involved. Children aged from 3 years and less than 8 years shall not plug in, regulate and clean the appliance or perform user maintenance
  
6. **CAUTION** — Some parts of this product can become very hot and cause burns. Particular attention has to be given where children and vulnerable people are present.
7. If the supply cord is damaged, it must be replaced by the manufacturer, its service agent or similarly qualified persons in order to avoid a hazard.
8. **WARNING:** In order to avoid overheating, do not cover the heater.
9. Do not use this heater in the immediate surrounding of a bath, a shower or a swimming pool.
10. The heating appliance must not be placed just below an electrical outlet.



11. Means “DO NOT COVER “
12. Before inserting the plug into the mains socket, please check that the voltage and frequency comply with the specifications on the rating label.
13. Disconnect the mains plug from the socket when the appliance is not in use and before cleaning.
14. Ensure that the mains cable is not hung over sharp edges and keep it away from hot objects and open flames.
15. Do not immerse the appliance or the mains plug in water or other liquids. There is danger to life due to electric shock!
16. To remove the plug from the plug socket, pull the plug. Do not pull the power cord.
17. Do not touch the appliance if it falls into water. Remove the plug from its socket, turn off the appliance and send it to an authorized service center for repair.
18. Do not plug or unplug the appliance from the electrical outlet with a wet hand.
19. Never attempt to open the housing of the appliance, or to repair the appliance yourself. This could cause electric shock.
20. Never leave the appliance unattended during use.
21. This appliance is not designed for commercial use.
22. Do not use the appliance for other than intended use.
23. Do not wind the cord around the appliance and do not bend it.
24. The heater is not intended for use in bathrooms, laundry areas, near swimming pools or similar wet indoor locations. Never place the heater where it may fall into a bathtub or any other water container.
25. Do not use outdoors.
26. Do not cover or obstruct any of the heat outlet grilles or the air intake openings of the heater.
27. Do not place the heater on carpets with a very deep pile.
28. Do not insert any object through the heat outlet or air intake grilles of the heater.
29. Do not use the heater in areas where flammable liquids are stored or where flammable fumes may be present.
30. Particular care should be taken when the heater is situated in areas occupied by children or disabled persons.
31. Always unplug the heater when moving it from one location to another.
32. This heating device is not suitable for assembling in vehicles and machines.
33. Regarding the information pertaining to the installation, please refer to the below paragraph of the manual.

## PARTS DESCRIPTION

1. Control panel and digital display
2. Main power switch
3. Warm air outlet
4. Feet
5. Wheel
6. Remote control

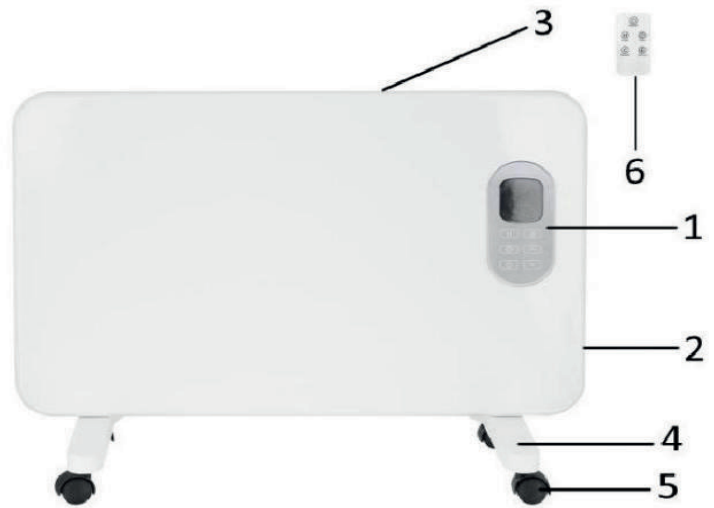

## Control panel and digital display

- A. On/off button
- B. Timer button
- C. Power setting
- D. Temperature setting (-)
- E. Temperature setting (+)
- F. Child lock
- G. Main power icon
- H. Set temperature or timer display
- I. High heat
- J. Low heat
- K. Room temperature display
- L. Child lock icon

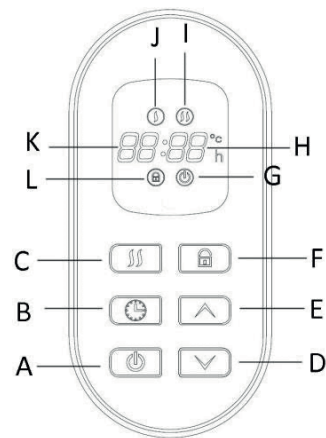



## FEET ASSEMBLY

Take the appliance upside down. Attach the two feet onto the bottom of the appliance and fix with the provided screws. Insert the four small wheels into the two feet.

## OPERATION

Plug the appliance into an appropriate electrical outlet. Turn on the appliance by pressing the main power switch. A beep sound will be heard, and at the meantime the room temperature shows in the display. Press button , the heater is turned on.

### 1. Power setting

Press button  to choose your desired power setting: the display of  is on behalf of low heat; the display of  is on behalf of high heat.

### 2. Temperature setting

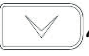
Press button  or  to set the desired temperature. You can choose from 5°C to 40°C. When you set your desired temperature, it will flash a few seconds, and then shows in the display.

### 3. Time setting

Press button “  ” set the desired working time from 0h to 24h. The set working time will flash a few seconds, and then shows the set temperature again. The appliance will shut itself off automatically when the time is up.

### 4. Child lock

Long press the child lock button until a beep sound is heard, the child lock function is activated. Long press the child lock button again until a beep sound is heard, the child lock function is cancelled.

### 5. Turn off

Press button”  “ again to turn off the appliance. Then, turn off the main power switch and unplug the appliance.

### SAFETY SYSTEM

- The appliance has a safety system which automatically switches off the unit when overheated.
- If overheating occurs, switch off the appliance, remove the plug from the socket, and let it cool down for at least 30 minutes. Put the plug in the socket and switch on the heater.

### CLEANING THE HEATER

Always un-plug the heater from the wall socket and allow it to cool down completely before cleaning. Clean the outside of the heater by wiping with a damp cloth and with a dry cloth. Do not use any detergents or abrasives and do not allow any water to penetrate the heater.



### STORING THE HEATER

When the heater is not used for a long time it should be protected from dust and stored in a clean dry place.

### TECHNICAL DATA

Details	HP2WHSM
Voltage	220-240V
Frequency	50-60Hz
Power	1000/2000W

### Connection by WIFI

1. Use your phone to scan the QR code below or search “Tuya Smart” in Application on market to download and install the App.
2. Select your country code, enter the cellphone number and tap “Get” to get a message containing verification on code.
3. Enter the verification on code in the message and tap “Login” to login the App.
4. Switch on the product and make sure the product is in WIFI covered environment. The indicator light will rapidly blinks. If the indicator light do no rapidly blinks, please press “A square QR code with a central orange square containing a white lowercase 't' and a Wi-Fi symbol. The QR code is used for scanning to download the Tuya Smart app.

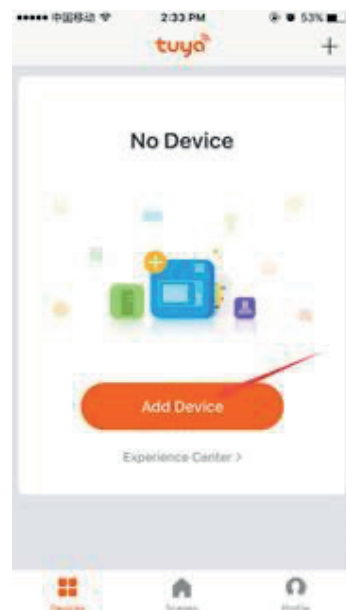

**Pic 1**

- A) Press “+” in the top right corner, as shown in pic 2
- B) Choose “All Devices” as shown in pic 3
- C) Choose “Heater”, as shown in pic 4
- D) Press the “confirm indicator rapidly blinks” when the indicating light on device rapidly blinks, as shown in pic 5
- E) Input password of WIFI and then confirm, as shown in pic 6
- F) Wait for the APP to connect with the device until it is connected successfully. as shown in pic 7

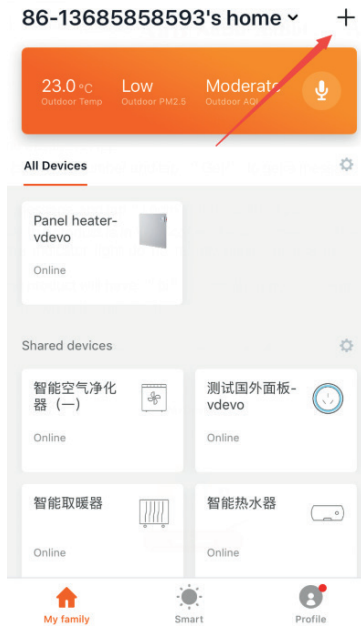

**Pic 2**

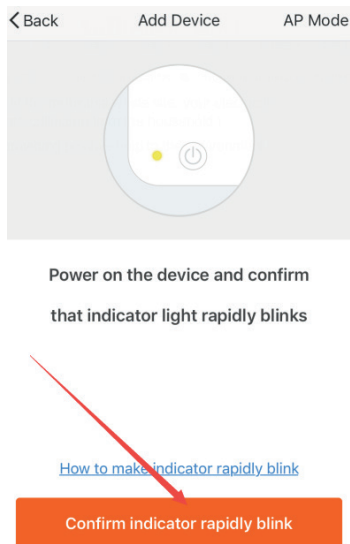

**Pic 4**

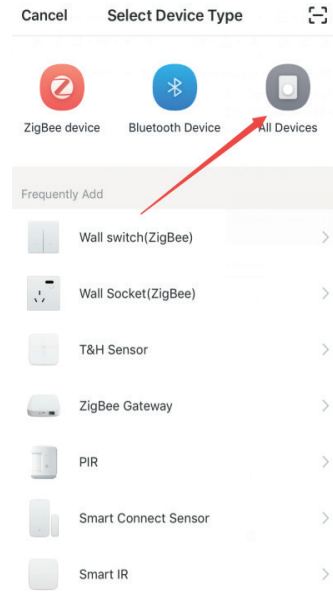

**Pic 3**

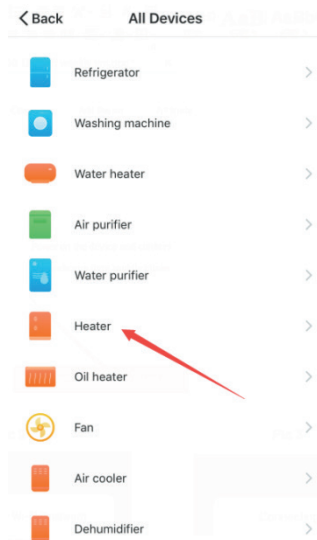

**Pic 5**

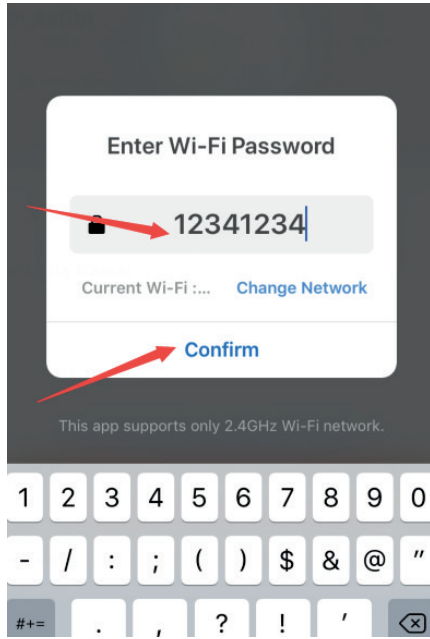

**Pic 6**

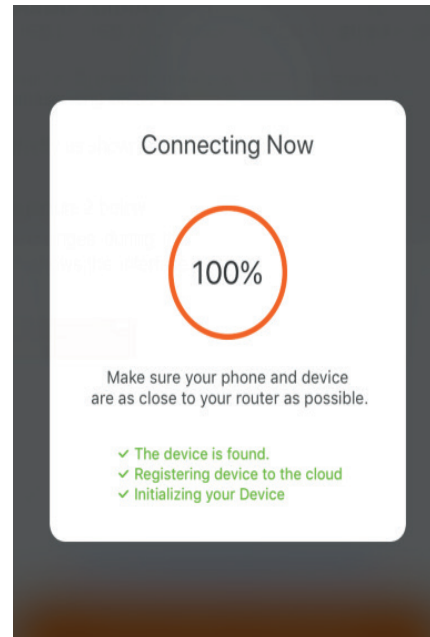

**Pic 7**

### Operation by WIFI

1. You can operate the device by mobile under WIFI or 4G LTE environment, as shown in the picture 8,



**Pic 8**

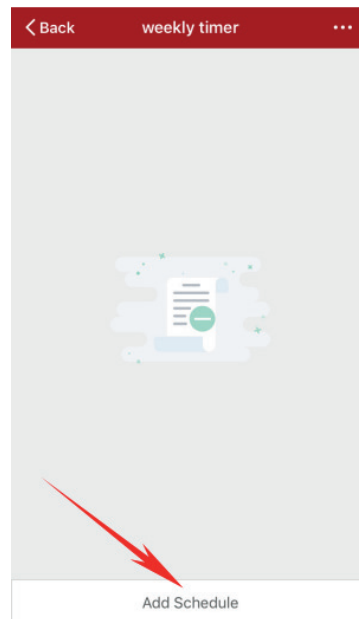

**Pic 9**

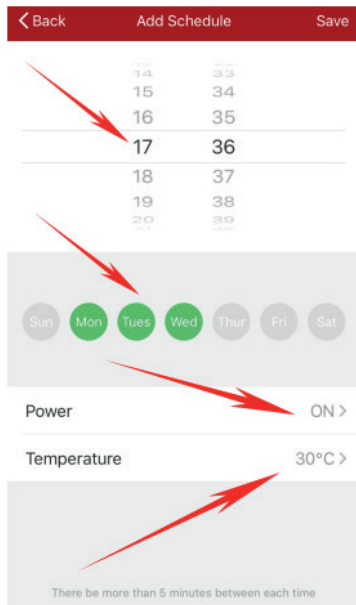

**Pic 10**

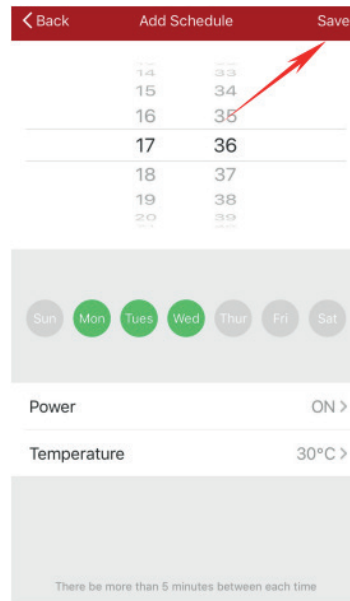

**Pic 11**

2. Select “Weekly timer” button to operation:

- A) Press the “Add schedule”, as shown in pic 9
- B) You can choose the weekly and timer what you want, note you must keep the set temperature higher than current temperate when power ON, as shown in pic 10
- C) Press the “Save” button on top right corner, to save this during “stop or start” weekly timer operation, as shown in pic 11.
- D) Once again operation to set the next during “stop or start” weekly timer.
- E) Press the ”back” button on the top left corner, to check what you recorded
- F) Long time touch the record, you can make choice to cancel.

### **Operating sound**

The appliance emits a beep upon each operation setting.

### **GUARANTEE AND CUSTOMER SERVICE**

Before delivery our devices are subjected to rigorous quality control. If, despite all care, damage has occurred during production or transportation, please return the device to your dealer. In addition to statutory legal rights, the purchaser has an option to claim under the terms of the following guarantee:

For the purchased device we provide 2 years guarantee, commencing from the day of sale. If you have a defective product, you can directly go back to the point of purchase.

Defects which arise due to improper handling of the device and malfunctions due to interventions and repairs by third parties or the fitting of non-original parts are not covered by this guarantee. Always keep your receipt,

without the receipt you can't claim any form of manual, will lead to a void of warranty, if this



results in consequential damages then we will not be liable. Neither can we hold responsible for material damage or personal injury caused by improper use if the instruction manual is not properly executed. Damage to accessories does not mean free replacement of the whole appliance. In such case please contact our service department. Broken glass or breakage of plastic parts is always subject to a charge. Defects to consumables or parts subjected to wearing, as well as cleaning, maintenance, replacement of said parts or shipping and transportation costs to and from any place of repair are not covered by the warranty and are to be paid.

#### **ENVIRONMENT FRIENDLY DISPOSAL**



Recycling –European Directive 2012/19/EU

This marking indicates that this product should not be disposed with other household wastes. To prevent possible harm to the environment or human health from uncontrolled waste disposal, recycle it responsibly to promote the sustainable reuse of material resources. To return your used

device, please use the return and collection systems or contact the retailer where the product was purchased. They can take this product for environmental safe recycling.