

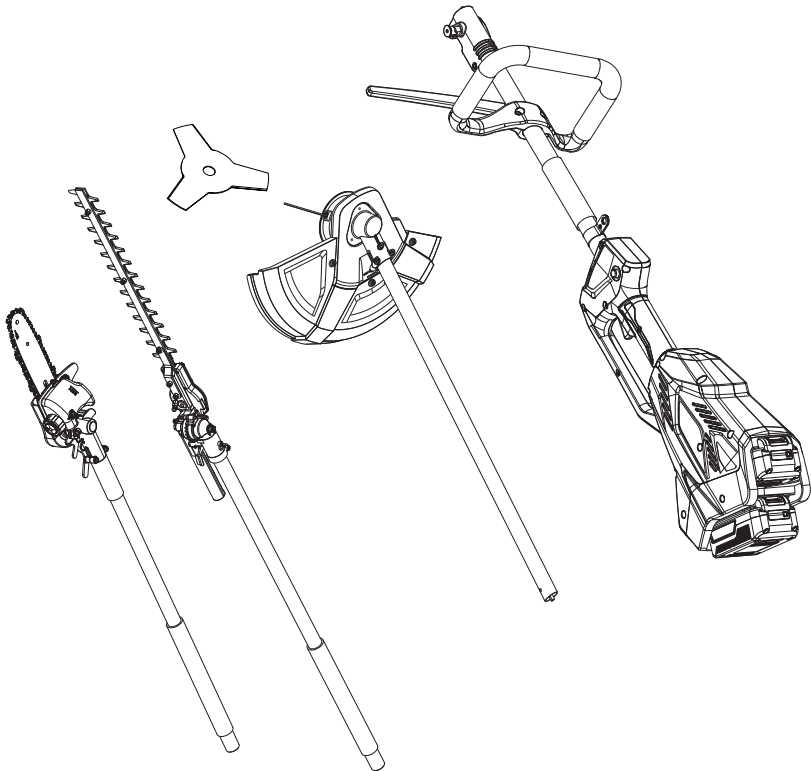

Original User's Instructions

36V (2 x 18V) 4 in 1 Brushless Cordless Multi Tool

SKU: 69946



READ BEFORE USE

PLEASE KEEP THESE INSTRUCTIONS FOR FURTHER REFERENCE

CONTENT

• WHAT'S IN THE BOX -----	3
• SPECIFICATIONS -----	4
• EXPLANATIONS AND SYMBOLS, CAUTIONS AND WARNINGS -----	7
• IMPORTANT SAFETY WARNINGS -----	11
• PRODUCT DESCRIPTION AND IDENTIFICATIONS -----	29
• ASSEMBLY AND OPERATING INSTRUCTIONS -----	32
• CARE AND CLEANING -----	59
• TROUBLE SHOOTING -----	66
• DECLARATION OF CONFORMITY / PERFORMANCE -----	67
• ENVIRONMENTAL INFORMATION -----	68
• GUARANTEE -----	69
• CUSTOMER SUPPORT -----	69

WHAT'S IN THE BOX

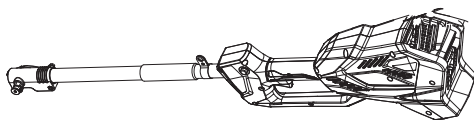

Power head unit



Line spool



Blade



Brush cutter/grass trimmer shaft



Blade protective sheath



Hedge trimmer attachment



Guide bar cover



Pole pruner attachment

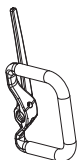

Auxiliary handle



Safety guard

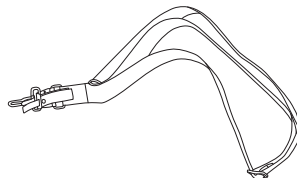

Shoulder strap with quick release

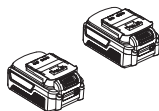

Battery x 2

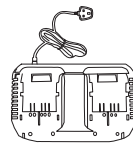

Charger



Hex key 5mm



Hex key 4mm



Socket wrench/
cross screw driver



Socket wrench/
slotted screw driver x 1

If you do not have all these items, please contact:

www.coreservice.co.uk

Hotline: +44 01904 947568

Email support@coreservice.co.uk

SPECIFICATION

Technical Data	
Model	SLEF1000
Nominal voltage of product with battery	36 (2x18)V d.c./4.0Ah Li-Ion
No Load Speed	8500/min
Battery type	Lithium-ion
Battery Model	B0P-SP06-18ZK
Charger Model	B0Q-SP07-2040ZB
Charger rating Input:	220-240V AC, 50/60Hz 120W
Charger rating output:	21V d.c. 4A
Charging time (approx.)	120 mins
Net weight (without cutting attachment and with battery)	approx. 4.4kg
BRUSH CUTTER	
Blade Size	3 teeth, Ø230x Ø25.4mm
No load speed	6500 /min
Noise values	
Sound pressure level $L_{pA,av}$	82.0dB(A)
Uncertainty	3dB(A)
Sound power level $L_{WA,m}$	100.9dB(A)
Uncertainty	2.16dB(A)
Guaranteed sound power level L_{WA}	103 dB(A)
Hand arm vibration	
Front handle a_h	4.470 m/s ²
Rear handle a_h	3.720 m/s ²
Uncertainty	1.5 m/s ²

GRASS TRIMMER	
Line spool diameter	Ø 2.0mm
Max. cutting width	360 mm
No load speed	6000 /min
Noise values	
Sound pressure level $L_{pA,av}$	78dB(A)
Uncertainty	3 dB(A)
Sound power level $L_{WA,m}$	94.5dB(A)
Uncertainty	1.88 dB(A)
Guaranteed sound power level L_{WA}	96 dB(A)
Hand arm vibration	
Left handle a_h	4.320 m/s ²
Right handle a_h	3.690 m/s ²
Uncertainty	1.5 m/s ²
HEDGE TRIMMER	
Max. cutting length	395 mm
Max. cutting capacity	24 mm
No-load speed	1200/min
Adjustable cutting angle range	-90° – +60°
Noise values	
Sound pressure level $L_{pA,av}$	80.3 dB(A)
Uncertainty	3 dB(A)
Sound power level $L_{WA,av}$	97.7 dB(A)
Uncertainty	1.97 dB(A)
Guaranteed sound power level L_{WA}	103 dB(A)
Hand arm vibration	
Front handle a_h	4.470 m/s ²
Rear handle a_h	3.720 m/s ²
Uncertainty	1.5 m/s ²

PRUNER	
Chain oil tank	150 ml
Saw chain speed	13 m/s
Max. cutting length	180 mm
Guide bar length	203 mm
Guide bar type	Oregon 080SDEA041(552912)
Saw chain type	Oregon 91PJ033X
Chain pitch	9.525 mm (3/8")
Chain gauge (thickness of drive links)	1.27 mm (0.050")
Drive sprocket (teeth and pitch)	7 teeth x 9.525 mm(3/8")
Noise values	
Sound pressure level $L_{pA,av}$	84.1 dB(A)
Uncertainty	3 dB(A)
Sound power level $L_{WA,av}$	100.6 dB(A)
Uncertainty	2.38 dB(A)
Guaranteed sound power level L_{WA}	103 dB(A)
Hand arm vibration	
Front handle a_h	4.470 m/s ²
Rear handle a_h	3.720 m/s ²
Uncertainty	1.5 m/s ²

Note: The above specifications are the MAXIMUM capacities of the tool. The maximum branch diameter depends on the hardness of the wood and its branches scale. Voltage measured without workload. Initial battery voltage reaches 20 Volts. Nominal voltage is 18 Volts.

The declared vibration value has been measured in accordance with a standard test method and may be used for comparing one tool with another.

The declared vibration value may also be used in a preliminary assessment of exposure.

WARNING! The vibration emission value during actual use of the tool can differ from the declared value depending on the ways in which the tool is used. Identify safety measures to protect the operator that are based on an estimation of exposure in the actual conditions of use (taking account of all parts of the operating cycle such as the times when the tool is switched off and when it is running idle in addition to the trigger time).

The sound intensity level for the operator may exceed 85dB(A) and ear protection measures are necessary.

www.coreservice.co.uk

Hotline: +44 01904 947568

Email support@coreservice.co.uk

EXPLANATIONS AND SYMBOLS, CAUTIONS AND WARNINGS



Warning



Read the instruction manual



Wear ear protection



Wear eye protection



Wear safety helmet!



Wear face protection!



Gloves with saw protection



Wear safety footwear



Wear protective clothing



To avoid potential electric shock, do not use the unit in humid or wet conditions



Always beware of the danger from overhead electric-power line, keep a safe distance at least 10M from the power line.



Beware of blade thrust: Continued movement of saw blade after cutting through log.



Objects thrown by the product could hit the user or other bystanders. Always ensure that other people and pets remain at a safe distance from the product when it is in operation. In general, children must not come near the area where the product is. Minimum distance 15m.



Maximum rotational frequency of the shaft for the cutting attachment in min^{-1}



Correct direction of cutting-teeth.



Refill chain oil



Do not touch the cutting device until it stops completely.



Guaranteed sound power level Grass trimmer: 96dB

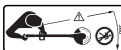

Keep other people out of working area during operation. A distance of at least 15 m must be observed.



Beware of chain saw kickback and avoid contact with bar tip



To reduce the risk of injury, user must read instruction manual carefully.



Do not throw into water.



Do not throw on fire.



Do not subject the battery to strong sunlight over long periods of time. Do not leave on a heater (max.45°C).



Batteries contain Li-ion. Do not dispose of waste batteries in domestic waste. Contact local authority to find out how to dispose of batteries.

Li-Ion



To reduce the risk of injury, user must read instruction manual carefully.



The charger is for indoor use only.



Double insulation.



Protective 5A limited



Wait until all machine components have completely stopped before touching them.



Beware of blade trust. Blade is continually in motion.



WEEE symbol. Waste electrical products should not be disposed of with household waste. Please recycle where facilities exist. Check with your Local Authority or local store for recycling advice.



The product complies with the applicable European directives and an evaluation method of conformity for these directives was done.



UK conformity assessed



Caution! Risk of injury due to running blades!



Protect the appliance from rain and moisture!



Always use the product with two hands. Do not use one hand when operating the product.



Beware of kickback. Tip contact may cause the guide bar to move suddenly upward and backwards what may cause serious injury to user.

IMPORTANT SAFETY WARNINGS

General Power Tool Safety Warnings



Warning: Please read the following instructions carefully, failure to do so could lead to serious personal injury. When using the electric multi tool, basic safety precautions, including the following, should always be followed to reduce the risk of fire, electric shock and personal injury. Read all these instructions before operating this product and save these instructions.

The term “power tool” in the warnings refers to your mains-operated (corded) power tool or battery-operated (cordless) power tool.

Become familiar with the owner’s manual before attempting to operate this machine.

- This machine is not intended for use by persons (including children) with reduced physical, sensory or mental capabilities, or lack of experience and knowledge, unless they have been given supervision or instruction concerning use of the appliance by a person responsible for their safety.
- Children should be supervised to ensure that they do not play with the appliance.
- The machine is only to be used with the power supply unit provided with the machine.

Important! Read carefully before use, keep for further reference.

Work Area Safety

- Keep work area clean and well lit. Cluttered or dark areas invite accidents.
- Do not operate power tools in explosive atmospheres, such as in the presence of flammable liquids, gases or dust. Power tools create sparks which may ignite the dust or fumes.
- Keep children and bystanders away while operating a power tool. Distractions can cause you to lose control.

Electrical Safety

- Power tool plugs must match the outlet. Never modify the plug in any way. Do not use any adapter plugs with earthed (grounded) power tools. Unmodified plugs and matching outlets will reduce risk of electric shock.
- Avoid body contact with earthed or grounded surfaces, such as pipes, radiators, ranges and refrigerators. There is an increased risk of electric shock if your body is earthed or grounded.
- Do not expose power tools to rain or wet conditions. Water entering a power tool will increase the risk of electric shock.
- Do not abuse the cord. Never use the cord for carrying, pulling or unplugging the power tool. Keep cord away from heat, oil, sharp edges or moving parts. Damaged or entangled cords increase the risk of electric shock.
- When operating a power tool outdoors, use an extension cord suitable for outdoor use. Use of a cord suitable for outdoor use reduces the risk of electric shock.
- If operating a power tool in a damp location is unavoidable, use a residual current device (RCD) protected supply. Use of an RCD reduces the risk of electric shock.

Personal Safety

- Stay alert, watch what you are doing and use common sense when operating a power tool. Do not use a power tool while you are tired or under the influence of drugs, alcohol or medication. A moment of inattention while operating power tools may result in serious personal injury.
- Use personal protective equipment. Always wear eye protection. Protective equipment such as dust mask, non-skid safety shoes, hard hat, or hearing protection used for appropriate conditions will reduce personal injuries.
- Prevent unintentional starting. Ensure the switch is in the off-position before connecting to power source and/or battery pack, picking up or carrying the tool. Carrying power tools with your finger on the switch or energizing power tools that have the switch on invites accidents.
- Remove any adjusting key or wrench before turning the power tool on. A wrench or a key left attached to a rotating part of the power tool may result in personal injury.
- Do not overreach. Keep proper footing and balance at all times. This enables better control of the power tool in unexpected situations.
- Dress properly. Do not wear loose clothing or jewelry. Keep your hair and clothing away from moving parts. Loose clothes, jewelry or long hair can be caught in moving parts.
- If the cutting mechanism strikes any foreign object or the product starts making any and allow the product to stop. Switch off the machine and remove battery packs and take the following steps:
 - Inspect for damage.
 - Check and tighten any loose parts.
 - Have any damaged parts replaced or repaired with parts having equivalent specifications.

- If devices are provided for the connection of dust extraction and collection facilities, ensure these are connected and properly used. Use of dust collection can reduce dust-related hazards.
- Do not let familiarity gained from frequent use of tools allow you to become complacent and ignore tool safety principles. A careless action can cause severe injury within a fraction of a second.

Power Tool Use and Care

- Do not force the power tool. Use the correct power tool for your application. The correct power tool will do the job better and safer at the rate for which it was designed.
- Do not use the power tool if the switch does not turn it on and off. Any power tool that cannot be controlled with the switch is dangerous and must be repaired.
- Disconnect the plug from the power source and/or remove the battery pack, if detachable, from the power tool before making any adjustments, changing accessories, or storing power tools. Such preventive safety measures reduce the risk of starting the power tool accidentally.
- Store idle power tools out of the reach of children and do not allow persons unfamiliar with the power tool or these instructions to operate the power tool. Power tools are dangerous in the hands of untrained users.
- Maintain power tools and accessories. Check for misalignment or binding of moving parts, breakage of parts and any other condition that may affect the power tool's operation. If damaged, have the power tool repaired before use. Many accidents are caused by poorly maintained power tools.
- Keep cutting tools sharp and clean. Properly maintained cutting tools with sharp cutting edges are less likely to bind and are easier to control.

- Use the power tool, accessories and tool bits etc. in accordance with these instructions, taking into account the working conditions and the work to be performed. Use of the power tool for operations different from those intended could result in a hazardous situation.
- Keep handles and grasping surfaces dry, clean and free from oil and grease. Slippery handles and grasping surfaces do not allow for safe handling and control of the tool in unexpected situations.

Operation

- This product should not be used for any other purpose than described. Note that national regulations can restrict the use of this product.
- Working with this product is demanding; therefore, ensure you are physically and mentally fit to complete the job safely. Do not use the product when you are tired, ill or under the influence of alcohol or other drugs.
- Pay attention to your posture; always use the provided harness and keep your back straight. Do not overwork yourself. Take regular breaks to ensure concentrated work and full control over the product.
- Keep a firm footing and balance during operation. Always be sure of a safe and secure operating position, whilst using the product. Never use the product standing on steps or a ladder.
- Always wear substantial footwear and long trousers while operating. Do not operate the product when barefoot or wearing open sandals. Wear protective glasses or goggles.
- Thoroughly inspect the area where the product is to be used and remove all objects which can be thrown by the product.
- Before using the product and after any impact, check for signs of wear or damage and repair as necessary.

- Never operate the product with damaged guards or without the guards in place.
- Keep hands and feet away from the cutting means at all times, and especially when switching on the motor.
- Never allow children or people unfamiliar with the instructions to use the product.
- Stop using the product while people, especially children, or pets are nearby.
- Only use the product in daylight or good artificial light.
- Switch off the motor and remove battery packs before:
 - Cleaning or when clearing a blockage.
 - Checking, carrying out maintenance or working on the product.
 - Adjusting the working position of the cutting device.
 - Leaving the product unattended.
- Ensure that the product is correctly located in a designated working position before switch on the motor.
- While operating the product, always ensure that the operating position is safe and secure.
- Do not operate the product with a damaged or excessively worn cutting blades chain or edges.
- Always ensure that all handles and guards are fitted when using the product. Never attempt to use an incomplete product or one fitted with an unauthorized modification.
- Always use two hands to operate a product fitted with two handles.
- Always be aware of your surroundings and stay alert for possible hazards of which you may be aware due to the noise of the product.
- Always ensure that ventilation openings are kept clear of debris.

Maintenance and storage

- Improper maintenance and removal of safety devices leads to hazards causing injuries and damage to property.
- When the product is stopped for servicing, inspection or storage, shut off the power source, remove battery packs and make sure all moving parts have come to a stop. Allow the product to cool before making any inspections, adjustments, etc.
- Always allow the product to cool down before storing.
- When not in use store the product out of the reach of children.
- Use only manufacturers recommended replacement parts and accessories.
- When transporting or storing the product, always fit the transportation guards.
- Correctly secure your product when transporting in a vehicle to prevent turnover, oil spillage and damage to the product.
- For longer periods of storage or transportation the oil tank must be emptied. Dispose of waste oil at a local petrol station, local authority centre or where facilities exist.

Service

- Have your power tool serviced by a qualified repair person using only identical replacement parts. This will ensure that the safety of the power tool is maintained.

Product Safety Warnings

Brush Cutter and Grass Trimmer Safety Warnings:

- Use the tool only with specifically designated battery packs. Use of any other battery packs will increase the risk of injury and fire.
- Only operate the product in daylight or in good artificial light.

- Wear protection, where there is a risk of falling objects.
- Wear eye protection (goggles or face shield).
- Wear ear protection.
- Wear foot protection and gloves (on brush cutters).
- Keep a distance between the product and bystanders of at least 15 m.
- Beware of thrown object.
- Take care against injury from any device fitted for trimming the filament line length. After cutting device line always return the product to its normal operating position before switching on.

Pole Mounted Hedge Trimmer Safety Warnings:

- Use the tool only with specifically designated battery packs. Use of any other battery packs will increase the risk of injury and fire.
- Only operate the product in daylight or in good artificial light.
- Keep all parts of the body away from the cutter blade. Do not remove cut material or hold material to be cut when blades are moving. Make sure the product is switched off and battery packs are removed when clearing jammed material. A moment of inattention while operating the product may result in serious personal injury.
- Carry the product by the handle with the cutter blade stopped. When transporting or storing the product always fit the cutting device cover. Proper handling of the product will reduce possible personal injury from the cutter blades.
- Hold the product by insulated gripping surfaces only, because the cutter blade may contact hidden wiring. Cutter blades contacting a "live" wire may make exposed metal parts of the product "live" and could give the operator an electric shock.

- Check the hedge for foreign objects before operation, e.g. wire fences.
- Hold the product properly, e.g. with both hands if two handles are provided. Loss of control can cause personal injury.
- Beware of overhead power lines. Do not use the product in any position that causes any part to come within 10m of overhead electrical lines.

Pruner Safety Warnings:

- Do not overwork yourself. Take regular breaks to ensure concentrated work and full control over the product. A moment of inattention while operating the product may result in serious personal injury.
- Keep all parts of the body away from the saw chain. Do not remove cut material or hold material to be cut when saw chain is moving. Make sure the product is switched off and battery packs are removed when clearing jammed material. A moment of inattention while operating the product may result in serious personal injury.
- Hold the product by insulated gripping surfaces only, because the saw chain may contact hidden wiring. Saw chains contacting a "live" wire may make exposed metal parts of the product "live" and could give the operator an electric shock.
- Keep all parts of the body away from the saw chain when the product is operating. Before you start the product, make sure the saw chain is not contacting anything. A moment of inattention while operating this product may cause entanglement of your clothing or body with the saw chain.
- Always hold the product with your right hand on the rear handle and your left hand on the front handle. Holding the product with a reversed hand configuration increases the risk of personal injury and should never be done.

- Wear safety glasses and hearing protection. Further protective equipment for head, equate protective clothing will reduce personal injury by flying debris or accidental contact with the saw chain.
- Do not operate the product in a tree. Operation of a product while up in a tree may result in personal injury.
- Always keep proper footing and operate the product only when standing on fixed, secure and level surface. Slippery or unstable surfaces such as ladders may cause a loss of balance or control of the product.
- When cutting a limb that is under tension be alert for spring back. When the tension in the wood fibres is released the spring loaded limb may strike the operator and/or throw the product out of control.
- Use extreme caution when cutting brush and saplings. The slender material may catch the saw chain and be whipped toward you or pull you off balance.
- Carry the product by the front handle with the product switched off and away from your body. When transporting or storing the product always fit the guide bar cover. Proper handling of the product will reduce the likelihood of accidental contact with the moving saw chain.
- Follow instructions for lubricating, chain tensioning and changing accessories. Improperly tensioned or lubricated chain may either break or increase the chance for kickback.
- Keep handles dry, clean, and free from oil and grease. Greasy, oily handles are slippery causing loss of control.
- Cut wood only. Do not use the product for purposes not intended. For example: do not use the product for cutting plastic, masonry or non-wood building materials. Use of the product for operations different than intended could result in a hazardous situation.

- Pay attention to national and local regulations. National and local regulations may restrict the use of this product.
- Remove branches in sections.
- Beware of dangerous operating positions as well as of the risk of being struck by falling branches or by those that rebound after hitting the ground.
- Beware of overhead power lines. Do not use the product in any position that causes any me within 10m of overhead electrical lines.
- Never cut in areas where the cutting attachment is out of sight.

Causes and Operator Prevention of Kickback:

Kickback may occur when the nose or tip of the guide bar touches an object, or when the wood closes in and pinches the saw chain in the cut.

Tip contact in some cases may cause a sudden reverse reaction, kicking the guide bar up and back towards the operator.

Pinching the saw chain along the top of the guide bar may push the guide bar rapidly back towards the operator.

Either of these reactions may cause you to lose control of the saw which could result in serious personal injury. Do not rely exclusively upon the safety devices built into your saw. As a chain saw user, you should take several steps to keep your cutting jobs free from accident or injury.

Kickback is the result of tool misuse and/or incorrect operating procedures or conditions and can be avoided by taking proper precautions as given below:

- Maintain a firm grip, with thumbs and fingers encircling the chain saw handles, with both hands on the saw and position your body and arm to allow you to resist kickback forces. Kickback forces can be controlled by the operator, if proper precautions are taken. Do not let go of the chain saw.

- Do not overreach and do not cut above shoulder height. This helps prevent unintended tip contact and enables better control of the chain saw in unexpected situations.
- Only use replacement bars and chains specified by the manufacturer. Incorrect replacement guide bars and saw chains may cause chain breakage and/or kickback.
- Follow the manufacturer's sharpening and maintenance instructions for the saw chain. Decreasing the depth gauge height can lead to increased kickback.

Vibration and Noise Reduction

To reduce the impact of noise and vibration emission, limit the time of operation, use low-vibration and low- noise operating modes as well as wear personal protective equipment.

Take the following points into account to minimise the vibration and noise exposure risks:

1. Only use the product as intended by its design and these instructions.
2. Ensure that the product is in good condition and well maintained.
3. Use correct application tools for the product and ensure they in good condition.
4. Keep tight grip on the handles/grip surface.
5. Maintain this product in accordance with these instructions and keep it well lubricated (where appropriate).
6. Plan your work schedule to spread any high vibration tool use across a longer period of time.

The European Physical Agents (Vibration) Directive has been brought in to help reduce hand arm vibration syndrome injuries to users of product's with vibration emission. The directive requires manufacturers and suppliers to provide indicative vibration test results to enable users to make informed

decisions as to the period of time a product can be used safely on a daily basis and the choice of tool. Further advice can be found at www.hse.gov.uk

The declared vibration emission value should be used as a minimum level and should be used with the current guidance on vibration.

Calculating the actual period of the actual period off use can be difficult and the HSE website has further information.

The declared vibration emission been measured in accordance with a standard listed test stated above and may be used to compare one tool with another. The declar on emission value may also be used in a preliminary assessment of exposure.



WARNING! The vibration emission value during actual use of the power tool can differ from the declared value depending on the ways in which the dependant on the following examples and other variations on how the tool is used:

- How the tool is used and the materials being ground or cut.
- The tool being in good condition and well maintained.
- The use the correct accessory for the tool and ensuring it is sharp and in good condition. The tightness of the grip on the handles.
- And the tool is being used as intended by its design and these instructions.

This tool may cause hand-arm vibration syndrome if its use is not adequately managed.

Emergency

Familiarise yourself with the use of this product by means of this instruction manual. Memorise the safety directions and follow them to the letter. This will help to prevent risks and hazards.

1. Always be alert when using this product, so that you can recognise and handle risks early. Fast intervention can prevent serious injury and damage to property.
2. Switch off and disconnect from the power supply if there are malfunctions. Have the product checked by a qualified professional and repaired, if necessary, before you operate it again.



WARNING! This product produces an electromagnetic field during operation! This field may under some circumstances interfere with active or passive medical implants! To reduce the risk of serious or fatal injury, we recommend persons with medical implants to consult their doctor and the medical implant manufacturer before operating this product!

Residual Risks:

Even with the intended use of the appliance there is always a residual risk, which can not be prevented. According to the type and construction of the appliance the following potential hazards might apply:

- Contact with exposed saw teeth of the saw chain (cutting hazards)
- Access to the rotating saw chain (cutting hazards)
- Unforeseen, abrupt movement of the guide bar (cutting hazards)
- Flying debris from the saw chain (Cutting / injection hazards)
- Flying debris of the work piece

- Skin contact with the oil
- Health defects resulting from vibration emission if the product is being used over long periods of time or not adequately managed and properly maintained.
- Injuries and damage to property due to broken accessories or the sudden impact of jets during use.
- Danger of injury and property damage caused by flying objects.
- Loss of hearing, if no required ear protection used during work

Safety Warning For Battery Pack

- Fully charge battery packs before the first use.
- Recharge battery packs when the power output starts to slow.
Do not continue to use product when battery capacity level is low.
- To prevent serious damage to the battery pack, charge in temperatures above 5°C or below 45°C. Longest life and best performance can be achieved when battery is charged at room temperature (20 °C ± 5 °C).
- If the battery temperature is hot after use, it must be allowed to cool before putting it into the charging station.
- If the battery pack becomes too hot during charging, disconnect and switch off immediately. Contact the service center directly.
- **Do not dismantle, open or shred cells or battery pack.**
- **Do not short-circuit a battery pack.** Do not store battery packs haphazardly in a box or drawer where they may short-circuit each other or be short-circuited by conductive materials.
When battery pack is not in use, keep it away from other metal objects, like paper clips, coins, keys, nails, screws or other small metal objects, that can make a connection from one terminal to another. Shorting the battery terminals together may cause burns or a fire.

- Do not carry individual battery packs in your pockets or bag as they could short-circuit against other metal items.
- Do not expose battery pack to heat or fire. Avoid use or storage in direct sunlight for extended periods of time.
- Do not subject battery pack to mechanical shock.
- In the event of battery leaking, do not allow the liquid to come into contact with the skin or eyes. If contact has been made, wash the affected area with copious amounts of water and seek medical advice.
- Should a Li-ion battery catch fire, ensure to use the correct fire extinguisher to combat the fire. Do not throw or spray water on a burning Li-ion battery.
- Keep battery pack clean and dry. Wipe the battery pack terminals with a clean dry cloth if they become dirty.
- Battery pack needs to be charged before use. Always refer to this instruction and use the correct charging procedure.
- Do not leave battery pack on charge when not in use.
- After extended periods of storage, it may be necessary to charge and discharge the battery pack several times to obtain maximum performance.
- Battery pack gives its best performance when it is operated at normal room temperature ($20\text{ }^{\circ}\text{C} \pm 5\text{ }^{\circ}\text{C}$).
- When disposing of battery packs, keep battery packs of different electrochemical systems separate from each other.
- Recharge only with the charger specified by manufacturer. Do not use any charger other than that specifically provided for use with the equipment. A charger that is suitable for one type of battery pack may create a risk of fire when used with another battery pack.
- Do not use any battery pack which is not designed for use with the equipment.
- Keep battery pack out of the reach of children.

- Retain the original product literature for future reference.
- Remove the battery from the equipment when not in use.
- Dispose of properly.
- Do not mix cells of different manufacture, capacity, size or type within a device.
- Do not remove battery pack from its original packaging until required for use.

Safety Warning For Battery Charger

- Charge only battery pack of the same model provided by manufacturer and of models recommended by manufacturer.
- Do not use the original charger on other Li-ion batteries or on any other type of battery as this can increase the risk of fire or explosion.
- Check the battery charger, cable and plug before each use. Do not use the battery charger if damaged. Do not open the battery charger yourself, charger must be repaired by qualified personnel using original spare parts.
- The charger is designed to use a standard household 220-240 V~ 50Hz power source, ensure that the plug matches the outlet.
- Never modify the plug in any way, this will reduce the risk of electric shock.
- Do not abuse the cord of charger. Never use the cord for carrying, pulling or unplugging the charger. Keep cord away from heat, oil, sharp edges or moving parts. Damaged or entangled cords increase the risk of electric shock.
- Make sure the charger cord is situated so that it will not be stepped on, tripped over or get damaged.
- If the supply cord is damaged, it must be replaced by the manufacturer, its service agent or similarly qualified persons in order to avoid a hazard.

- Keep the battery charger clean. Contamination can increase the risk of electric shock.
- Protect the battery charger from rain and moisture. If water accesses the battery charger there is an increased risk of electric shock.
- Battery will heat up whilst charging. When charging batteries, ensure that the battery charger is in a well-ventilated area and to reduce the risk of fire, do not operate battery charger on or close to inflammable materials such as paper or textiles.
- Do not overcharge any batteries. Ensure that batteries and chargers are not left unsupervised during charging.
- The temperature range over which the battery pack can be charged is typically between 5°C-45°C. Attempts to charge out with the prescribed temperature range may automatically be blocked by the protection circuitry of the battery pack. Longest life and best performance can be obtained if the battery pack is charged at room temperature.
- Disconnect charger from the power supply when not in use. This will reduce the risk of electric shock or damage to the charger.
- This charger can be used by children aged from 8 years and above and persons with reduced physical, sensory or mental capabilities or lack of experience and knowledge if they have been given supervision or instruction concerning use of the appliance in a safe way and understand the hazards involved.
- Children shall not play with the appliance. Cleaning and user maintenance shall not be made by children without supervision.

PRODUCT DESCRIPTION AND IDENTIFICATIONS

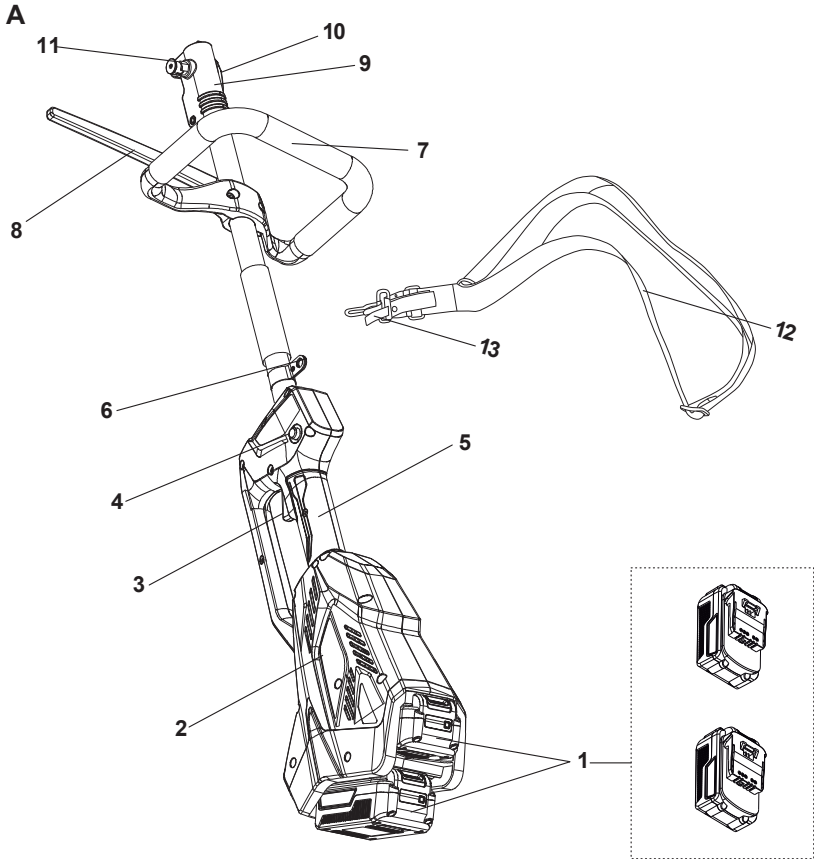

A. Main unit (Power head unit)

- | | |
|----------------------------------|----------------------|
| 1. Battery | 8. Step guard |
| 2. Power head | 9. Clamp |
| 3. Variable speed trigger | 10. Locking wing nut |
| 4. Lock-off button | 11. Locking pin |
| 5. Main handle | 12. Shoulder strap |
| 6. Shoulder strap fixing bracket | 13. Securing clip |
| 7. Auxiliary handle | |

Not all the accessories illustrated or described are included in standard delivery.

B

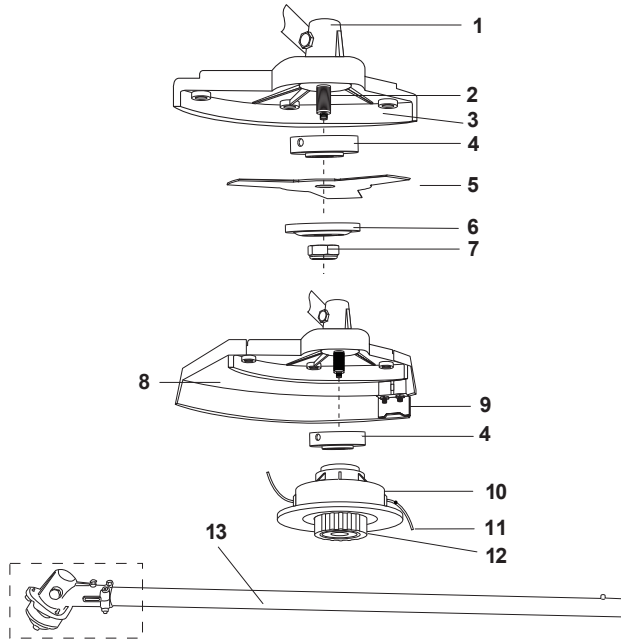

C

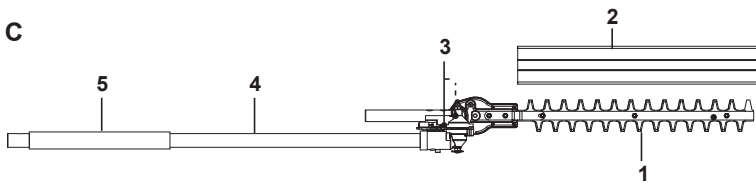

B. Brush cutter/Grass trimmer

- | | |
|-------------------|--------------------------------------|
| 1. Gear box | 8. Trimming guard |
| 2. Spindle | 9. Line cutter |
| 3. Cutting guard | 10. Trimmer head |
| 4. Backing flange | 11. Trimming line |
| 5. Cutting blade | 12. Bumper |
| 6. Locking flange | 13. Brush cutter/grass trimmer shaft |
| 7. Safety nut | |

C. Hedge trimmer attachment

- | | |
|----------------------------|------------------------|
| 1. Blade | 4. Hedge trimmer shaft |
| 2. Blade protection sheath | 5. Gripping surface |
| 3. Angle adjustment levers | |

Not all the accessories illustrated or described are included in standard delivery.

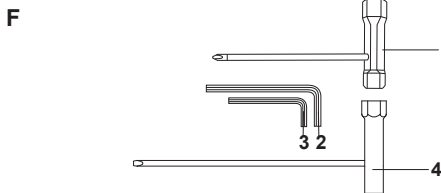
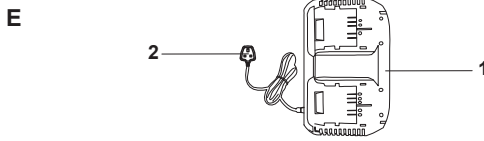
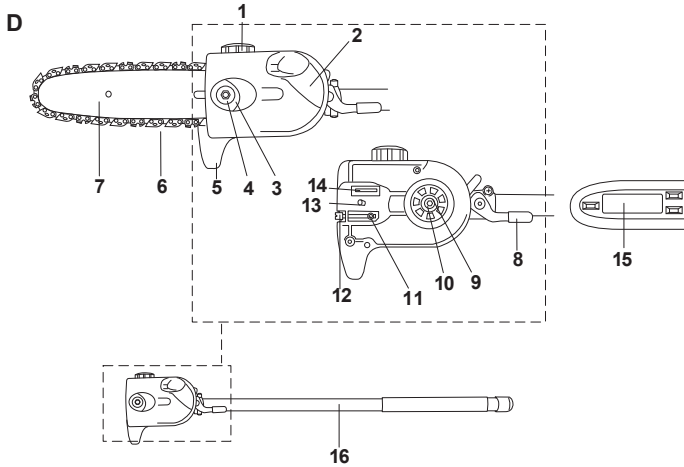

D. Pruner attachment

- | | |
|-----------------------|---------------------|
| 1. Chain oil tank cap | 9. Clutch |
| 2. Cover | 10. Drive sprocket |
| 3. Locking nut | 11. Tension pin |
| 4. Spring washer | 12. Tension screw |
| 5. Pivot | 13. Bolt |
| 6. Saw chain | 14. Oiling port |
| 7. Guide bar | 15. Guide bar cover |
| 8. Locking lever | 16. Pruner shaft |

E. Charger

1. Charger
2. Plug

F. Tools

1. Multi-tool I :cross-head screwdriver/socket wrench
2. Hex key 5 mm
3. Hex key 4 mm
4. Multi tool II: Socket wrench / slotted screw driver

Not all the accessories illustrated or described are included in standard delivery.

ASSEMBLY AND OPERATING INSTRUCTIONS



NOTE: To reduce the risk of injury, user must read instruction manual.



WARNING: Before assembly and adjusting to the multi tool, ensure the multi tool is turned off and the battery packs are removed.

BEFORE STARTING THE PRODUCT



Danger! Do not fit the battery until the tool has been fully assembled. When you are working on the tool, always wear protective gloves and use the supplied blade covers to protect yourself against injury.

INTENDED USE

This 4 in 1 battery powered multi tool is designated with an electrical machinery. Depending on the attached accessory this product is intended to be used as:

- 1). Brush cutter: With the cutter blade attached the product is intended to cut heavier weeds, brush and similar vegetation.
- 2). Grass trimmer: With the line spool attached the product is intended to cut smaller types of weed, lawn grass or similar soft vegetation. It must not be used to work on unusually thick, dry or wet grass, e.g. pasture grass, or to shred leaves.
- 3). Pole hedge trimmer: With the hedge trimmer blade attached the product is intended for trimming wide and high hedges, bushes and shrubs.
- 4). Pruner: With the saw chain/guide bar assembly attached the product is intended for cutting limbs with a thickness of max. 180 mm. The product may only be used with the guide bar/saw chain combination stated in these instructions. It is not permitted to use other types or sizes.
- 5). The product must not be used for cutting other materials, such as plastic, stone, metal or wood that contains foreign objects and must not be used outside of domestic premises.
- 6). Observe the technical data for the maximum cutting capacity according to the application (see "Technical data" - pages 5-7). Do not cut plants exceeding the stated maximum capacity.
- 7). This product is intended for private domestic use only, not for any commercial trade use. It must not be used for any purposes other than those described.

UNPACK

1. Unpack all parts and lay them on a flat, stable surface.
2. Remove all packing materials and shipping devices if applicable.
3. Make sure the delivery contents are complete and free of any damage. If you find that parts are missing or show damage do not use the product but contact the service centre. Using an incomplete or damaged product represents a hazard to people and property.
4. Ensure that you have all the accessories and tools needed for assembly and operation. This also includes proper personal protective equipment.

ASSEMBLY INSTRUCTIONS



WARNING! Be careful with small parts that are removed during assembly or when making adjustments. Make sure you do not lose them.

1. AUXILIARY HANDLER ASSEMBLY

- 1). Loosen the outer pre-assembled screws on the auxiliary handle (A7).

NOTE: There are holes on the bottom side of the upper shaft above the clamp to adjust the position of the handle.

- 2). Align the step guard (A8) with the screw to one of the holes in the shaft and insert the shorter screw into the hole. Tighten it with the cross head screwdriver.
- 3). Place the handle onto the shaft from the top and secure it with the longer screws. Tighten them with the hex key 4mm (F3). (See Fig. 1)

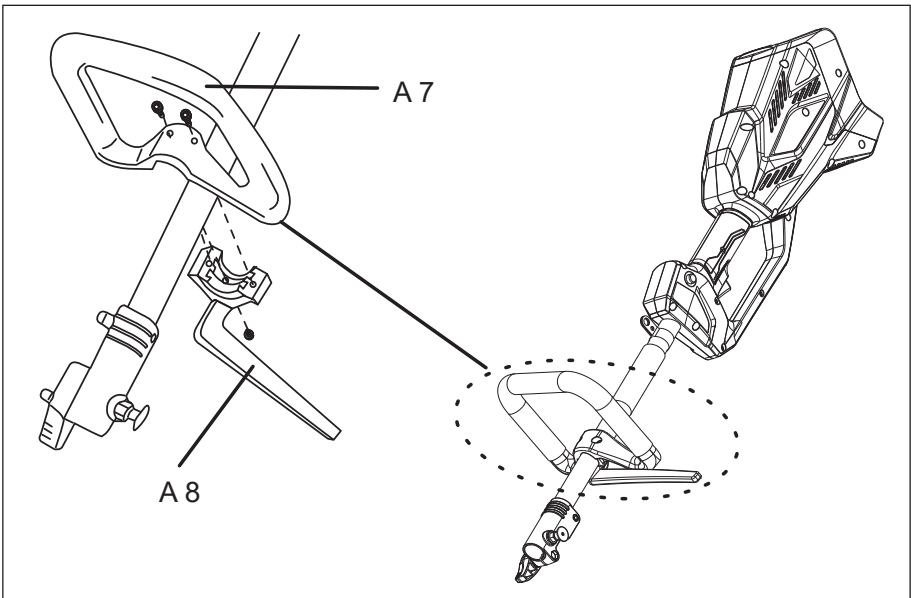

Fig. 1

2. ATTACHMENTS



WARNING! Read all the instructions carefully! Do not start the product until it is completely assembled! Always wear gloves during assembly!

Assemble the relevant attachment to suit the intended application.

NOTE: This product can be used with different cutting heads for different applications. Follow the assembly steps for respective application.

1). Assembling the attachment to the drive shaft tube

- a). Remove the protective cap from the attachment to be used.
- b). Pull out and rotate the locking pin (A10) on the shaft clamp (A9) anticlockwise to stop at the bracket. Insert the shaft tube of the attachment into the upper drive shaft tube (Fig. 2).
- c). Release the locking pin (A10) by turning clockwise. Rotate and slide the upper drive shaft tube inward until the locking pin (A10) snaps into place.
- d). Tighten the locking nut (A11) to secure the connection of the tubes.

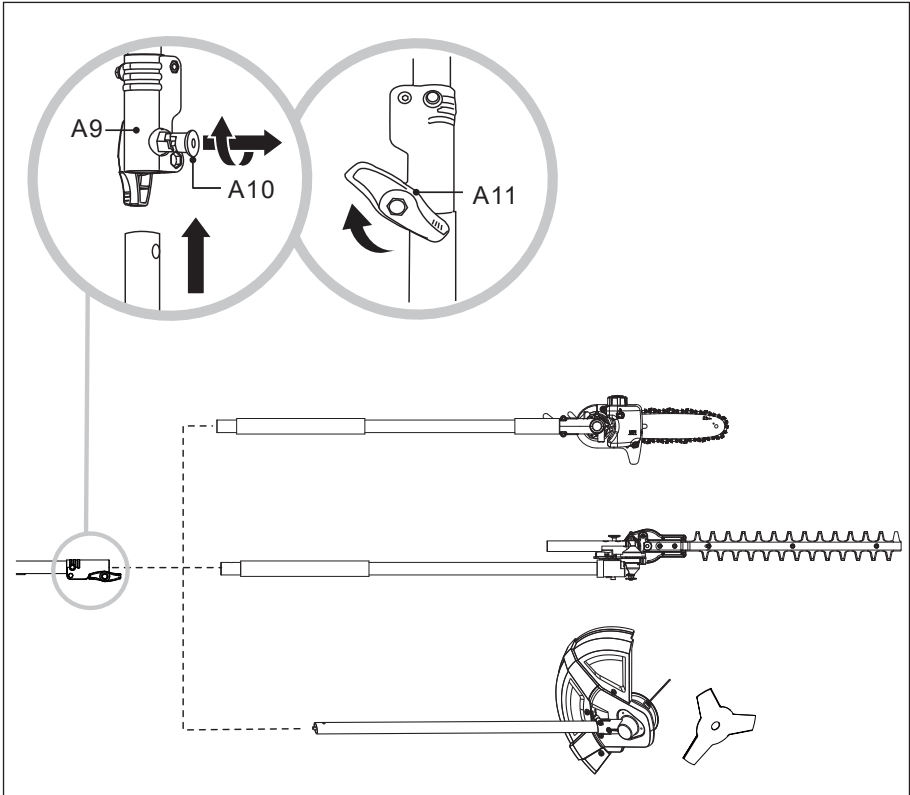

Fig. 2



WARNING! Always make sure the tubes connected are not rotatable. Check there is no loose connection. Loose connection increases vibration and results in machine damage and personal injuries.

2). Brush cutter/grass trimmer attachment assembly

Fit the brush cutter/grass trimmer shaft to the main unit. (See Fig. 3)

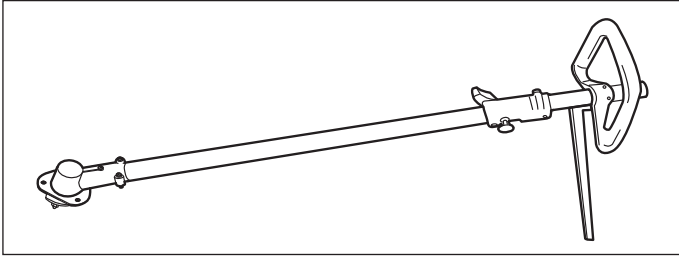

Fig. 3

3). Safety guard assembly

- a). Loosen the three pre-assembled screws on the gear head by using the Hex key 4 mm (F3).
(See Fig.4a)

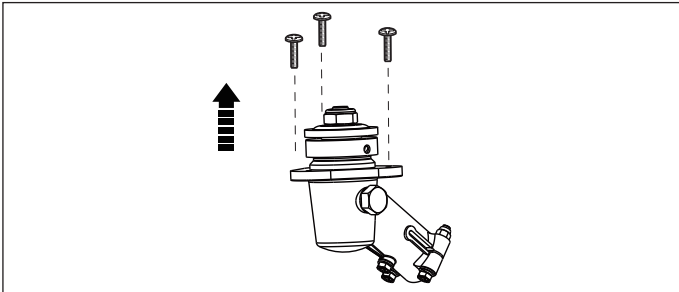

Fig. 4a

- b). Rotate the backing flange (B4) until one of the notches is aligned with the hole in the gear head.
c). Insert the Hex key 4 mm (F3) into the hole to lock the spindle (B2).
d). Loosen the safety nut (B7) and take it off together with the locking flange (B6) and backing flange (B4). (See Fig.4b)

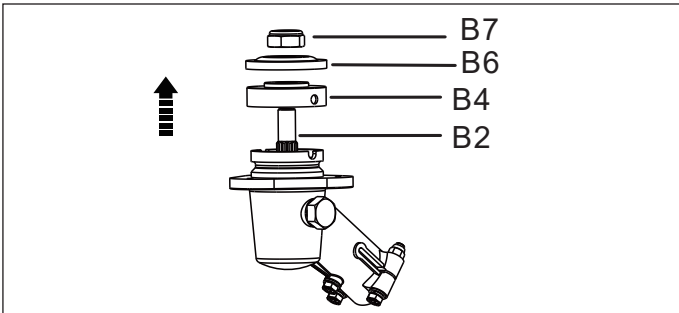

Fig. 4b

- e). Place the cutting guard (B3) onto the support and fix it with the screws by using the Hex key 4 mm (F3). Pay attention to the alignment of the cutting guard. (See Fig. 4c)

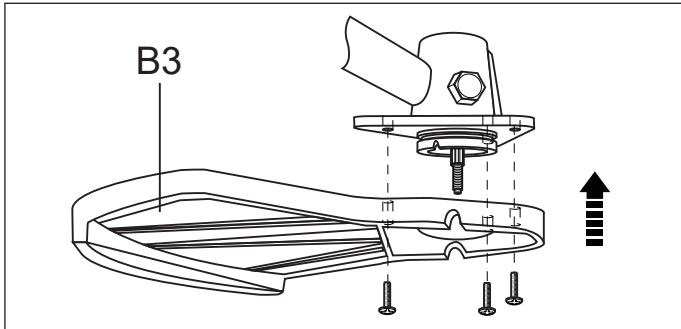

Fig. 4c

- f). If you intend to use the product as brush cutter, proceed as per “Brush cutter assembly” below.
 g). If you intend to use the product as grass trimmer additionally attach the trimming guard (B8). Fix the trimming guard (B8) and with three fixed bolts by using the hex key 5 mm (F2) (See Fig. 4d). Then proceed as per “Grass trimmer assembly” below.

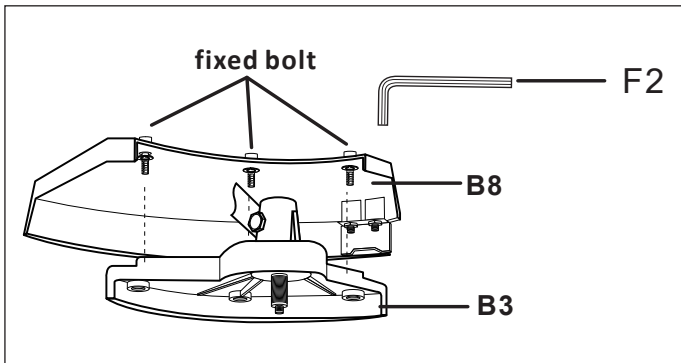

Fig. 4d

4). Brush cutter assembly

- Make sure that the cutting guard (B3) has been attached properly and the screws have been removed from the outer edge.
- Put the backing flange (B4) onto the spindle (B2). Rotate the backing flange (B4) until its hole aligns with the one on the gear head.
- Insert the Hex key 4 mm (F3) into the hole to lock the rotation of the backing flange (B4).
- Fit the blade (B5) to the spindle (B2).
- Put the locking flange (B6) onto the blade (B5).

- f). Secure the blade (B5) with the safety nut (B7) removed earlier. Using the multi-tool I (F1) tighten the safety nut (B7) anti-clockwise to secure the parts in place. (See Fig. 5)
- g). Remove the Hex key 4 mm (F3).

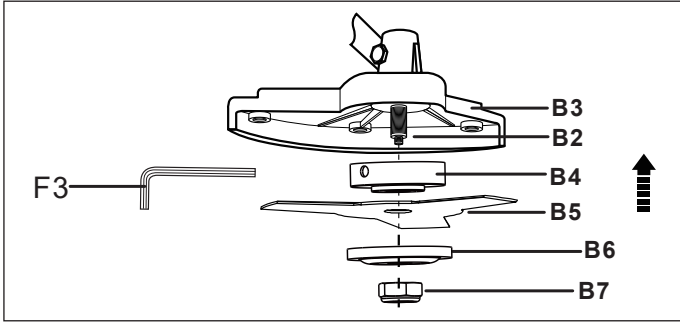

Fig. 5

5). Grass trimmer assembly

- a). Make sure that the cutting guard (B3) and trimming guard (B8) have been attached properly.
- b). Put the backing flange (B4) onto the spindle (B2).
- c). Rotate the backing flange (B4) until its hole aligns with the one on the gear head.
- d). Insert the Hex key 4 mm (F3) into the hole to lock the spindle.
- e). Screw the trimmer head (B10) on the spindle (B2) anti-clockwise securely. (See Fig. 6)
- f). Remove the Hex key 4 mm (F3).



WARNING! Do not attach the locking flange (B6) when using the trimmer head!

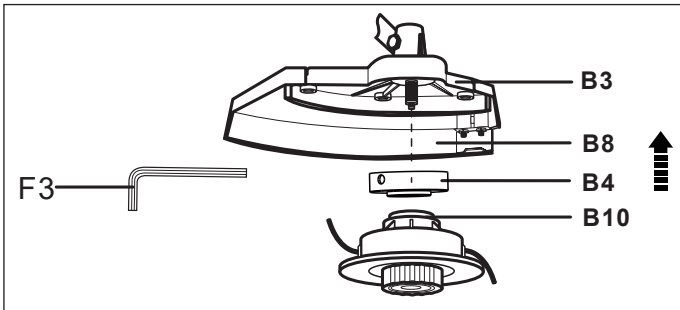

Fig. 6

6). Pruner attachment assembly

Pruner shaft

Fit the pruner shaft (D16) directly to the upper shaft.

Chain and guide bar

a). Use only the guide bar (D7) and saw chain (D6) according to the technical data of the product.



WARNING! Always use a saw chain designed as “low-kickback” or a saw chain which meets the low-kickback requirements. A standard saw chain (a chain which does not have the kickback reducing guard links) should only be used by an experienced professional operator. However, a low-kickback saw chain does not completely eliminate kickback. A low-kickback or “safety” chain should never be regarded as complete protection against injury. The guide bar and chain should only be adjusted, with the battery packs removed.

b). Place the product on a suitable flat surface with the cover (D2) facing upwards.

c). Loosen locking nut (D3) with the socket wrench (F4) anticlockwise and remove it together with the spring washer (D4) and cover (D2). (See Fig. 7a, 7b)

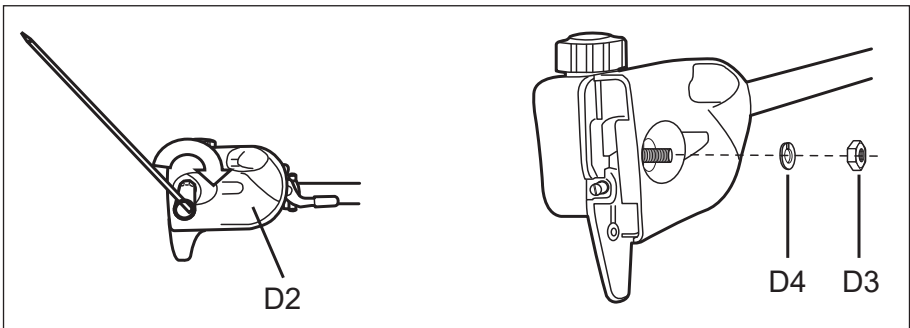

Fig. 7a

Fig. 7b

d). Ensure that the tension pin (D11) is adjusted to its far right position. If not, turn the tension screw (D12) anticlockwise with the slotted screwdriver (F4). (See Fig. 7c)

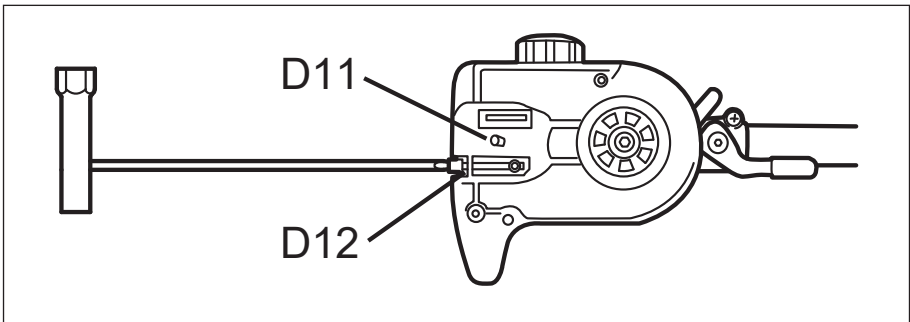

Fig. 7c

- e). Spread the saw chain (D6) around the guide bar (D7). Slide the chain into the groove around the guide bar. Pay attention to the cutting direction.
- f). Align the saw chain around the drive sprocket (D10) and place one corner of the guide bar into a gap of the sprocket. (See Fig. 7d)



WARNING! The direction of the saw chain 'cutters' must be as indicated by the arrow on the pruner head.

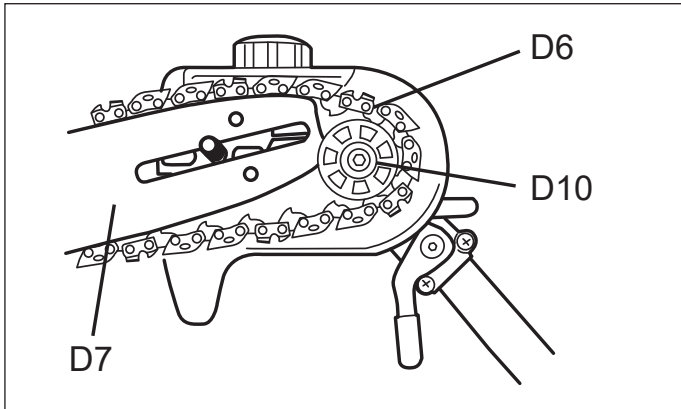

Fig. 7d

- g). Make sure the tension pin (D11) is inserted into the lower hole on the guide bar. (See Fig. 7e)

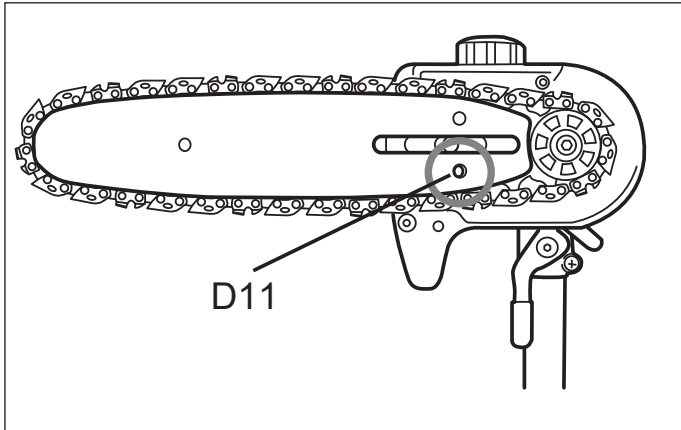

Fig. 7e

h). Refit the cover (D2), spring washer (D4) and slightly tighten the locking nut (D3). (See Fig. 7f)

NOTE: The saw chain (D6) has not yet been tensioned. Tension the chain as described under “Saw chain tensioning”. After operating the product for approx. 30minutes, adjust the chain tension again.

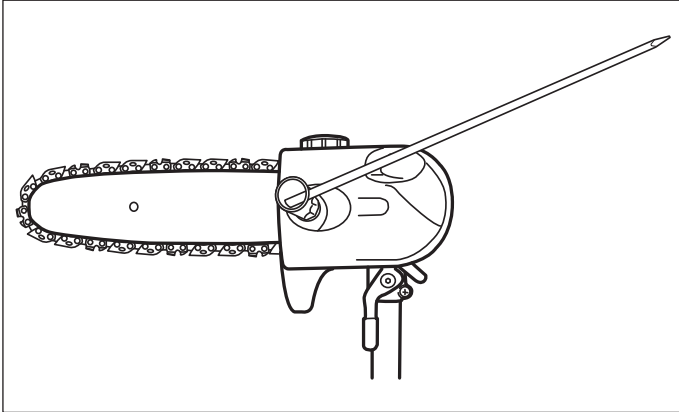

Fig. 7f

Saw chain tensioning

Always check the saw chain tension before use, after first cuts and regularly during use, approx. every five cuts. After initial operation, new chains can lengthen. This is normal during the break-in period and the number of times that the chain requires adjusting will decrease.



WARNING! Always switch the product off and remove the battery packs before adjusting the saw chain tension.

The cutting edges of the saw chain are sharp. Always wear protective gloves when handling the chain.

Always maintain proper chain tension. A loose chain increases the risk of kickback. A loose chain may jump out of the guide bar groove. This may injure the operator and damage the chain. A loose chain will cause rapid wear to the chain, guide bar and sprocket.



Tensioning the chain too tightly will overload the motor and cause damage, and insufficient tension can cause chain derailing, whereas a correctly tightened chain provides the best cutting characteristics and prolonged working life. The chain life mainly depends upon sufficient lubrication and correct tensioning.

- a). Loosen locking nut (D3) with the socket wrench (F4) anticlockwise for 1 or 2 turns to loosen the cover. Lift up the tip of the guide bar (D7) and keep it there as you adjust the tension.
- b). Turn the tension screw (D12) clockwise until the chain "rivet heads" are just touching the bottom edge of the guide bar (D7). (See Fig. 8a)

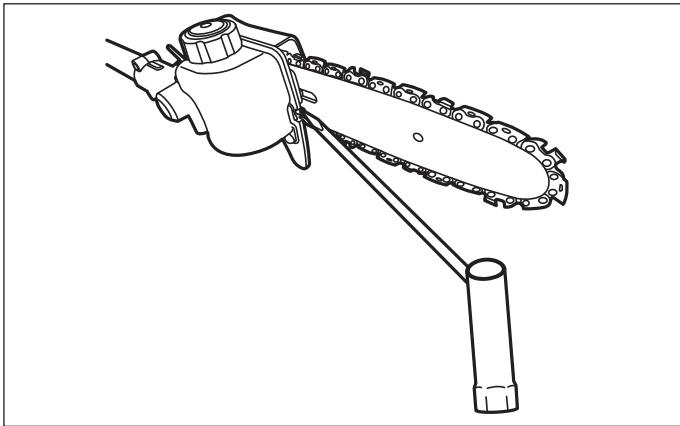

Fig. 8a

- c). Check the chain tension using one hand to lift the saw chain (D6) against the weight of the product. The correct chain tension is achieved when the saw chain can be lifted by approx. 2-4mm from the guide bar (D7) in the centre. (See Fig. 8b, 8c)

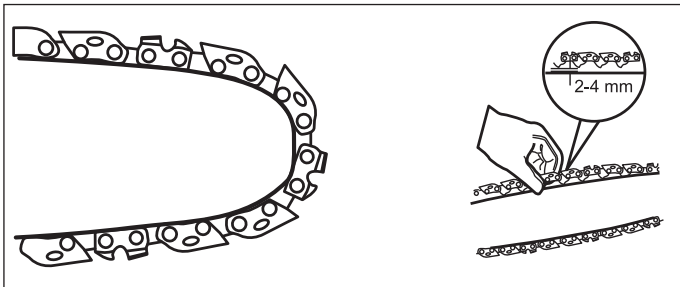

Fig. 8b

Fig. 8c

- d). Turn the locking nut (D3) to tighten the cover (D2).

Chain lubrication

Filling



WARNING! The product is not filled with chain oil. It is essential to fill the product with chain oil before using it. Never operate the product without chain oil as this will result in extensive damage to the product.

Operating the saw chain dry or with too little chain oil will decrease cutting efficiency, shorten the product life span and cause rapid wear to the saw chain and guide bar from overheating. Insufficient chain oil is evident by smoke or bar discoloration. Adequate lubrication of the saw chain during cutting operations is essential to minimise friction with the guide bar.

- a). Set the product on any suitable surface with the chain oil tank cap (D1) facing upwards. (See Fig. 9a)

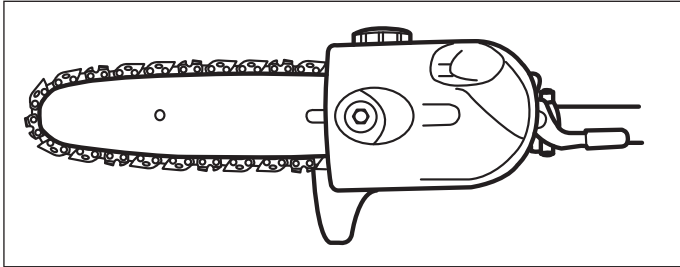

Fig. 9a

- b). Unscrew and remove the tank cap (D1), then add the lubricant into the tank.
We recommend using environmentally-friendly chain oil specifically intended to be used with this product.
- c). Use a proper funnel with a filter to prevent debris entering the tank and to avoid spilling and overfilling the tank. Do not overfill and leave approximately 5 mm of space to the lower edge to allow the lubricant to expand. (See Fig. 9b)

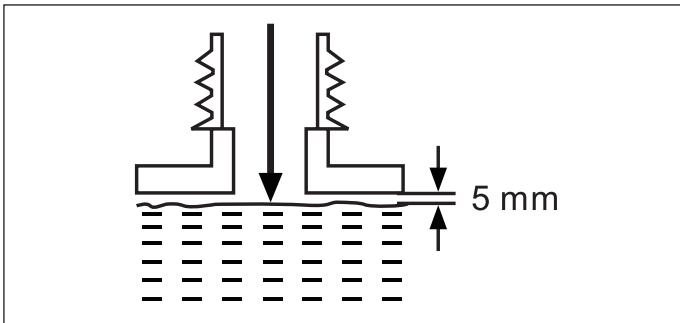

Fig. 9b

- d). Wipe up spilled chain oil with a soft cloth and refit the chain oil tank cap (D1).

NOTE: Always dispose of lubricant, used oil and objects contaminated with them in accordance with local regulations.

Checking chain oil

Check the chain lubrication before each use.

NOTE: This product is equipped with an automatic oiling system. The oiling system automatically delivers the proper amount of oil to the bar and chain.

Checking the lubrication requires starting the multi tool. Before checking, the product must be fully assembled and all instructions must have been read.

- a). Make sure the guide bar (D7) and the saw chain (D6) are in place when you check the oil delivery.

- b). Start the multi tool; keep it running at medium power and check if the chain oil is delivered as shown in the figure. (See Fig. 9c)

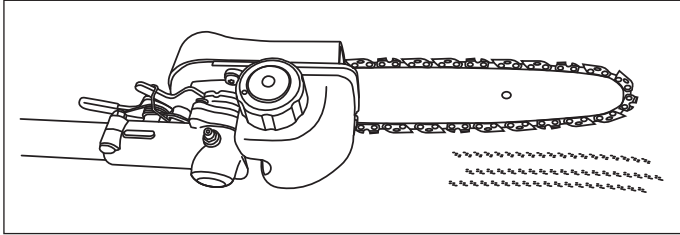

Fig. 9c

BEFORE OPERATION



WARNING: The charger and battery pack are specially designed to work together so do not attempt to use any other devices. Never insert or allow metallic objects into your charger or battery pack connections otherwise an electrical failure and hazard will occur.

NOTE: The battery pack comes partly charged. Charge the battery pack prior to first use, ideally at least 60 minutes.

- Always pull the plug of the charger from the mains before removing or connecting the battery pack to the charger.
- Never charge the battery pack when the ambient temperature is below 5°C or above 45°C.
- Never recharge a battery pack again immediately after rapid charging. This could overcharge the battery pack, thus reducing the lifespan of the battery pack and charger.
- Rest the charger for at least 15 minutes between continuously charging sessions.

NOTE: Always fully charge the two batteries at the same time.

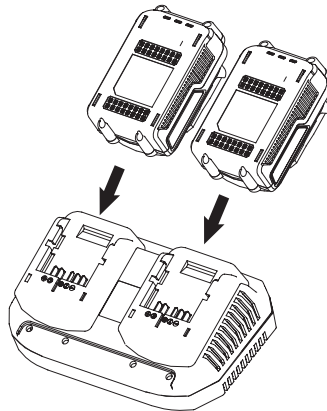

Checking battery capacity

Press the battery capacity level button to check the charging level of the battery pack. The status/remaining capacity will be shown on the battery charging level indication light.

3 Green LED on	Battery pack fully charged
2 Green LED on	Battery pack 65% charged
1 Green LED on	Battery pack 35% charged
No LED lit	Battery is dead and needs to be charged

Charge the battery pack before operating when it is at medium or low battery charging level.

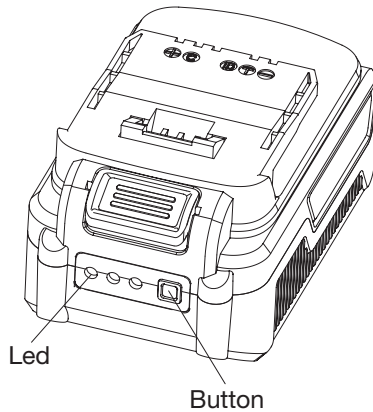

Charging procedure

- 1) Slide the battery pack into the charger base to make connections.
- 2) Connect the battery charger to the power supply. The indicator light will be green and flash to show that the charging has started.
- 3) When charging is completed, the light will be continuous lit, the pack is now fully charged, unplug the charger and remove the battery pack.

Charging light indicator

Red LED on, Green LED off	Charger ready
Red LED off, Green LED flashes	Battery pack charging
Red LED off, Green LED on	Battery pack fully charged
Red LED flashes, Green LED flashes	Battery pack defected
Red LED on, Green LED on	Battery pack too cold or hot

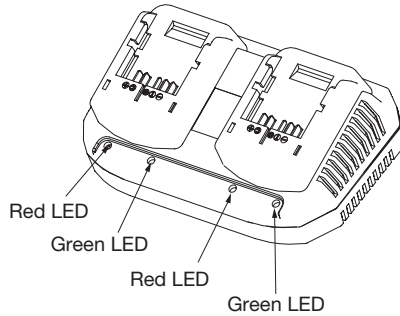

WARNING: When battery pack runs out after continuous use or exposure to direct sunlight or heat, allow time for the pack to cool down before re-charging to achieve the full capacity.

To obtain the best life from the battery

1. Never allow the battery to completely discharge before recharging. The battery pack should be placed on the charger whenever the battery pack is noticeably running down or the tool no longer performs a task it previously performed.
2. Avoid conducting short charges. Make sure that the battery is fully charged each time by allowing the charger to complete its full charging cycle.
3. Avoid allowing loose items like screws or nails etc. to be stored with battery packs as these or similar items can short battery packs and cause a fire or explosion.
4. Always unplug the charger when not in use and store in a dry and secure place.
5. Avoid charging or storing your battery in temperatures below 5°C and above 45°C.
6. After use, allow the battery pack to cool down for approximately 30 minutes before attempting to recharge.

OPERATION INSTRUCTIONS

1. Shoulder strap

The Shoulder strap (A12) helps the operator carry this product.



WARNING! Always attach the product to the shoulder strap. Do not carry it just by hand.

- 1). To remove the shoulder strap from the loop, open the securing clip (A14).
- 2). Place the shoulder strap so that it runs over the left shoulder, crossing the chest and back. The securing clip must be located at the right hip. (See Fig. 10a)

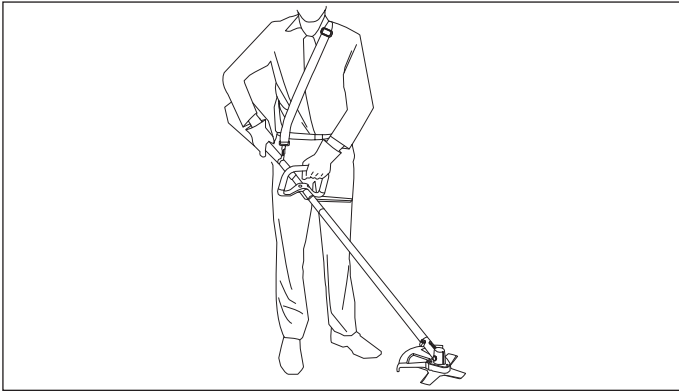

Fig. 10a

- 3). Adjust the length of the harness (A12) so that the hook is approximately 15 cm below your waist; locate the product to the harness by using the securing clip ensuring that the angle of the cutting head is parallel to the surface being cut.



WARNING! Always attach the product to the shoulder strap. Do not carry it only with your hands.

- 4). In case of emergency, pull the rope of the quick release mechanism. The metal locking bar will be released from the securing clip automatically because of the weight of the machine, and the machine will drop away from you. (See Fig. 10b)

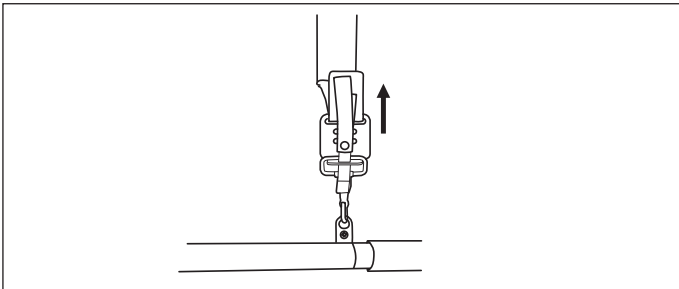

Fig. 10b

2. OPERATION



WARNING! Do not allow familiarity with this product to make you careless. Remember that a careless fraction of a second is sufficient to inflict serious injury.



WARNING! Always wear eye protection. Failure to do so could result in objects being thrown into your eyes and other possible serious injuries.



WARNING! Do not use any attachments or accessories not recommended by the manufacturer of this product. The use of attachments or accessories not recommended can result in serious personal injury.



WARNING! NEVER OPERATE THE POWER HEAD WITHOUT AN ATTACHMENT.

1). INSTALLING/REMOVING THE BATTERY PACKS.

NOTE: Fully charge the battery pack before first use.

To Install

Align the battery ribs with the mounting slots and press the battery pack down until you hear a “click” (see Fig. 11).

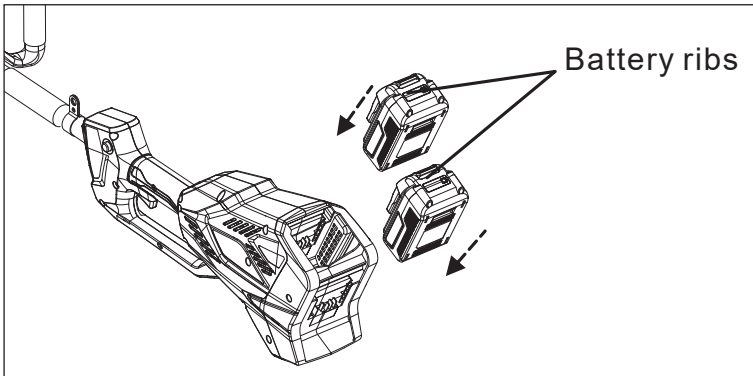

Fig.11

To Remove

Depress the battery-release button and pull the battery pack out.



WARNING! To avoid serious personal injury, always remove the battery pack and keep hands clear of the lock-off button and trigger when carrying or transporting the tool.

2). STARTING/STOPPING THE POWER HEAD

To Start

Press down the lock-off button(A4) and hold it in that position. Depress the trigger(A3) to turn on the power head. Different pressure on the trigger(A3) results in variable rotating speed of the power head. More pressure, higher speed.(see Fig. 12)

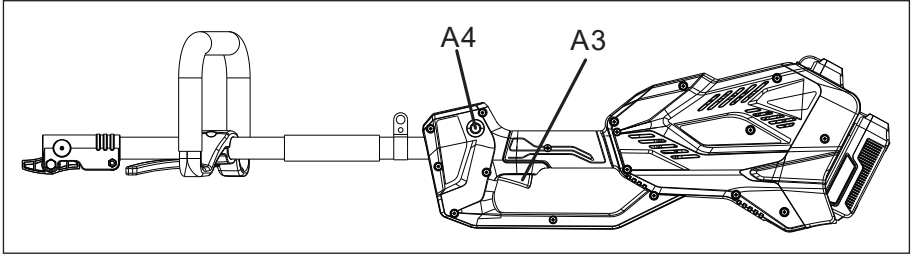

Fig.12

To Stop

Release the trigger.

NOTICE: The motor runs only when the lock-off button and trigger are both pressed.

3. GENERAL BEHAVIOUR

- 1). Check the product as well as accessories for damage before each use. Do not use the product if it is damaged or shows wear.
- 2). Double check that accessories, safety guards and blades are properly fixed.
- 3). Always hold the product by its handles. Keep the handles dry to ensure safe grip.
- 4). Ensure that the air vents are always unobstructed and clean. Clean them if necessary with a soft brush. Blocked air vents may lead to overheating and damage the product.
- 5). Switch the product off immediately if you are disturbed while working with it and when other people enter the working area. Always let the product come to complete stop before putting it down.
- 6). Do not overwork yourself. Take regular breaks to ensure you can concentrate on the work and have full control over the product. Always switch the motor off if you have a break or move to another area.
- 7). It is necessary to change the working positions regularly.

4. BRUSH CUTTER



WARNING! To avoid hazards never cut heavier weeds, brush and similar vegetation with a thickness of over 20mm. Avoid contact with stones, wire, glass etc. that may cause injury to the user. Inspect the blade regularly for damage, cracks or breaks. Always replace a damaged blade.



WARNING! When working with the cutter blade there is always a risk of kickback if the cutting head comes into contact with a hard object. Kickback will cause the sudden stalling of the cutting head, which in turn results in the cutting head being forced in the opposite direction to the rotation of the cutter blade. Ensure that you retain a firm grip with both hands at any sign of such kickback, pay attention and retain a firm stance to avoid injuries.

- 1). Use the cutter blade (B5) to cut heavier weeds, brush and similar vegetation with a thickness of up to 20mm.
- 2). Hold the product firmly so that it sits with a gap between the product and your right side.
- 3). Stand upright, do not lean forward and pay attention to posture. Keep both feet apart to help retain your balance.
- 4). Never hold the cutting head higher than your hip; the higher you hold the cutting head will increase the risk of objects being thrown. (See Fig. 13)

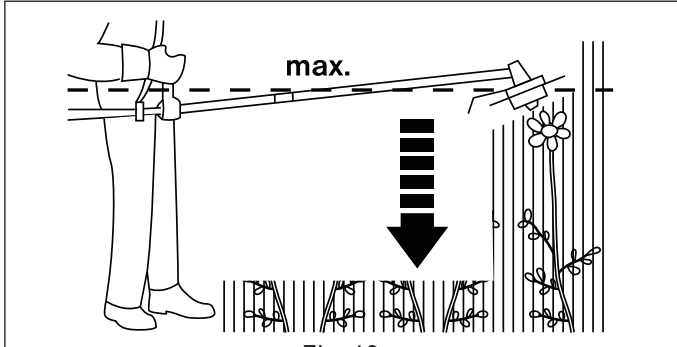

Fig. 13

- 5). Carefully plunge the blade from above when cutting long undergrowth.
- 6). Move the cutting head towards the base of young trees or thicker vegetation.

5. GRASS TRIMMER

- 1). Use the trimmer head (B10) to cut smaller types of weed, lawn grass or similar soft vegetation.
- 2). Remove the protection cap from the line cutter (B9).
- 3). Hold the product firmly so that it sits with a gap between the product and your right side.
- 4). Stand upright, do not lean forward and pay attention to posture. Keep both feet apart to help retain your balance.
- 5). Hold the trimmer head just above the ground at an angle of approximately 30°. (See Fig. 14a)

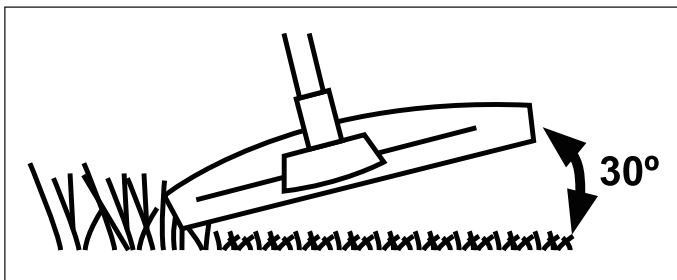

Fig. 14a

- 6). Move the product with slow and regular arc from left to right before moving it back to the starting position before trimming the next area. (See Fig. 14b)

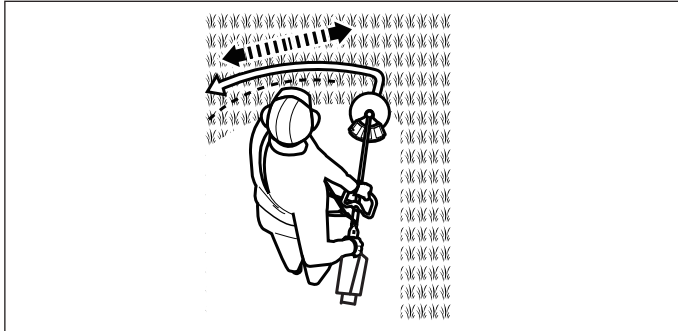

Fig. 14b

- 7). Ensure the cutting head remains clean and free from off-cuts that may cause it to jam. Check regularly. Stop the motor and remove the battery packs before checking.
- 8). Trim longer grass in stages, do not cut long grass in one cut. For the best results, cut longer grass in steps. (See Fig.14c, 14d)

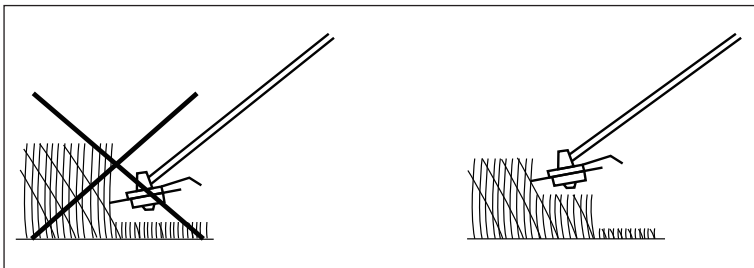

Fig. 14c

Fig. 14d

- 9). The trimmer head is equipped with a bump feed mechanism (B12) when more line is required (B11). Simply tap the bump feed on a firm surface whilst running and the spool will release the trimming line. (See Fig. 14e)

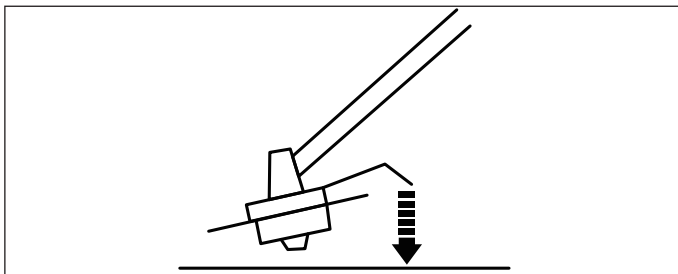

Fig. 14e

10). A line cutter (B9) is integrated with the trimming guard (B8) and this will cut the line to the necessary length. (See Fig. 14f)



WARNING! The cut line will be thrown out. Danger of injury especially for bystanders.

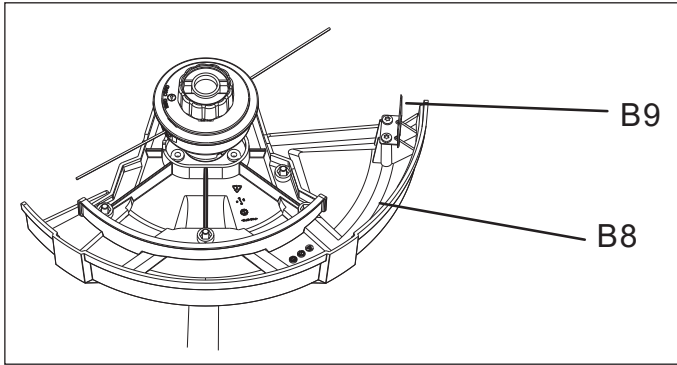

Fig. 14f

11). For best results, do not cut wet grass as it may stick to the cutting heads and guard, preventing proper discharge of grass trimmings, and could cause you to slip and fall.

12). Pay special attention when performing the work close to trees and bushes. The cutting heads could damage sensitive bark, and damage fence posts. (See Fig. 14g)

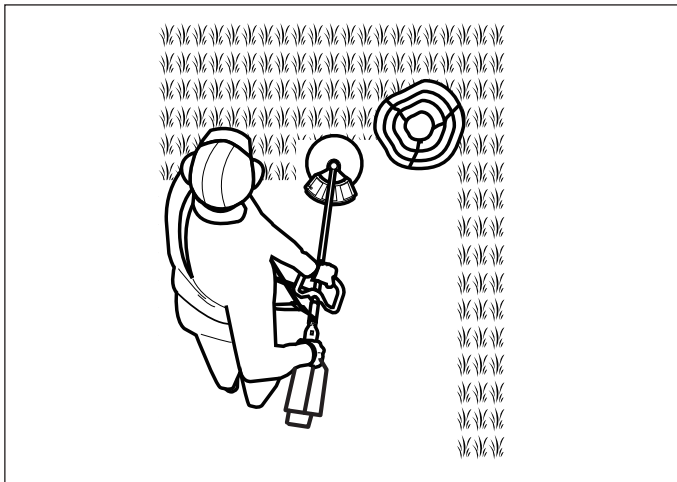

Fig. 14g

6. HEDGE TRIMMER

1). Angle adjustment

Adjust the head of the trimmer to the required angle.

- a). Depress the locking levers (C3) with one hand and hold them in position. (See Fig. 15a)

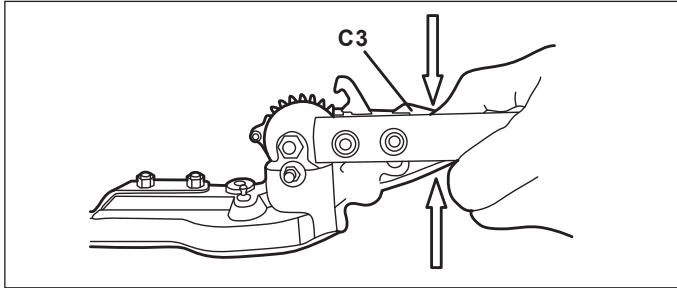

Fig. 15a

- b). Move the hedge trimmer shaft (C4) with the other hand until the desired angle is reached. (See Fig. 15b)

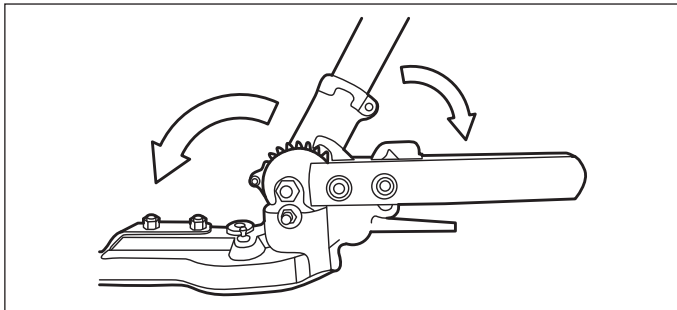

Fig. 15b

- c). Release the unlock levers (C3) when the desired angle is reached. Ensure that the hook engages between two teeth of the tooth wheel. (See Fig. 15c)

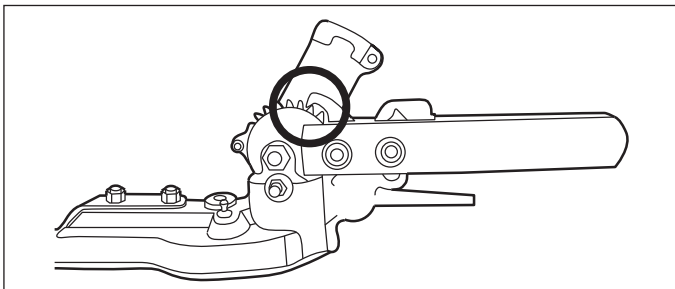

Fig. 15c

2). Trimming

- a). Prepare the product to required length attaching the pole extensions and/or the hedge trimmer shaft.
- b). Cut and remove branches exceeding the cutting capacity of this product using a proper pruner before operation.
- c). Always hold the product firmly with both hands on gripping surface and handle grip (A7). Never operate this product using only one hand.
- d). Cut both sides from the bottom cutting upwards to the top. This will prevent any of the cuttings falling into the path of the area still to be cut. (See Fig. 16a)



Fig.16a

- e). After cutting the sides proceed to the top.
- f). When cutting wide hedges with the cutting area in sight move the cutting blade lightly through the cutting surface in a sweeping motion following the shape of the hedge or shrub. A slight tilt downwards of the cutting blade in the direction of motion is recommended for optimum cutting performance. (See Fig. 16b)



Fig. 16b

- g). Move the product with slow motion forward when cutting higher hedge and the cutting area out of sight. (See Fig. 16c)



Fig. 16c

- h). Do not to rush and do not attempt to cut too much with one stroke of the cutting blade.
NOTE: Try to keep the cutting blade angled at approximately 15° to the cutting surface.
- i). Cut in a number of stages if the area being cut is particularly long to achieve a better result; smaller cuttings will allow for easy composting.
NOTE: When shaping it is advisable to achieve a trapezoidal shape (See Fig. 16d). A trapezoidal cut corresponds to the natural growth of plants and results in optimal hedge growth, as it will expose more light to the bottom of the hedge.

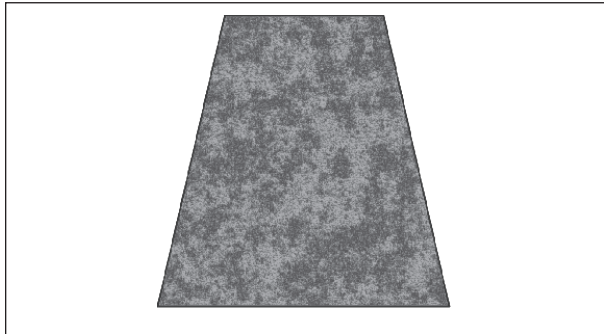

Fig. 16d

7. PRUNING

1). Angle adjustment

Adjust the head to the required angle.

- a). Press the locking lever (D8) downward and hold it in position. (See Fig. 17a)

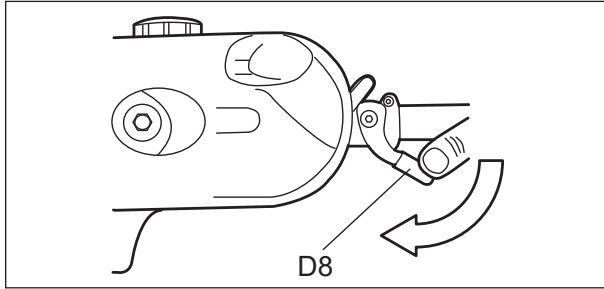

Fig. 17a

- b). Adjust the pruner head to required position and then release the locking lever (D8). (See Fig. 17b)



WARNING! Ensure the locking lever returns to its initial position. To test if the locking lever is properly engaged try to move the pruner head which should now be locked in position.

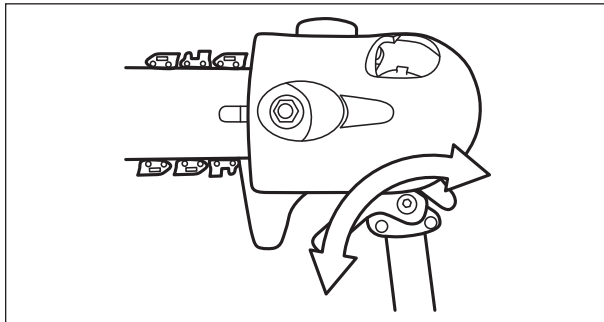

Fig. 17b

2). Kickback



WARNING! Beware of kickback. Kickback can lead to dangerous loss of control of the product and result in serious or fatal injury to the operator or anyone standing close by. Always be alert because rotational kickback and pinch kickback are major product operational dangers and the leading cause of most accidents.

- a). Kickback is the sudden backward/upward motion of the product, occurring when the chain (at the tip of the chain bar) comes in contact with a log or wood, or when the chain becomes jammed.
- b). When kickback occurs the product reacts unpredictably and can cause severe injuries to the operator or bystanders.

- c). With a basic understanding of 'kickback', the element of surprise can be reduced or eliminated. Sudden surprise contributes to the majority of accidents.
- d). You should read all the safety warnings and user instructions carefully before attempting to operate this product.

To avoid kickback:

- Never work with a loose, overstretched or worn out chain
- Ensure chain is sharpened correctly
- Never work with the tip of the guide bar
- Always hold the tool firmly with both hands
- Always use a low kickback chain
- Ensure correct chain tension

3). Pruning

- a). Always hold the product firmly with both hands on gripping surface, and use the shoulder strap (A12) . Never operate this product using only one hand. (See Fig. 18a)

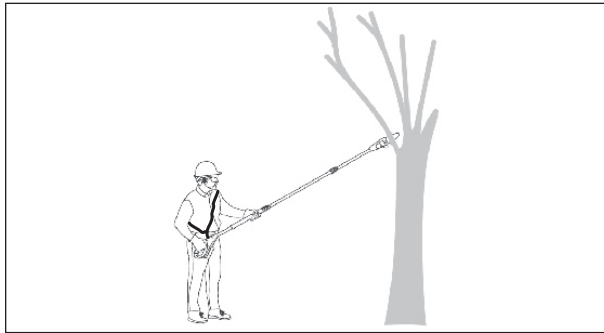

Fig. 18a

- b). Maintain a firm grip with your thumbs and fingers encircling the handles. A firm grip will help you reduce 'kickback' and maintain control of the product.
- c). Always hold the product at an angle of not more than 60° from the horizontal level. Otherwise safe operation is not possible. (See Fig. 18b)

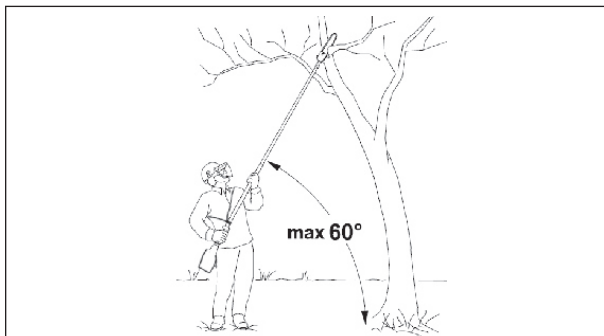

Fig. 18b

- d). Never stand directly under the limb you are sawing. Objects may fall differently than expected. Always position yourself out of the path of falling limbs. (See Fig. 18c)
- e). Keep other persons away from cutting end of product and at a safe distance from the work area. Maintain a minimum distance of 10m to bystanders. (See Fig. 18d)



WARNING! Never climb into a tree to prune. Do not stand on ladders, platforms, logs, or in any position which may cause you to lose your balance or control of the product. When pruning trees, it is important not to make the flush cut next to main limb or trunk until you have cut off the limb further out to reduce the weight. This prevents stripping the bark from the main member.

- f). Never stand on a ladder or other type of unstable support while using the product. Insecure stand invites hazards. (See Fig. 18e)



WARNING! This product has not been designed to provide protection from electric shock in the event of contact with overhead electric lines. Therefore do not use product near cable, electric power or telephone lines. Keep a minimum distance of 10 m to all electric lines. (See Fig. 18f)!

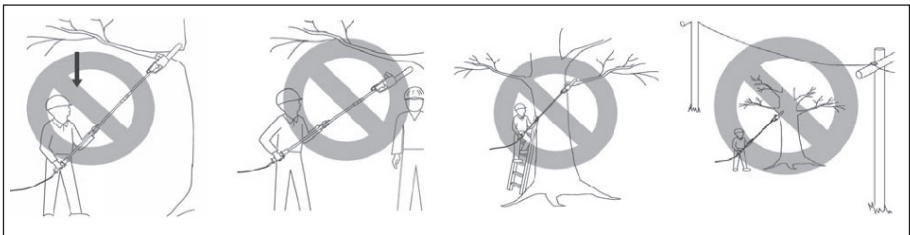

Fig. 18c

Fig. 18d

Fig. 18e

Fig. 18f

- g). Use the product only with secure footing. Hold the product at the right-hand side of your body.
- h). Do not operate the product with arms fully extended or attempt to cut areas which are difficult to reach.
- i). Keep a firm, steady pressure on the product while working. Do not try to force the product through the wood, let the cutting device do the work, using the gripping teeth to apply minimal leverage pressure.
- j). Beware when reaching the end of the cut. The weight of the product may change unexpectedly as it cuts free from the wood. Accidents can occur to the legs and feet. Always remove the product from a wood cut while it is running.

NOTE: The chain must be running at full speed before it comes into contact with the wood.

4). Cut thin branches

Thin branches can be cut off with one single cut. To prevent the branch from slivering and buckling the branch should be cut off in several pieces. (See Fig. 19)

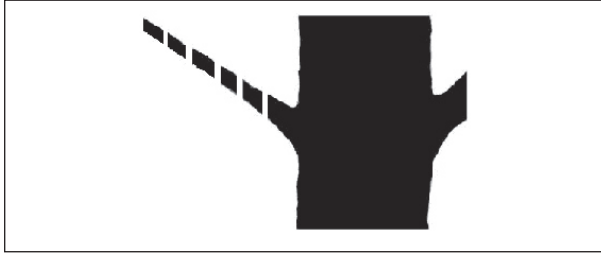

Fig. 19

5). Cut thick branches

When cutting larger branches, three cuts are necessary as shown below:

NOTE: Remove the branches lying on the floor regularly to avoid stumbling hazards. Check the oil level regularly and fill up if necessary. Switch the power off and disconnect batteries when leaving the product.

- First cut into the branch from below, outside of the location where you intend to cut off the branch. The cut should go one third to halfway through the branch. (See Fig. 20a)
- Cut into the branch from the top, outside from where the branch is to be sawn. (See Fig. 20b)
- Last, cut off the stump with one clean cut from top to bottom. You might want to seal the cut with a suitable compound. (See Fig. 20c)

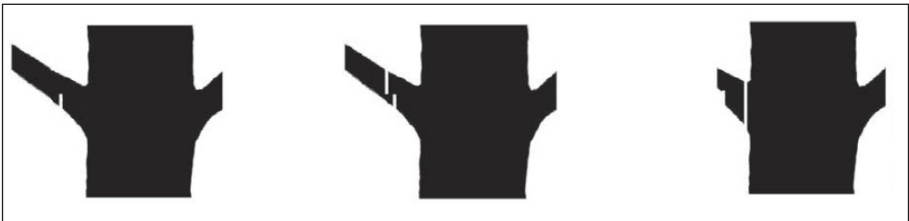

Fig. 20a

Fig. 20b

Fig. 20c

- You might want to seal the cut with a suitable compound.

NOTE: Remove the branches lying on the floor regularly to avoid stumbling hazards. Check the oil level regularly and fill up if necessary. Switch the power off and remove the battery packs when leaving the product.

CARE AND CLEANING

MAINTENANCE



WARNING! Before inspecting, cleaning or servicing the unit, stop the motor, wait for all moving parts to stop, and remove the battery packs. Failure to follow these instructions can result in serious personal injury or property damage.



WARNING! Only perform repairs and maintenance work according to these instructions. All further works must be performed by a qualified specialist!



WARNING! Wear safety gloves when working on the attachment heads and close to it. Use appropriate tools to remove debris, e.g. a brush or wooden stick. Never use your bare hands.

Keep the product clean. Remove debris from it after each use and before storage. Regular and proper cleaning will help ensure safe use and prolong the life of the product.

Inspect the product before each use for worn and damaged parts. Do not operate it if you find broken and worn parts.

GENERAL CLEANING

NOTE: Do not use chemical, alkaline, abrasive or other aggressive detergents or disinfectants to clean this product as they might be harmful to its surfaces.

1. Clean the product with a slightly damp cloth and mild soap. Use a brush for areas that are hard to reach.
2. In particular clean the air vents after every use with a cloth and brush.
3. Remove stubborn dirt with high pressure air (max. 3 bar).
4. Check for worn or damaged parts. Replace worn parts as necessary or contact an authorised service centre for repair before using the product again.

BLADE (BRUSH CUTTER)

1. Keep the cutting blade (B5) clean and free of debris. Remove clippings.
2. Keep the cutting blade (B5) sharp to retain a good cutting performance. Replace a worn or damaged cutting blade with a new one of the same type.

TRIMMER HEAD

1. Keep the trimmer head (B10) clean and free of debris. Remove trimmings.
2. If the line is used up the spool must either be replaced by one of the same type or the trimming line (B11) must be refilled.
3. To refill the trimming line lay the product on a flat stable surface with its trimmer head facing upwards.
4. Rotate the backing flange until one of the notches is aligned with the hole in the gear head.
5. Insert the Hex key 4 mm (F3) into the hole to lock the spindle.

6. Remove the trimmer head (B10) by unscrewing clockwise. (See Fig. 21a)

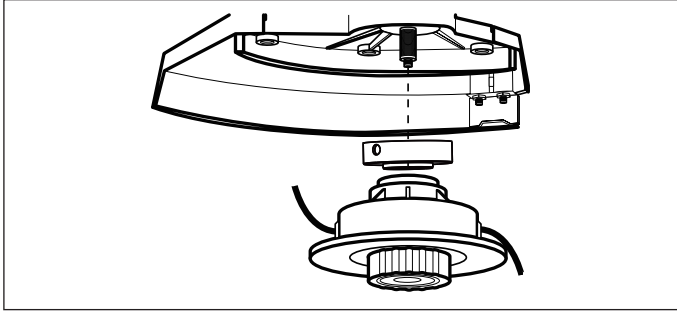

Fig. 21a

7. To replace the spool simply remove from the trimmer head (B10) and replace with a new one of the same type. (See Fig. 21b)

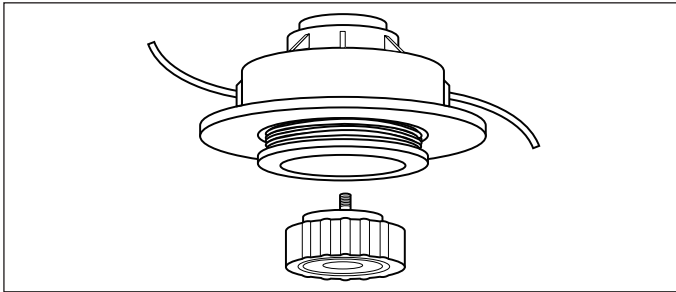

Fig. 21b

8. To replace the trimming line, press the release latch of the trimmer head housing to open the cover.
9. Cut a new 6 m long trimming line with a diameter of 2.0 mm. Form a loop at the middle of the line and insert this loop into the hook on the spool. (See Fig. 21c)

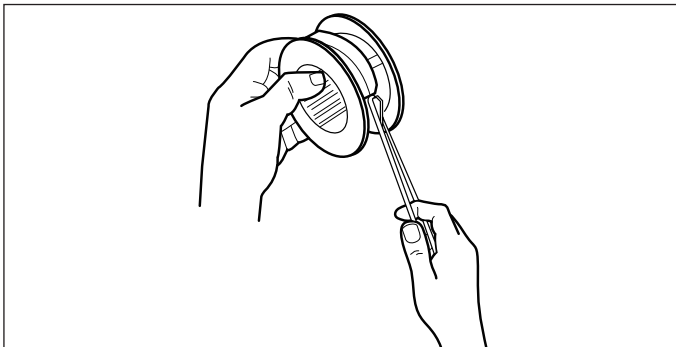

Fig. 21c

10. Wind the two parts of the trimming line in clockwise direction firmly around the spool each part in the guide on the spool. (See Fig. 21d)

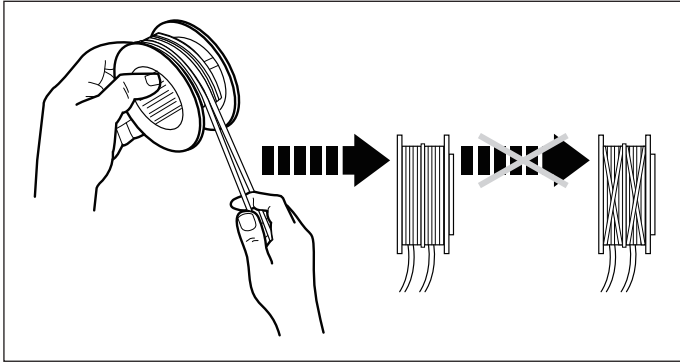

Fig. 21d

11. Insert each end of the threads in the respective holes. The threads protrude by 150 mm on each side.
12. Screw the spool (B12) anti-clockwise until it is completely and safely locked.
13. Remove the Hex key 4 mm (F3).



WARNING! After changing the trimming line, run the product under no load for at least a minute to make sure that the line and the product are operating correctly.



WARNING! Never use steel thread. Always use cutting means in perfect condition, free of damage.

BLADE (HEDGE TRIMMER)

1. Keep the hedging blade (C1) clean and free of debris. Remove trimmings.
2. Keep the hedging blade (C1) sharp to retain a good cutting performance. Replace a worn or damaged cutting blade with a new one of the same type.
3. Lubricate the hedging blade (C1) after each use to prolong the life span of cutting blade and product. Apply light machine oil along the edge of the cutting blade.

GUIDE BAR AND SAW CHAIN MAINTENANCE

1. GUIDE BAR

Most guide bar problems can be prevented by keeping the product well maintained. Incorrect filling and non-standard cutter and depth gauge settings are the causes of most guide bar problems, primarily resulting in uneven bar wear. As the bar wears unevenly, the rails widen, which may cause the chain to clatter and make it difficult to complete straight cuts. If the guide bar is insufficiently lubricated and the product is operated with a saw chain which is too tight, this will contribute to rapid bar wear. To help minimise bar wear, maintenance of the guide bar as well as the saw chain is recommended.

- 1). Disassemble the guide bar and saw chain in reversed order from assembly.

- 2). Check the oiling port (D14) for clogging and clean if necessary to ensure proper lubrication of the guide bar and saw chain during operation. Use a soft wire small enough to insert into the oil discharge hole. (See Fig. 22a)

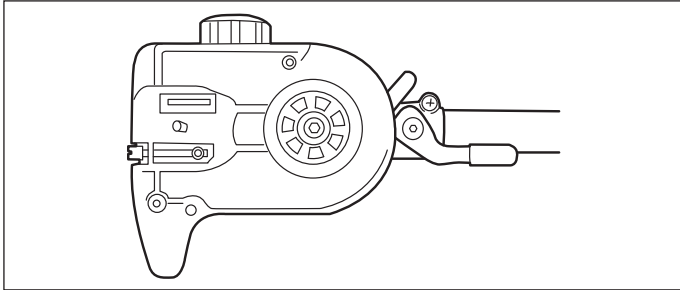

Fig. 22a

NOTE: The condition of the oil passages can be easily checked. If the passages are clear, the chain will automatically give off a spray of oil within seconds of the product starting. Your product is equipped with an automatic oiling system.

- 3). Check the drive sprocket (D10). If it is worn or damaged due to strain, have it replaced by an authorised service agent.
- 4). Clear residue from the rails on the guide bar (D7) using a screwdriver, putty knife, wire brush or other similar tool. This will keep the oil passages open to provide proper lubrication to the guide bar (D7) and saw chain (D6). (See Fig. 22b)

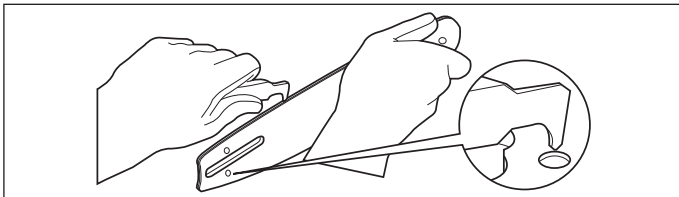

Fig. 22b

- 5). Check the guide bar 'rail' for wear: Hold a ruler (straight edge) against the side of the guide bar and 'cutter side plates'. If there is a gap between the ruler and guide bar the guide bar 'rail' is normal. If there is no gap (ruler flush against the side of the guide bar) the guide bar 'rail' is worn and needs to be replaced with a new one of the same type. (See Fig. 22c)

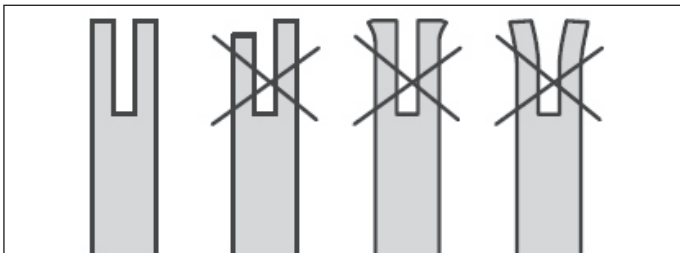

Fig. 22c

- 6). Turn the guide bar 180° to allow even wear, thereby extending the life span of the guide bar (D7).
- 7). Check the saw chain for possible wear and damages. Replace it with a new one if required. Experienced user can sharpen a blunt saw chain (see section “Saw chain sharpening” below).
- 8). Refit the saw chain (D6) and the guide bar (D7) as described under “Assembly”.

2. SAW CHAIN SHARPENING



WARNING! Only sharpen the saw chain yourself if you are trained and have experience. Use proper tools to sharpen the saw chain.

NOTE: Never saw with a blunt chain. The saw chain is blunt if you have to push the product into the tree and the chips are very small.

- 1). Have the saw chain (D6) sharpened professionally at an authorised service centre or sharpen the chain yourself by using a suitable sharpening kit. Also observe the sharpening instructions supplied with the sharpening kit.
- 2). The height difference between the tooth and the ridge is the cutting depth. When sharpening the saw chain (D6) you have to consider the following points. (See Fig. 23a)
 - File angle
 - Cutting angle
 - File position
 - Diameter of round file
 - File depth

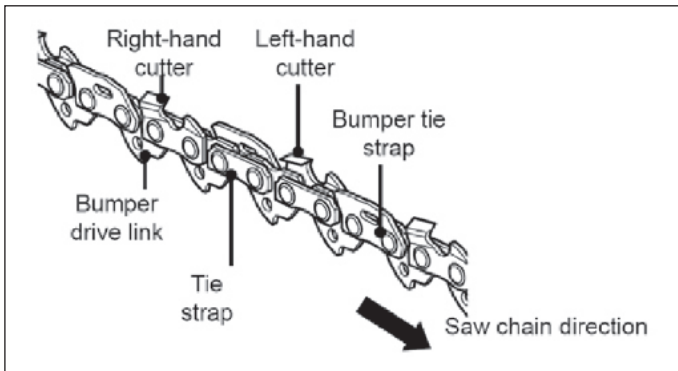

Fig. 23a

- 3). To sharpen the chain proceed as follows:
 - Use protective gloves.
 - Ensure the chain is correctly tensioned.
 - Engage the chain brake to lock the chain on the bar.
- 4). Use a suitable file, whose diameter is 1.1 times the cutting tooth depth. Make sure 20% of the file diameter is above the cutter's top plate.
- 5). A file guide is available from most reputable tool merchants and is the easiest way to hold the file at the correct position.

- 6). File at an angle perpendicular to the bar, and at an angle of 25° to the direction of travel. (See Fig. 23b)

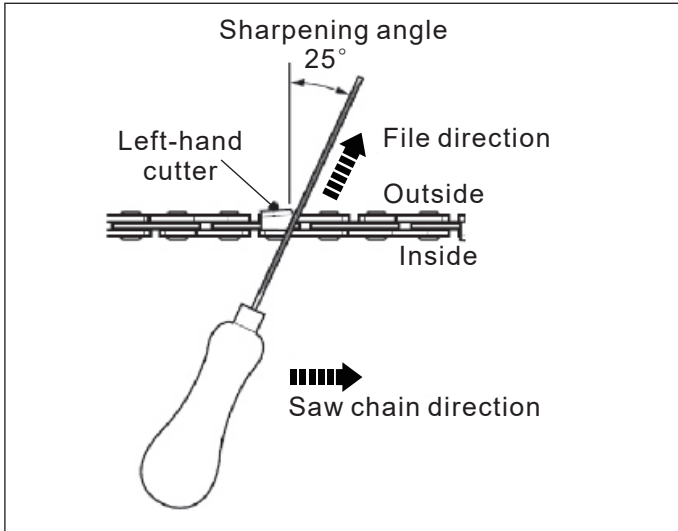

Fig. 23b

- 7). File each tooth from the inside towards outside only. File one side of the chain first than turn the saw around and repeat the process.
- 8). Sharpen each tooth equally by using the same number of strokes.
- 9). Keep all cutter lengths equal. Check the safety depth gauge height every 5 sharpenings. If the depth gauges are also trimmed it is essential that the original profile be restored.
- 10). Use a depth gauge measuring instrument to check the height of the depth gauge. Depth gauge measuring jigs are available from most reputable tool merchants. (See Fig. 28c)

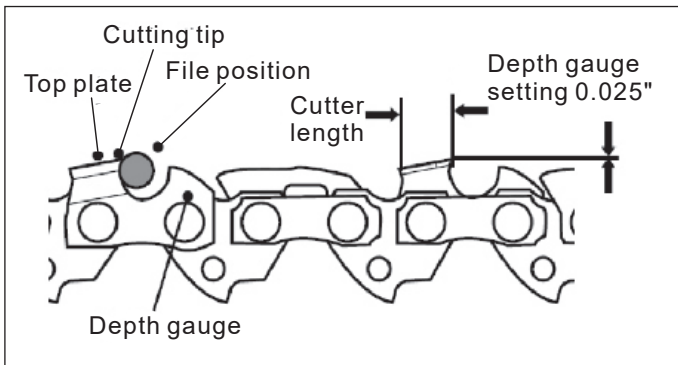

Fig. 23c

CLEANING THE POWER HEAD

1. Stop the motor and remove the battery packs.
2. Clean dirt and debris from the power head using a damp cloth with a mild detergent. NOTICE: Do not use any strong detergents on the plastic housing or the handle. They can be damaged by certain aromatic oils such as pine and lemon.

STORAGE

1. Remove the battery pack from the power head before storing. Follow all aforementioned maintenance instructions. Clean the product as described above.
2. Store the product and its accessories in a dry, frost-free, well-ventilated place.
3. Always store the product in a place that is inaccessible to children. The ideal storage temperature is between 10 and 30°C.
4. We recommend using the original package for storage or covering the product with a proper cloth or enclosure to protect it against dust.

TRANSPORTATION

1. Remove the battery packs from the power head before transporting it anywhere.
2. Attach transportation guards for cutting means of hedge trimmer, brush cutter and pruner.
3. Always carry the product by their handles.
4. Protect the product from any heavy impact or strong vibrations which may occur during transportation in vehicles.
5. Secure the product to prevent it from slipping or falling over.

TROUBLE SHOOTING

Use this section to help you to try and solve any problems you may have:

Fault/malfunction	Cause	Remedy
Fails to start.	The battery pack is not attached to the power head.	Attach the battery pack to the power head.
	No electrical contact between the power head and the battery pack.	Remove battery, check contacts and reinstall the battery pack until it snaps into place.
	The battery pack is depleted.	Charge the battery pack with chargers listed in this manual.
	The lock-off lever and trigger are not depressed simultaneously.	Press down the lock-off lever and hold it, then depress the trigger to turn on the brush cutter.
Stops while cutting.	The motor is overloaded.	The motor will recover when the load is removed. For continuous working, decrease the load on the power head.
	The battery pack or the power head is too hot.	Allow the battery pack or the power head to cool down.
	The battery pack is disconnected from the tool.	Re-install the battery pack.
	Cutting device is blocked	Remove blockage
Unsatisfactory cutting performance	Cutting blade is dull/damaged	Have a specialist to sharpen or replace it
	Cutting material exceeds capacity	Only cut materials acc. to the capacity of the product
Excessive vibration/ noise	Cutting device is dull/damaged	Replace with a new one
	Bolts/nuts are loosen	Tighten bolts/nuts

NOTE: IF YOU EXPERIENCE A PROBLEM WITH YOUR TOOL, PLEASE DO NOT ATTEMPT TO OPEN OR REPAIR THE TOOL YOURSELF. DOING SO MAY VOID THE WARRANTY AND COULD CAUSE DAMAGE OR PERSONAL INJURY. IF THE PROBLEM STILL PERSISTS, PLEASE CONTACT US BY REFERRING TO THE SERVICE & SUPPORT INFORMATION ON THE FOLLOWING PAGE.

DECLARATION OF CONFORMITY / PERFORMANCE



Product Code: 69946 (SLEF1000)

Product Description: Hawksmoor 36V (2 x 18V) 4 in 1 Brushless Cordless Multi Tool

1. Toolstation Limited, Express Park, Bristol Road, Bridgwater, Somerset TA6 4RN

This declaration of conformity is issued under the sole responsibility of Toolstation

2. Object of the declaration

The object of the declaration described above is in conformity with the relevant Community harmonization legislation:

Supply of Machinery (Safety) Regulations 2008

Electromagnetic Compatibility Regulations 2016

Noise Emission in the Environment by Equipment for use Outdoors Regulations 2001

The Restriction of the Use of Certain Hazardous Substances in Electrical and Electronic Equipment Regulations 2012

Electrical Equipment (Safety) Regulations 2016

Noise Emission in the Environment by Equipment for use Outdoors Regulations 2001

FOR GRASS TRIMMER Measured Sound Power Level: 94.5 dB(A)

Guaranteed Sound Power Level: 96 dB(A)

3. References to the relevant standards used or references to the specifications in relation to which conformity is declared:

BS EN 62841-1; BS EN 60335-1; BS EN 62841-4-2; BS EN 50636-2-91; BS EN ISO 11680-1; BS EN ISO 11806-1; BS EN ISO 12100; BS EN IEC 55014-1; BS EN IEC 55014-2; BS EN IEC 61000-3-2; BS EN IEC 61000-3-3; BS EN 60335-2-29; BS EN 62233

4. Additional information:

Signed for and on behalf of Toolstation Limited

ENVIRONMENTAL INFORMATION



The symbol on the product or its packaging indicates that this product must not be disposed of with your other household waste. Instead, it is your responsibility to dispose of your waste equipment by handing it over to a designated collection point for the recycling of waste electrical and electronic equipment. The separate collection and recycling of your waste equipment at the time of disposal will help conserve natural resources and ensure that it is recycled in a manner that protects human health and the environment. For more information about where you can drop off your waste for recycling, please contact your local authority, or where you purchased your product.

GUARANTEE

Toolstation products deliver reliable service for normal, household use in domestic settings. All Toolstation products are individually tested before leaving the factory.

If you are a consumer and you experience a problem with your Toolstation product, which is found to be defective due to faulty materials or workmanship within the Guarantee Period, this Toolstation Guarantee will cover repair or - at the discretion of Toolstation - replacement with a functionally equivalent Toolstation product.

Your product is under guarantee for 2 years from the date of purchase or the date of delivery of the product, if later.

The guarantee is subject to the following provisions:

- The guarantee does not cover accidental damage, misuse, cabinet parts, knobs, or consumable items.
- The product must be correctly installed and operated in accordance with the instructions contained in this manual.
- It must be used solely for domestic purpose.
- The guarantee will be rendered invalid if the product is re-sold or has been damaged by inexpert repair.
- Specifications are subject to change without notice.
- The manufacturer disclaims any liability for the incidental or consequential damages.
- The guarantee is in addition to, and does not diminish your statutory or legal rights.

CUSTOMER SUPPORT

www.coreservice.co.uk

Call us +44 01904 947568

Email: support@coreservice.co.uk

Made in China