

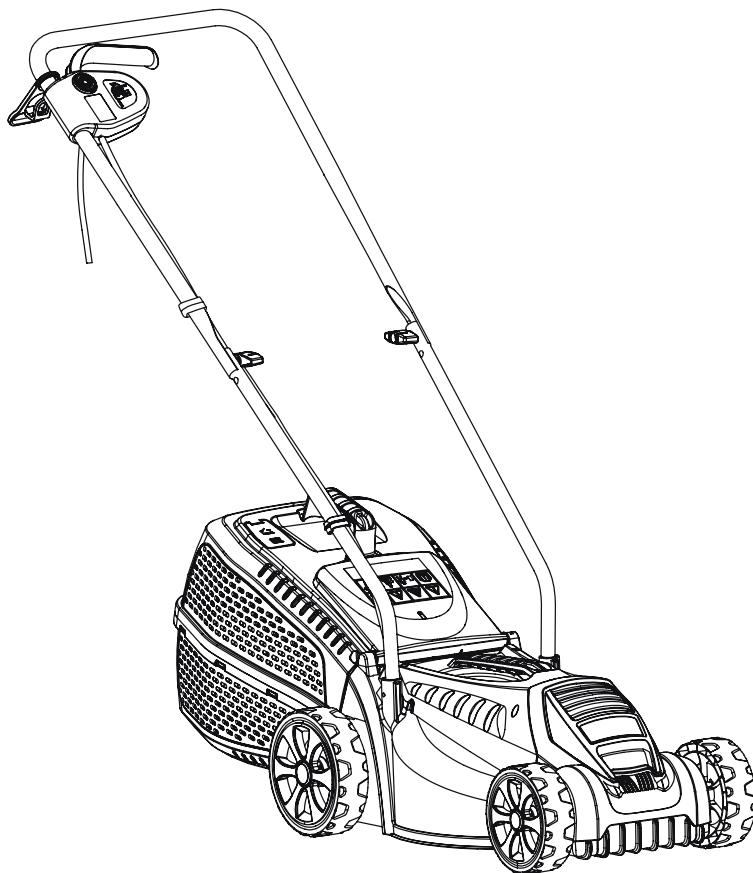

Original User's Instructions

1200W Electric Lawnmower

SKU: 62767



READ BEFORE USE

PLEASE KEEP THESE INSTRUCTIONS FOR FURTHER REFERENCE

CONTENT

• WHAT'S IN THE BOX -----	3
• TOOLS REQUIRED -----	4
• SPECIFICATIONS -----	4
• EXPLANATIONS AND SYMBOLS, CAUTIONS AND WARNINGS -----	5
• IMPORTANT SAFETY WARNINGS -----	8
• PRODUCT DESCRIPTION AND IDENTIFICATIONS -----	13
• ASSEMBLY AND OPERATING INSTRUCTIONS -----	14
• CARE AND CLEANING -----	22
• TROUBLE SHOOTING -----	25
• DECLARATION OF CONFORMITY / PERFORMANCE -----	26
• ENVIRONMENTAL INFORMATION -----	27
• GUARANTEE -----	28
• CUSTOMER SUPPORT -----	28

WHAT'S IN THE BOX

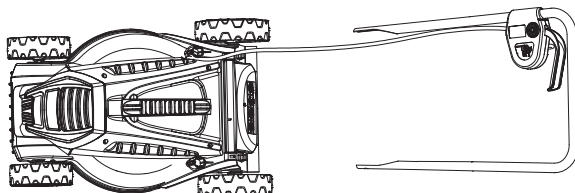

Lawn mower x 1

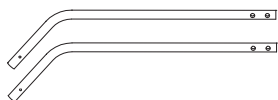

Lower handle x 2

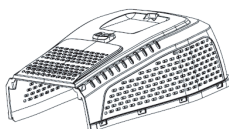

Upper half grass box x 1



Lower half grass box x 1



Cord clip x 2



Grass box handle



Upper handle
locking knob x 2



Upper handle
locking bolt x 2



Screw x 2

If you do not have all these items, please contact:

www.coreservice.co.uk

Hotline: +44 01904 947568

Email support@coreservice.co.uk

TOOLS REQUIRED

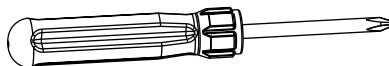

SPECIFICATION

Technical Data	
Model	SLM32F-ZE
Input voltage rating	230-240V~,50Hz
Input power	1200 W
No load speed	3500/min
Max. cutting width	320mm
Cutting height	25/45/65mm, 3 adjustments
Grass catcher volume	30L
Safety class	Class II / 
Weight Approx.	8.2kg
Protection degree	IPX4
Sound values	
Sound pressure level L_{pA} :	73.7dB(A) K=1.12 dB(A)
Sound power level L_{WA} :	93.7dB(A) K=1.12 dB(A)
Guaranteed sound power level L_{WA} :	96dB(A)
Emission pressure level:	87dB(A) K=3dB
Vibration values	
Hand arm vibration a_h :	$\leq 2.5 \text{ m/s}^2$
Uncertainty K:	1.5 m/s^2
Cable	H05VV-F, 2x0.75mm ² , 10m, BS plug

The sound values have been determined according to noise test code given in EN 60335-2-77, using the basic standards EN ISO 11201 and EN ISO 3744.

The sound intensity level for the operator may exceed 80 dB(A) and ear protection measures are necessary.

The declared vibration value has been measured in accordance with a standard test method (according to EN 60335-2-77) and may be used for comparing one product with another. The declared vibration value may also be used in a preliminary assessment of exposure.



WARNING! Depending on the actual use of the product the vibration values can differ from the declared total! Adopt proper measures to protect yourself against vibration exposures! Take the whole work process including times the product is running under no load or switched off into consideration!

Proper measures include among others regular maintenance and care of the product and cutting attachments, keeping hands warm, periodical breaks and proper planning of work processes!

EXPLANATIONS AND SYMBOLS, CAUTIONS AND WARNINGS



This instruction manual accompanies this lawnmower. It contains important information concerning assembly, start-up and handling. Before using the lawnmower, read the instruction manual carefully. This particularly applies to the safety notes. Failure to heed this instruction manual may result in severe injury or damage to the lawnmower. The instruction manual is based on the standards and rules in force in the European Union. Store the instruction manual for future use. If you pass the lawnmower on to third parties, please be absolutely sure to include this instruction manual.

You can request an electronic version of these instructions from our customer service centre.

Explanation of symbols

The following symbols and signal words are used in this instruction manual, on the lawnmower or on the packaging.



Read the user manual before operating the machine.



Warning! Danger!



Wear correct Personal Protective Equipment (PPE) when operating this machine such as eye protection, ear protection and respiratory equipment where necessary.



IMPORTANT! Wear gloves to protect your hands.



Wear safety boots to protect your feet.



Guaranteed sound power level value in 96dB.



The product complies with the applicable European directives and an evaluation method of conformity for these directives was carried out.



UK Conformity Assessed



WEEE symbol. Waste electrical products should not be disposed of with household waste. Please recycle where facilities exist. Check with your Local Authority or local store for recycling advice.



Do not expose the product to rain or wet conditions.



Double insulation.



Objects thrown out by the product could hit the user or other bystanders. Always ensure that other people and pets remain at a safe distance from the product when it is in operation. In general, children should be kept away from the area where the product is being operated.



Beware of sharp blades. Blades continue to rotate after the motor is switched off. Remove the plug from the mains before performing any maintenance or if the cord is damaged.



STOP

The cutting device will continue to rotate after the product is switched off. Wait until all components have completely stopped before performing any work on the product.



Switch the lawnmower off and disconnect it from the power supply before assembling, cleaning, making adjustments, performing maintenance, storing or transporting the machine.



Keep supply flexible cord away from cutting device.

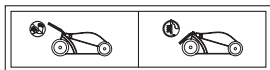

Always make sure the rear flap is closed in position when working the mower.



WARNING!

This appliance should be connected to your mains supply using an RCD (Residual Current Device). The operating current of this device must be less than 30mA. Contact an electrician if you are unsure on how to proceed.

For safety reasons, this lawnmower is not to be used by children, young people under the age of 16 or any other people who are not acquainted with these operating instructions.

IMPORTANT SAFETY WARNINGS

Proper use

1. Operate the product only in daylight or in good artificial light.
2. Avoid operating the product in wet grass.
3. Always be sure of your footing on slopes.
4. Walk, never run.
5. Do not use this appliance in wet conditions.
6. Mow across the face of slopes, never up and down.
7. Exercise extreme caution when changing direction on slopes.
8. Do not mow excessively steep slopes.
9. Use extreme caution when reversing or pulling the product towards you.
10. Stop the blades if the product has to be tilted for transportation, when crossing surfaces other than grass and when transporting the product to and from the area to be mowed.
11. Switch on the motor carefully according to the instructions and with your feet well away from the blades.
12. Do not tilt the product when switching on the motor except if the product has to be tilted for starting. In this case do not tilt it more than absolutely necessary and lift only the part which is furthest away from the operator.
13. Do not put hands or feet near or under rotating parts. Keep clear of the discharge opening at all times.
14. Do not transport the product while the mains power is connected.
15. Stop the product and remove the plug from the socket. Make sure that all moving parts have come to a complete stop:
 - Whenever you leave the product unattended.
 - Before clearing blockages or unclogging the chute.

- Before checking, cleaning or working on the product.
- After striking a foreign object. Inspect the product for damages and replace or repair any damaged parts before restarting the product.

16.If the product starts to vibrate abnormally:

- Inspect for damage.
- Replace or repair any damaged parts.
- Check and tighten any loose parts.

Safety notes



WARNING!

DO NOT TOUCH ROTATING BLADES.

- This machine can cause serious injury. Read the instruction manual carefully for the correct handling, preparation, maintenance, starting and stopping of the appliance. Be familiar with the controls and the proper use of the appliance.
Read and understand the operator's manual and observe the warnings and instruction labels affixed to the appliance.
- Never allow children or people unfamiliar with these instructions to use the appliance. Never operate this appliance when tired or under the influence of alcohol, medication or drugs.
- Use appropriate tools. This product is intended for private use only, not for any commercial applications. It may not be used for any purposes other than those described in this manual.

Work Area Safety

- Keep work areas clean. Cluttered areas can cause accidents.
- Keep all bystanders, children and pets at least 5 metres away.
The operator or user is responsible for any accidents or hazards occurring to other people or their property.

Personal Safety

- Wear the correct personal protective equipment (PPE). Always wear eye protection. Protective equipment such as a dust mask, non-skid safety shoes or gloves used for appropriate conditions will reduce the risk of personal injury.
- Dress appropriately. Do not wear loose clothing or jewellery, as these can be caught in moving parts. Preferably wear nonslip footwear when working outdoors. Long hair should be tied back out of the way.
- Stay alert and use caution and common sense when operating the lawnmower. A moment of lapsed concentration while operating the lawnmower may result in serious personal injury.
- This appliance can be used by persons aged 18 years and above and people with reduced physical, sensory or mental capabilities or lack of experience and knowledge if they have been given supervision or instruction concerning the use of the appliance in a safe way and understand the hazards involved.
- Children should be supervised to ensure that they do not play with the machine.
- Read the instructions carefully. Be familiar with the controls and the correct use of the product.
- Never allow children or people unfamiliar with these instructions to use the product. Local regulations can restrict the age of the operator.
- Never operate the product while children, other people or pets are nearby.

- Keep in mind that the operator or user is responsible for any accidents or hazards occurring to other people or their property.

Operational Safety

- Be certain that all parts of the machine are fully tightened before operating the machine. Check periodically for tightness during use to avoid serious injury.
- While operating the product always wear substantial footwear and long trousers. Do not operate the product when barefoot or wearing open sandals. Avoid wearing clothing that is loose fitting or that has hanging cords or ties.
- Thoroughly inspect the area where the product is to be used and remove all objects which could be thrown by the product.
- Before use, always visually inspect to see that the blade, blade bolt and the blade assembly are not worn or damaged.
- Replace worn or damaged components in sets to preserve balance. Replace damaged or unreadable labels.
- Before use, check the supply and extension cord for signs of damage or aging. If the cord becomes damaged during use, disconnect the cord from the mains power immediately. **DO NOT TOUCH THE CORD BEFORE DISCONNECTING THE MAINS POWER.**
- Do not use the product if the cord is damaged or worn. If the cord requires replacement this should only be carried out by the service agent or a similarly qualified person.
- Keep all nuts, bolts and screws tight to be sure the product is in a safe working condition.
- Check the grass collector frequently for wear or deterioration.
- Be careful during the adjustment of the product to prevent entrapment of the fingers between moving blades and fixed parts of the product.

- When servicing the blades be aware that, even though the power source is switched off, the blades can still move.
- Replace worn or damaged parts for safety. Use only genuine replacement parts and accessories.

Checking the lawnmower and product contents



WARNING!

RISK OF DAMAGE!

If you are not cautious when opening the packaging with a sharp knife or other pointed objects, you may easily damage the lawnmower. Therefore, be very careful when opening.

1. Take the lawnmower out of the packaging and check whether the appliance or the individual parts show any signs of damage. If any parts are missing or damaged, do not use the lawnmower. Contact the manufacturer at the service address specified on the warranty card.
2. Check to make sure that the delivery is complete (see WHAT'S IN THE BOX).

PRODUCT DESCRIPTION AND IDENTIFICATIONS

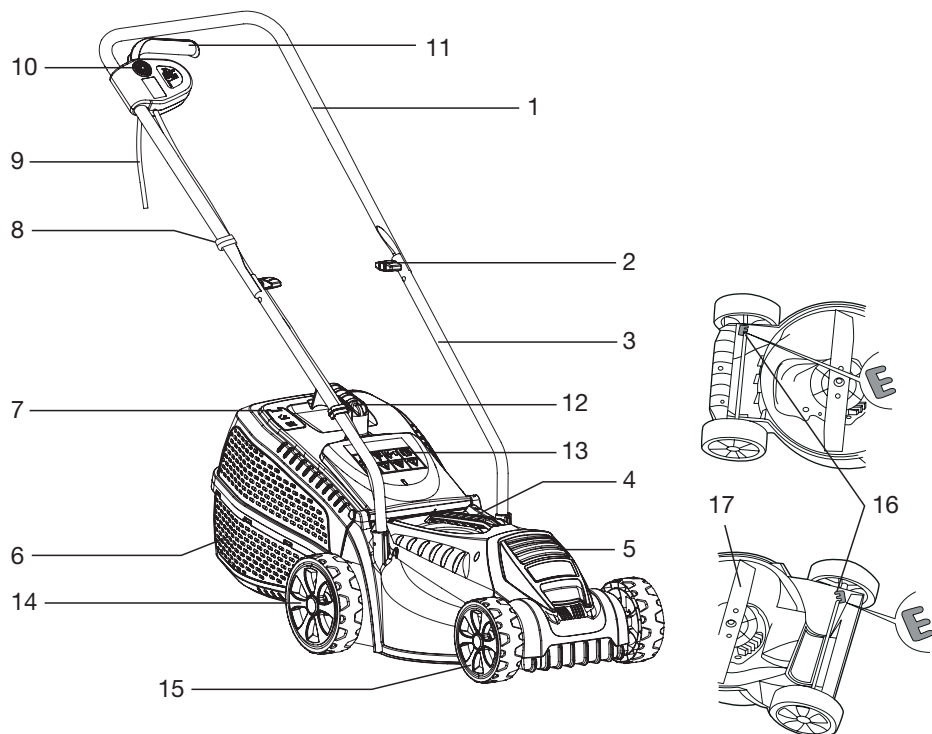

- | | |
|-----------------------------|--------------------------|
| 1 Upper handle | 10 Lock off button |
| 2 Upper handle locking knob | 11 Switch lever |
| 3 Lower handle | 12 Collection box handle |
| 4 Transportation handle | 13 Safety rear flap |
| 5 Motor housing | 14 Rear wheel |
| 6 Grass collection box | 15 Front wheel |
| 7 Grass full indicator | 16 Wheel shaft slot |
| 8 Cord clip | 17 Blade |
| 9 Cable | |

Not all the accessories illustrated or described are included in standard delivery.

ASSEMBLY AND OPERATING INSTRUCTIONS

Assembly

Mounting the lower handle

1. Insert the lower handle into the supports. Ensure the mounting holes in the lower handle are aligned with the ones in the supports (See Fig A).

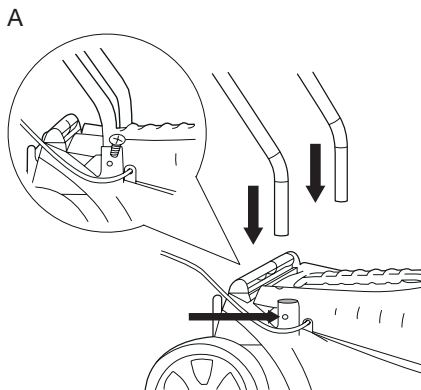

2. Secure the lower handle with the screws and tighten them with a suitable crosshead screwdriver.

Mounting the upper handle bar

1. Remove the bolts from the knobs and keep them handy.
2. Attach the upper handle to the lower handle and align the holes in the upper handle with the ones in the lower handle (See Fig B).

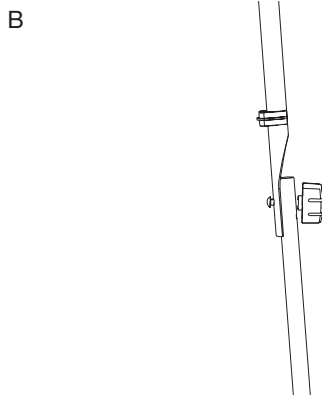

3. Secure the upper handle with the knobs and bolts to the lower handle and tighten the knobs clockwise.
4. Fix the power cord using the cord clips to the handle (See Fig C).

C

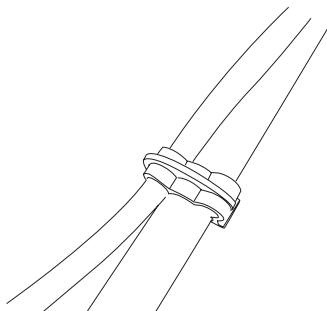

Mounting the grass collection box

1. Fit the upper part of the grass collection box onto the lower part by fixing all the outer clips correctly (See Fig D).

D

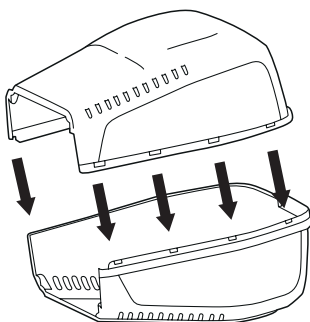

2. Fit the grass box handle onto the top of the grass catcher so that it clicks into place (See Fig E).

E

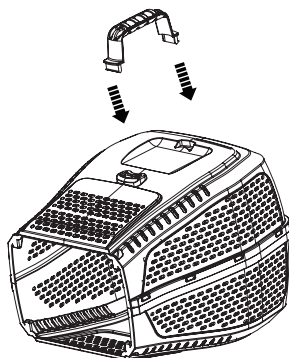

3. Lift the safety rear flap with one hand and hook in the grass collection box. Release the rear flap to secure the grass collection box in position. (See Fig F & G).

F

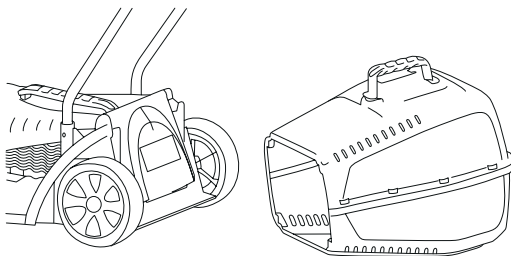

G

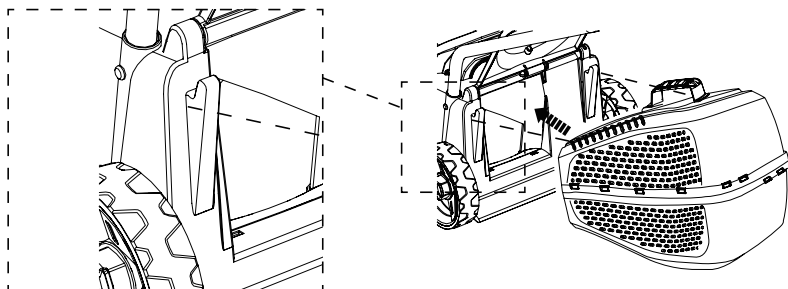

Connecting to the power supply



WARNING! For your safety, the extension cord must be suitable for outdoor use with sockets that are protective against splashing water!

Extension cords that are safe to use are:

- if rubber insulated, ordinary tough rubber sheathed flexible cord (code designation 60245 IEC53);
- if polyvinyl chloride insulated, ordinary polyvinyl chloride sheathed flexible cord (code designation 60227 IEC 53).

Ensure the extension cord is of the proper size and type for your product($\geq 1.5\text{mm}^2$)!

Always use a residual current supply (RCD) protected supply!

1. Connect the plug to the main socket. (See Fig I)

I

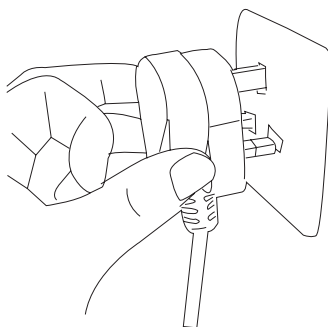

Operation

Cutting height adjustment

Adjust the cutting height according to the needs of your lawn.

The cutting height depends on the kind of lawn and its actual height. When mowing high grass, start with the maximum cutting height and make a second cut with a lower cutting height.

1. Release the start lever and disconnect the product from the power supply.
2. Pull the rear and front shafts out and place them into the correct slot for the desired cutting height. (See Fig J&K)
3. Make sure that the rear and front shafts are at the same level. (See Fig J&K)

J

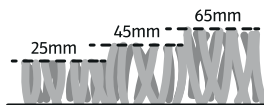
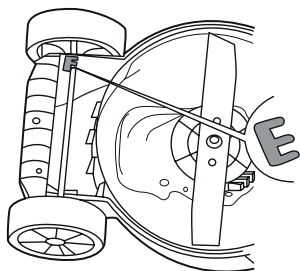

K

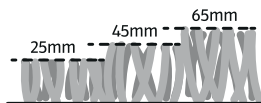
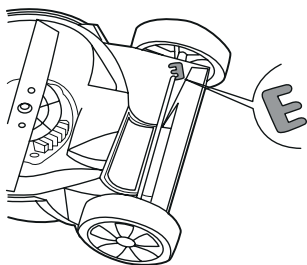

NOTE! Always ensure the shafts click back into the slot.

Grass collection box

Always attach the grass collection box when using the product for grass collection. Always carry the grass collection box by its handle.

Empty the grass collection box frequently during use. Do not wait until it is completely full. We recommend emptying it when it is half full.

If the collection box is empty or not filled with grass, the grass full indicator will be in a status of flap-floats. (See Fig L)

L

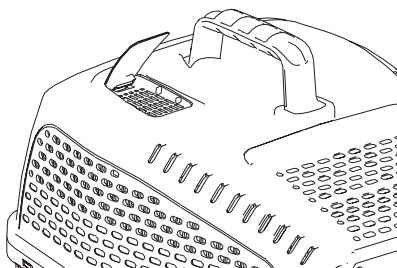

If the collection box is full of grass the grass full indicator will in a status of flap-falls-down. (See Fig M)

M

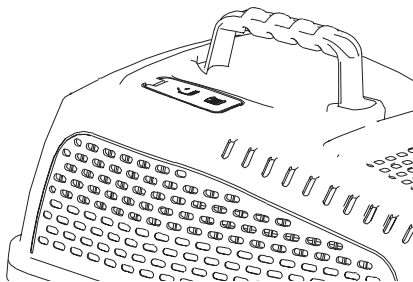

NOTE! A full grass collection box will reduce the performance of this product.

1. Lift the safety rear flap and lift the grass collection box off the hooks.
2. Remove the grass clippings from the discharge chute into the grass collector. Use a proper tool such as a brush.
3. Remove the grass collection box.
4. Empty the grass clippings onto a compost heap.
5. Re-fit the grass collection box on to the hooks.

Switching on/off

1. Ensure the switch lever is released.
2. Press the lock-off button(1). (See Fig N)
3. Pull the switch lever (2) towards the handle and hold in position. (See Fig N)

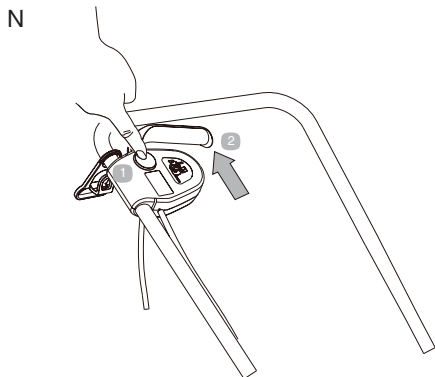

4. Release the lock-off button once the product is running.
5. Release the switch lever to switch the product off. (See Fig O)

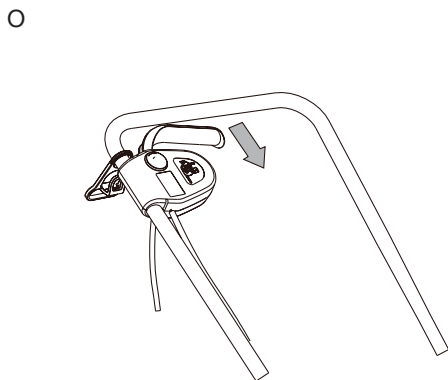

NOTE! The product can only be started by pressing the lockoff button first, followed by squeezing the start lever. Reverse operation will not start the product.

NOTE! The cutting device will continue to rotate for a short period after the product has been switched off.

Mowing

1. Never cut off more than one-third of the total length of the grass for a healthy lawn. In the autumn, lawns should only be cut as long as there is growth.
2. Slowly push the product forward.
3. Mow in slightly overlapping rows. The most effective pattern for mowing lawns is straight lines along one of the sides. This will keep the rows even and ensures that all the lawn is cut without missing any spots. (SEE FIG P)

P

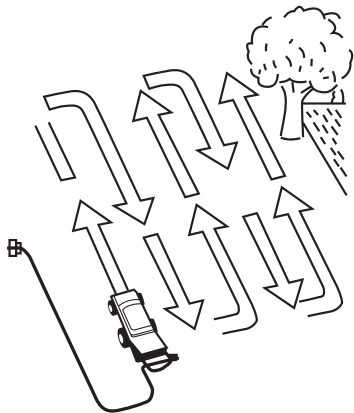

4. Circle around flower beds. When reaching a flower bed in the middle of the lawn, cut a width or two around the circumference of the bed.
5. Pay special attention when changing direction.



WARNING!

If the product strikes a foreign object, stop the motor immediately. Switch the product off, disconnect it from the power supply and let it cool down. Inspect the product thoroughly for damage. Have any damage repaired by a suitably qualified person before restarting.

Excessive vibration of the product during operation is an indication of damage. Stop the motor, unplug and check for damage.

CARE AND CLEANING

Maintenance

1. Always switch the product off, disconnect it from the power supply and let the product cool down before performing any inspection, maintenance or cleaning work!
2. Keep the product clean. Remove debris from it after each use and before storage.
3. Regular and thorough cleaning will help ensure safe use and prolong the life of the product.
4. Inspect the product before each use for worn or damaged parts. Do not operate if you find loose or broken or worn parts.



WARNING!

Only perform repairs and maintenance work according to these instructions. All further work must be performed by a qualified specialist.

Maintenance after each use

1. Clean the product with a dry cloth. Use a brush for areas that are hard to reach.
2. Clean the air vents after every use with a cloth and brush.
3. Remove stubborn dust with high pressure air (max. 3 bar).
4. Check for any damage or wear. Repair damage in accordance with this instruction manual or take the lawnmower to an authorised service centre before the next use.

NOTE! Do not use chemicals, alkaline, abrasive or other aggressive detergents or disinfectants to clean this product as they may cause damage to the cosmetic surfaces.

Do not spray the unit with water.

Water may destroy the switch unit and the electric motor.

Spare parts/Replacement parts

The following parts of this product may be replaced by the consumer. Spare parts are available at an authorised dealer or through our customer service centre.

Description Model no. or Specification

Wing nut knobs	1466ZE0019
Set straw basket	1466ZE0013
Cutting device (blade)	1466ZE0051

Underbody and cutting device

1. Keep the underbody and cutting device clean and free of debris.
2. Check all nuts and bolts periodically to ensure they are tight.

After prolonged use, especially in sandy soil conditions, the cutting device will become worn and lose some of its original shape. The cutting efficiency will be reduced and the cutting device should be replaced.
3. Keep the cutting device sharp to ensure the best cutting performance. Replace a worn or damaged cutting device with a new one of the same type.

Replacing the blades

Always unplug the lawnmower before removing or refitting the blades.

Always wear gardening gloves when handling or working near sharp blades.

1. Loosen the bolt, turning it anticlockwise using a suitable wrench and remove it together with the cutting device (See Fig Q).

Q

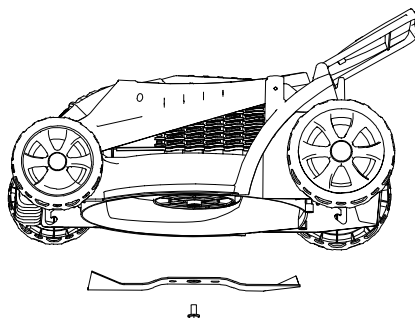

2. Replace the cutting device with a new one of the same type.
3. Reattach the cutting device onto the spindle, pay attention to the correct alignment. Tighten the bolt clockwise with 16 Nm min - 20 Nm max. to ensure the safe operation of your product.
4. Replace the cutting device after 50 hours of mowing or 2 years whichever comes first, regardless of condition. If the cutting device is cracked or damaged, immediately replace it with a new one.
5. Lubricate the cutting device after each use to prolong the lifespan of the cutting device and product. Apply light machine oil along the edge of the cutting device.

Repair

This product does not contain any parts that can be repaired by the consumer other than those covered in the Maintenance section. Contact an authorised service centre or a similarly qualified person to have it checked and repaired.

Power cord

If the supply cord is damaged, it must be replaced by the manufacturer, its service agent or similarly qualified persons in order to avoid a hazard.

Transportation

1. Switch the product off and disconnect from the power supply before transporting.
2. Adjust the cutting height to the highest position as described above.
3. Attach transportation guards, if applicable.
4. Always transport the product by its handle. When lifting the product use the transportation handle as an aid.
5. Protect the product from any heavy impact or strong vibrations which may occur during transportation in vehicles.
6. Secure the product to prevent it from slipping or falling over.

Cleaning

Before cleaning, inspecting or repairing your unit, make sure that the motor has stopped and has had time to cool. Disconnect the plug to prevent accidental starting.

Note! To ensure the best performance of your lawnmower, it is important to keep it clean. Always clean your lawnmower immediately after use.

Do not allow grass cuttings and other debris to become dry and hard on any of the mower surfaces. This will directly affect the cutting performance. Make sure that the underside of the lawnmower deck is clean and clear. Never clean the lawnmower with a water jet or high pressure cleaner. The motor must remain dry. Do not use aggressive cleaning agents including petroleum.

The lawnmower should be thoroughly cleaned after each use, especially the underside. To do so, tip the lawnmower onto its left side. Dirt and grass is easiest to remove immediately after you have finished mowing the grass.

Storage

1. Clean the product as described above.
2. Store the product and its accessories in a dry, frost-free place.
3. Store the product in a place that is inaccessible to children.
The ideal storage temperature is between 10°C and 30°C.
4. We recommend using the original packaging for storage or covering the product with a suitable cloth or enclosure to protect it against dust.
5. Fold the upper handle and fix it in position as described above.

TROUBLE SHOOTING

Suspected malfunctions are often due to causes that the user can fix themselves.

Therefore check the product using this section. In most cases the problem can be solved quickly.



WARNING!

Only perform the steps described within these instructions! All further inspection, maintenance and repair work must be performed by an authorised service centre or a similarly qualified specialist if you cannot solve the problem yourself!

Fault	Possible Cause	Troubleshooting
Product does not start	<ul style="list-style-type: none"> - Not connected to power supply - Power cord or plug is defective - Other electrical defect - Lock-off button not pressed - Blown fuse 	<ul style="list-style-type: none"> - Connect to power supply - Contact customer service centre - Contact customer service centre - Press the lock-off button first, then the start lever - Replace with 13 AMP fuse approved to BS1362
Product does not reach full power	<ul style="list-style-type: none"> - Extension cord not suitable for operation with this product - Power source (e.g. generator) has too low a voltage - Air vents are blocked 	<ul style="list-style-type: none"> - Use a suitable extension cord - Connect to another power source - Clean the air vents
Unsatisfactory result	<ul style="list-style-type: none"> - Cutting device is worn - Cutting material exceeds capacity - Cutting height is incorrect 	<ul style="list-style-type: none"> - Replace with a new one - Only cut materials according to the capacity of the product - Adjust the cutting height

DECLARATION OF CONFORMITY / PERFORMANCE



Product Code: 62767/SLM32F-ZE

Product Description: Hawksmoor 1200W 32cm Electric Lawnmower

1. Toolstation Limited, Express Park, Bristol Road, Bridgwater, Somerset TA6 4RN

This declaration of conformity is issued under the sole responsibility of Toolstation

2. Object of the declaration

The object of the declaration described above is in conformity with the relevant Community harmonization legislation:

Supply of Machinery (Safety) Regulations 2008

2006/42/EC

Electromagnetic Compatibility Regulations 2016

2014/30/EU

Electrical Equipment (Safety) Regulations 2016

2014/35/EU

The Restriction of the Use of Certain Hazardous Substances in Electrical and Electronic Equipment Regulations 2012

2011/65/EU&(EU)2015/863

Noise Emission in the Environment by Equipment for use Outdoors Regulations 2001

2000/14/EC amended by 2005/88/EC

- Conformity assessment Procedure as per	Annex VI
- Measured Sound Power Level	93.7 dB(A)
- Declared Guaranteed Sound Power Level	96 dB(A)

3. References to the relevant standards used (or references to the specifications in relation to which conformity is declared:

BS EN 60335-1, BS EN 60335-2-77, BS EN 62233, BS EN ISO 3744, BS EN 55014-1

BS EN 55014-2, BS EN 61000-3-2, BS EN 61000-3-3

4. Additional information:

Signed for and on behalf of Toolstation Limited

ENVIRONMENTAL INFORMATION



The symbol on the product or its packaging indicates that this product must not be disposed of with your other household waste. Instead, it is your responsibility to dispose of your waste equipment by handing it over to a designated collection point for the recycling of waste electrical and electronic equipment. The separate collection and recycling of your waste equipment at the time of disposal will help conserve natural resources and ensure that it is recycled in a manner that protects human health and the environment. For more information about where you can drop off your waste for recycling, please contact your local authority, or where you purchased your product.

GUARANTEE

Toolstation products deliver reliable service for normal, household use in domestic settings. All Toolstation products are individually tested before leaving the factory.

If you are a consumer and you experience a problem with your Toolstation product, which is found to be defective due to faulty materials or workmanship within the Guarantee Period, this Toolstation Guarantee will cover repair or - at the discretion of Toolstation - replacement with a functionally equivalent Toolstation product.

Your product is under guarantee for 2 year from the date of purchase or the date of delivery of the product, if later.

The guarantee is subject to the following provisions:

- The guarantee does not cover accidental damage, misuse, cabinet parts, knobs, or consumable items.
- The product must be correctly installed and operated in accordance with the instructions contained in this manual.
- It must be used solely for domestic purpose.
- The guarantee will be retendered invalid if the product is re-sold or has been damaged by inexpert repair.
- Specifications are subject to change without notice.
- The manufacturer disclaims any liability for the incidental or consequential damages.
- The guarantee is in addition to, and does not diminish your statutory or legal rights.

CUSTOMER SUPPORT

www.coreservice.co.uk

Call us +44 01904 947568

Email: support@coreservice.co.uk

Made in China