

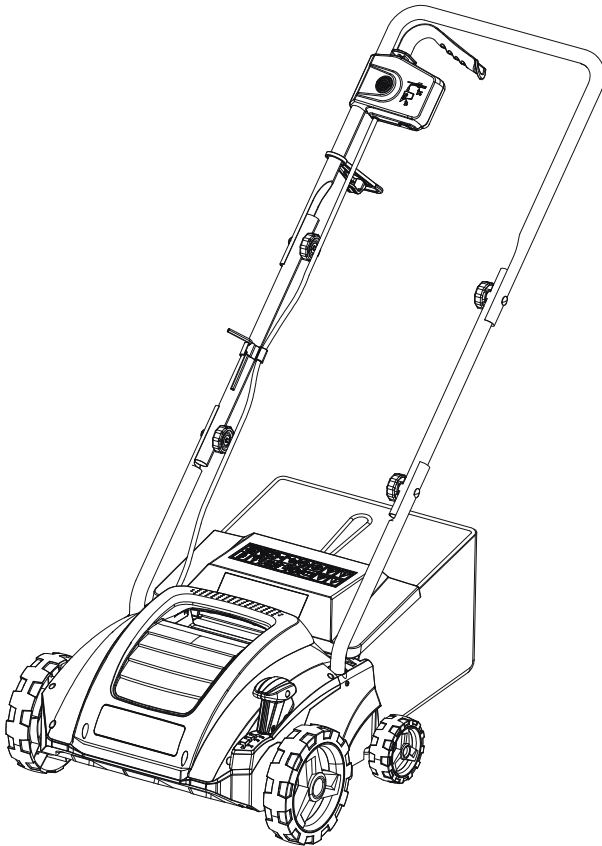

Original User's Instructions

## 2 in 1 Electric Raker and Scarifier

SKU: 24959



**READ BEFORE USE**

**PLEASE KEEP THESE INSTRUCTIONS FOR FURTHER REFERENCE**

## CONTENT

• WHAT'S IN THE BOX -----	3
• TOOLS REQUIRED -----	4
• SPECIFICATIONS -----	4
• EXPLANATIONS AND SYMBOLS, CAUTIONS AND WARNINGS -----	6
• IMPORTANT SAFETY WARNINGS -----	8
• PRODUCT DESCRIPTION AND IDENTIFICATIONS -----	17
• ASSEMBLY AND OPERATING INSTRUCTIONS -----	18
• CARE AND CLEANING -----	26
• TROUBLE SHOOTING -----	28
• DECLARATION OF CONFORMITY / PERFORMANCE -----	29
• ENVIRONMENTAL INFORMATION -----	30
• GUARANTEE -----	31
• CUSTOMER SUPPORT -----	31

# WHAT'S IN THE BOX

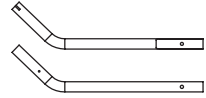
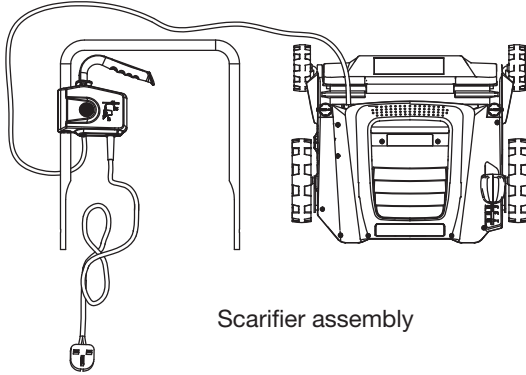

Lower handle x 2

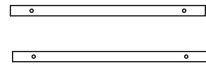

Middle handle x 2

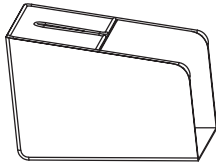

Collection box

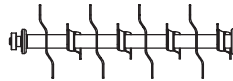

Scarifier roller



Raking roller



Nut x 4



Screw x 4



Cord strain relief



Allen key



Cord clip

If you do not have all these items, please contact:  
[www.coreservice.co.uk](http://www.coreservice.co.uk)  
Hotline: +44 01904 947568  
Email [support@coreservice.co.uk](mailto:support@coreservice.co.uk)

## TOOLS REQUIRED



Screwdriver

## SPECIFICATION

Technical Data	
Model	WR6005-1500
Input voltage rating	230-240V~,50Hz
Input power	1500 W
No load speed	3000/min
Max. cutting width	320mm
Working height adjustment(scarifying)	-12, -8, -4, +4 mm
Working height adjustment(raking)	-3, 1, 5, 13
Collection box volume	30L
Water protection class	IPX4
Net weight (approx.)	9.9 kgs
Insulation protection class	II
Sound values	
Sound pressure level $L_{pA}$	83,9dB(A) K=3dB (A)
Sound power level $L_{WA}$	96,73dB(A) K=1,11 dB (A)
Guaranteed sound power level $L_{WA}$	98 dB(A)
Vibration values	
Hand arm vibration $a_h$	4,246 m/s <sup>2</sup> K=1,5 m/s <sup>2</sup>
Cable	H05VV-F, 2x1.0mm <sup>2</sup> , 10m, BS plug

The declared vibration value has been measured in accordance with a standard test method and may be used for comparing one tool with another. The declared vibration value may also be used in a preliminary assessment of exposure.



**WARNING!** The vibration emission value during actual use of the tool can differ from the declared value depending on the ways in which the tool is used. Identify safety measures to protect the operator that are based on an estimation of exposure in the actual conditions of use (taking account of all parts of the operating cycle such as the times when the tool is switched off and when it is running idle in addition to the trigger time). Depending on the actual use of the product the vibration values can differ from the declared values! Adopt proper measures to protect yourself against vibration exposures! Take the whole work process including times the product is running under no load or switches off into consideration! Proper measures include among others regular maintenance and care of the product and application tools, keeping hands warm, periodical breaks and proper planning of work processes!

The sound intensity level for the operator may exceed 80dB(A) and ear protection measures are necessary.

## EXPLANATIONS AND SYMBOLS, CAUTIONS AND WARNINGS



Warning



The product complies with the applicable European directives and an evaluation method of conformity for these directives was carried out.



UK Conformity Assessed



Wear eye and ear protection devices when operating this device



Wear respiratory protection.



Wear protective gloves.



Wear protective gloves.



Wear protective gloves.



SWITCH OFF! Remove plug from the mains immediately if the cable is damaged or cut.



Switch the product off and disconnect it from the power supply before assembly, cleaning, adjustments, maintenance, storage and transportation.



Read the instruction manual



Objects thrown by the product could hit the user or other bystanders. Always ensure that other people and pets remain at a safe distance from the product when it is in operation.



Inspect the area where the product is to be used and remove all objects which could be thrown by the product. If objects are hidden while operating stop the motor and remove them.



Protection class II. Double insulation



Cutting device continues to rotate after the product is switched off. Wait until all components have completely stopped before touching the product.



Keep supply cord away from the cutting device.



Beware of sharp tines. Tines continue to rotate after the motor is switched Off. Switch off! Remove plug from mains before cleaning or maintenance. Remove plug from the mains immediately if the cable is damaged or cut



Guaranteed sound power level



Waste electrical products should not be disposed of with household waste, please recycle where facilities exist. Check with your local authority or retailer for recycling advice.



**IPX4**

Water protection class



To avoid potential electric shock, do not use the unit in humid or wet conditions

## IMPORTANT SAFETY WARNINGS



### **WARNING - Read all safety instructions!**

Failure to observe the safety instructions may result in electric shock, burns and/or severe injury.

#### **Keep the safety instructions for future reference.**

- This device is not intended to be used by persons (incl. children) with limited physical, sensory or mental abilities or with a lack of experience and/or knowledge unless they are supervised by a person responsible for their safety or were instructed on the proper use of the device by that person.
- Children should be under supervision to ensure that they do not play with the device.

### **Technical safety**

#### **Notes**

- a) Read the Operating Instructions carefully. Make sure to be thoroughly familiar with the controls and proper use of the tool.

#### **Preparation**

- a) Never allow children or other persons that are not familiar with the Operating Instructions to use the tool. The minimum age for operating the tool may be determined by local regulations.
- b) Do not operate the tool while other persons - especially children - or animals are nearby
- c) Keep in mind that the operator of the tool is liable for accidents or risks that may occur to other persons or their property
- d) Wear ear and eye protection while operating the tool.



- e) Always wear sturdy footwear and long trousers when operating the tool. Do not operate the tool with bare feet or open sandals.
- f) Check the area, in which you are going to operate the tool, and remove all stones, sticks, wires, bones and other objects that may get caught and hurled away.
- g) Visually inspect the work tools and bolts for signs of wear and tear or damages each time before you start using the tool. To avoid imbalances worn-out or damaged work tools and/or bolts may only be replaced in sets.
- h) If tools with ejection openings pointing to the backside and uncovered rear rollers without collection or protection devices full eye protection (safety goggles) must be worn.

## **Handling**

- a) Operate the tool in daylight or good artificial lighting only.
- b) If possible avoid to use the tool with wet grass or apply particular care to avoid slipping.
- c) Make sure to have a safe stand when working on inclines.
- d) Move the tool at walking speed only
- e) Always work in a perpendicular position/direction to the slope. Never work in upward or downward direction!
- f) Take particular care when changing the working direction on the slope.
- g) Do not work on extremely steep slopes.
- h) Take particular care when turning the tool around or pulling it towards yourself.
- i) Stop the work tools if the tool must be tilted for transport purposes. Stop the work tools if areas other than grass patches must be crossed and whenever the tool is moved to and from the area to be worked.
- j) Do not use the tool with damaged or no safety devices installed, e.g., without baffle plates and/or collection devices.

- k) Do not change the motor settings and do not overrev the motor.
- l) Disengage ('declutch') all work tools and drives prior to starting the motor.
- m) Start the tool with due care in accordance with the manufacturer's instructions. Make sure to keep a safe distance between your feet and the work tools.
- n) The tool must never be tilted when starting the motor unless the tool must be lifted off the ground to be started. If this should be the case only tilt the tool as far as necessary and only lift the side pointing away from the operator off the ground.
- o) Do not start the moto while standing in front of the ejection chute.
- p) Never reach under or touch rotating parts with your hands or feet. Keep away from the ejection opening.
- q) Never lift or carry a tool with the motor running.
- r) Switch off the motor and pull the mains plug in the following cases:
  - before removing blockages or obstructions in the ejection chute.
  - before inspecting or cleaning the tool or before performing any works on it.
  - if an object got caught or hit. Check the tool for damages and perform the required repairs before you restart and continue working with the tool.
  - if the tool starts to vibrate abnormally (inspect immediately!)
- s) Switch off the motor and pull the mains plug whenever you leave the tool alone.

## **Maintenance and storage**

- a) Make sure that all nuts, bolts and screws are firmly tightened to ensure the tool's safe working condition.

- b) Let the engine cool down before you store the tool in a closed room.
- c) Regularly check the collecting device for signs of wear and tear or damaged parts.
- d) Inspect the tool regularly and replace worn out or damaged parts for reasons of safety.

### **Safety instructions for lawn scarifier and rakes**

- a) Check the mains and extensions cables for signs of damage or ageing before use. Do not use a device with defective cables.
- b) Pull the mains plug in case the cable gets damaged during use. Do not touch the cable under any circumstances!
- c) Visually inspect the cutting unit for signs of wear and tear or damages each time before you start using the device. If the device starts to vibrate abnormally it is required to inspect it immediately!
- d) Do not unnecessarily tilt the device when starting the motor. Only tilt the device as far as necessary and only lift the side pointing away from the operator off the ground. Make sure to hold the device with both hands in working position before you put it back on the ground.
- e) Safety devices must be replaced by our aftersales service only.

### **Warnings**

- a) Warning! The device is not intended for use by children.
- b) Do not use the lawn scarifier (lawn rake) if the cables are damaged or worn.
- c) Do not connect a damaged cable to the mains supply and do not touch a damaged cable as long as it is connected to the mains supply. A damaged cable may lead to the contact with active parts.

- d) Do not touch the tines unless the device's power supply has been disconnected and the tines fully stopped moving.
- e) Keep extension cords away from the tines. A damaged cable may come into contact with active parts (hazard of electric shock).
- f) Disconnect the power supply (e.g., pull the plug from the mains socket) in the following cases:
  - every time you leave the device unattended;
  - before removing blockages/obstructions of the tool;
  - before inspecting, cleaning or performing any other works on the device;
  - after an object got caught or hit.
- g) Thoroughly read the safe operation rules of the device

### **Recommendation**

Only connect the device to a power source that is protected via a residual current protective device (RCD) with a maximum release current of 30 mA. Avoid using the machine in bad weather conditions especially when there is a risk of lightning.



The use of an RCD or other circuit breaker unit does not release the operator of your machine from the safety instructions and safe working practices given in this manual.

### **Additional safety instructions for lawn scarifier and rakes**

- The device is intended for private use only. It must not be used in public gardens, parks, sports facilities, grass verges, and professional agriculture and forestry.

- A feeling of tingling or numbness in the hands is an indicator for excessive vibration. Limit operating times, make sufficiently long work breaks, distribute the work with the device among several persons, or wear anti-vibration protection gloves when working with the device for longer periods of time.
- When working with the device, a certain level of noise cannot be avoided. Noisy work should be scheduled for hours, during which it is allowed by statute or other local regulations. Adhere to any applicable rest times and limit your working time to the necessary minimum time. For your personal protection and the protection of people nearby, suitable hearing protection must be worn.
- Do not get distracted and always concentrate on what you are doing. Use common sense. Never operate the tool when you are tired, sick or under the influence of alcohol or other drugs.

### **Additional general safety instructions**

- Do not handle the plug or the tool with wet hands and do not use the tool in the rain.
- Use only outdoor rated extension leads that are so marked. Keep the extension cord away from heat, oil and sharp edges.
- Use a face mask if dusty.
- Keep clear of discharge openings at all times.
- Do not use solvents or cleaning liquids to clean your machine - use a blunt scraper to remove grass and dirt. Always disconnect from the electrical supply before cleaning.
- Keep your working area clean and tidy. Untidy and poorly lit working areas may lead to accidents.
- Do not operate the tool in potentially explosive environments containing combustible fluids, gases or dusts.

- Store power tools out of the reach of children. Do not allow persons to use the tool if they are not familiar with the tool or these instructions.
- Do not overtax the power tool. Use the power tool intended for your type of work in each case.
- Do not use the cable to carry or hang up the tool or to pull the plug out of the socket. Keep the cable away from heat, oil and sharp edges or moving parts of the tool. Damaged or tangled cables increase the risk of electric shock.
- Do not overestimate your abilities. Take care of a safe feeling and keep your balance at all times.
- Remove adjustment tools or wrenches and the like before you switch the tool on.
- Avoid unintentional operation. Make sure that the switch is in 'OFF' position before pulling the plug from the mains socket. When carrying the tool with your finger on the on/off switch or connecting the tool to the mains supply with the switch in 'ON' position, this may result in accidents.
- Always pay attention to what you do and apply reasonable care when working with a power tool. Do not use the tool when you are tired or under the influence of medication, drugs or alcohol.
- Thoroughly maintain your power tool. Check whether moving parts are working properly and are not jamming/slicking, and whether parts are broken or otherwise damaged in a way that affects the function of the tool. Have damaged parts repaired before using the tool.
- Use power tools, accessories, add-on tools, etc. in accordance with these instructions and in the way prescribed for the respective type of tool. You should also consider the working conditions and the work to be carried out.
- Have the power tool serviced by qualified technical personnel only; repairs should be carried out using exclusively original spare parts.

- Replace worn or damaged parts for reasons of safety. Use only original spare parts. Parts not produced by the original manufacturer may have a poor fit and possibly cause injury.
- Grip guide bar firmly with both hands. Never operate the tool with only one hand.
- Hold the guide bar and lift the tool to move it from one place to another. Always switch off the tool, disconnect the plug and wait until the application stops before carrying out maintenance.

### **Electrical safety**

- The electric motor has been designed to use single phase voltage only.
- Make sure your voltage corresponds to the one written on the rating label.
- Always use a plug compulsory for double insulation electric tooling when replacing the cable.
- Always switch your machine off before disconnecting any plug, socket or extension.
- Use only extension cords that are approved for out-door use and are not lighter than rubber sheathed cables of type HO7 RN-F with a diameter of at least 1.5 sq. mm. Their cords must be splash-proof.

### **Replacing the power cable**

If the power cable of the device should be damaged it must be replaced by the manufacturer or their after-sales service or an equally qualified person to avoid any risks.

## **WARNING!**

The prolonged utilization of a tool will subject the user to vibration and shocks that could lead to Raynaud's syndrome or Carpal tunnel syndrome. This condition reduces the ability of the hand to sense and regulate temperature, causes numbness and a sensation of heat and can lead to damage to the nervous system and the circulatory system and to necrosis.

Not all factors that lead to Raynaud's syndrome are known but cold water, smoking and illnesses that impact the blood vessels and the circulatory system as well as severe or long-lasting exposure to vibrations are known to be factors in the development of Raynaud's syndrome. Observe the following in order to reduce the risk of Raynaud's syndrome and Carpal tunnel syndrome:

- Wear gloves and keep your hands warm.
- Make sure the device is well maintained. A tool with loose components or with damaged or worn-out dampers will have a disposition towards increased vibrations.
- Always hold the handle firmly but do not clutch it constantly with excessive force. Take breaks often.

**All of the above precautions cannot exclude the risk of Raynaud's syndrome or Carpal tunnel syndrome. Therefore, with long-term or regular use it is advisable to keep a close watch on the condition of your hands and fingers. Seek medical attention immediately in the event of any of the above symptoms appearing.**

**WARNING!** This product produces an electromagnetic field during operation!

This field may under some circumstances interfere with active or passive medical implants! To reduce the risk of serious or fatal injury, we recommend persons with medical implants to consult their doctor and the medical implant manufacturer before operating this product!



## PRODUCT DESCRIPTION AND IDENTIFICATIONS

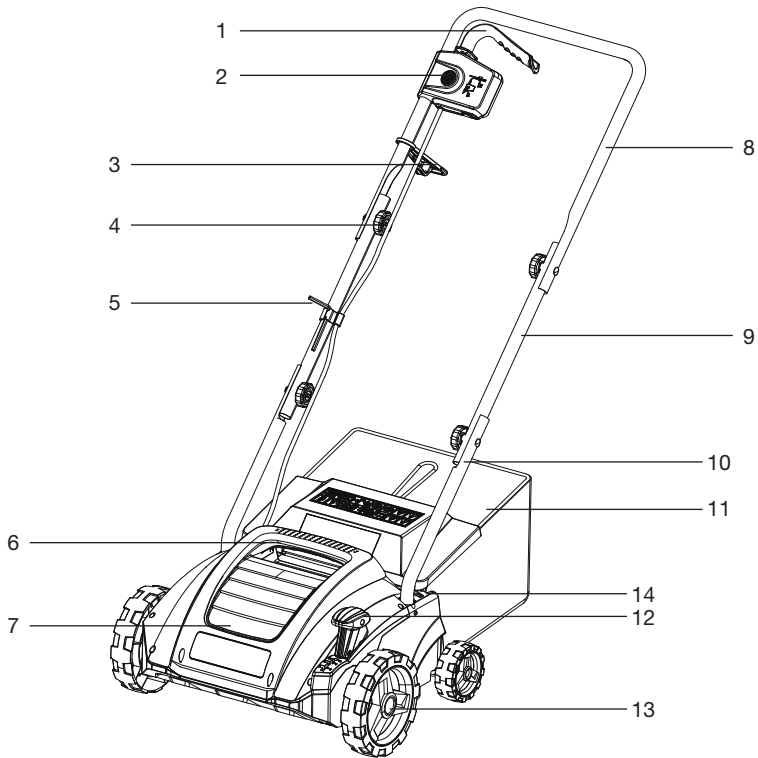

- |   |                             |    |                                 |
|---|-----------------------------|----|---------------------------------|
| 1 | Start/stop lever            | 8  | Upper handle                    |
| 2 | Lock-off button             | 9  | Middle handle                   |
| 3 | Cord strain relief          | 10 | Lower handle                    |
| 4 | Mounting set for handle bar | 11 | Collection box                  |
| 5 | Cord clip with Allen key    | 12 | Working height adjustment lever |
| 6 | Handle                      | 13 | Wheel                           |
| 7 | Scarifier deck              | 14 | Discharge opening               |

**Not all the accessories illustrated or described are included in standard delivery.**

## ASSEMBLY AND OPERATING INSTRUCTIONS

### Assembling the handle (figs. 1, 2 and 3)

- Slide the two bottom handle parts (1 c) into the locating holes in the housing until they reach the stops (fig. 1). Make sure the holes in the lower handle face outwards for screw fixing.

fig. 1

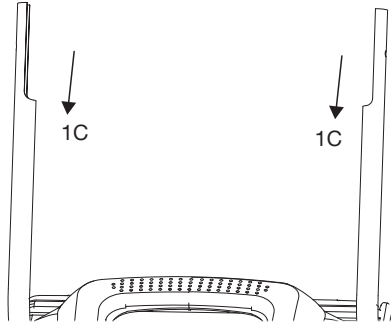

- Fasten the handles with the 2 self-tapping screws (9) (fig. 2).

fig. 2

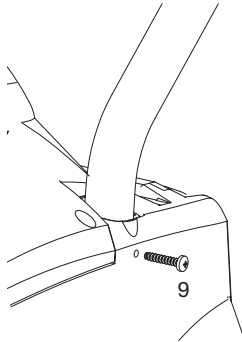

- Align the middle handle bars(1b) to the lower ones (1c). Make sure the holes of the handle bars correspond and secure them with handle assembly mounting set ( bolts-4a and locking knobs-4b) on each side, make sure the locking knob is located inside. (fig.3 &4).

fig. 3

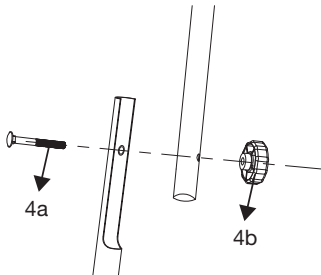

- Slide the cord strain relief(3) onto the upper handle bar ( the side of handle with switch) before assembly. Align the upper handle bar with the middle handle bar and secure them with handle assembly mounting set with locking knobs located inside on each side. (fig. 4)

fig. 4

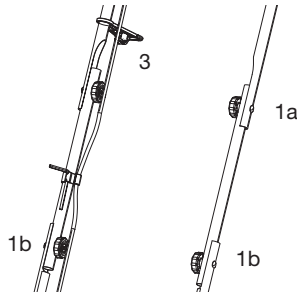

- Assemble the cord clip with cord and allen key as a storage (fig. 5)

fig. 5

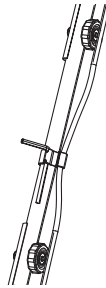

### Assembling the collection box (fig. 6)

- First attach the 5 plastic clips onto the metal frame of the grass collection box. (fig.6)

fig. 6

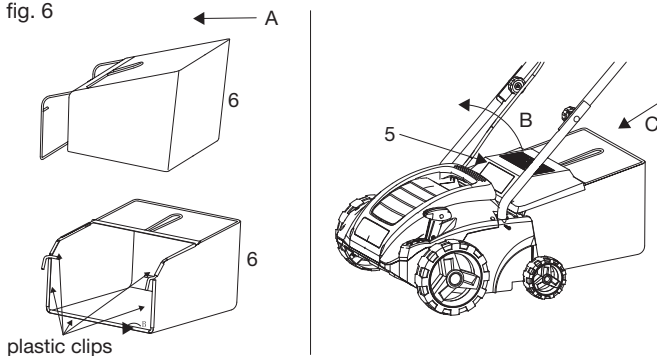

- Lift up the protective cover (5).
- Hang the grass collecting box in place by hooking the 2 hooks into the corresponding holes on the discharge opening (14).

**Note:** If you do not wish to collect the grass, the machine can also be operated without the collecting box. In this case the protective cover (5) folds downwards.

### Adjusting the height of the wheels (fig. 7)

- Use the adjustment lever (7) of the machine body for adjusting height of wheels to select the height for working.
- Pull the adjustment lever (7) away to move it along the slot.
- Move the lever forward or backward to the desired position, and release.
- Release the lever and make sure it is well seated in the slot on the housing.

fig. 7

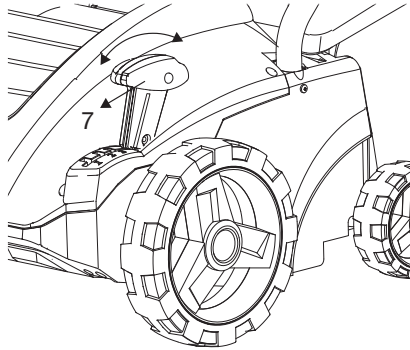

### Changing the working rollers



Danger! The roller can cause injuries. Wear work gloves

Before starting work, pull the mains plug out of the outlet and wait until the roller has come to a standstill.

The machine is already fitted with a scarifying blade.

### For scarifying

Correct cutting blade fitted already thus no need for extra installation.

### For raking

- Use an Allen key to replace the working roller.
- Turn the machine over and loosen the two screws (A) on the bearing shell (C) (fig. 8).
- Lift the roller on the bearing side and pull it out of the drive (B) (fig. 8).

fig. 8

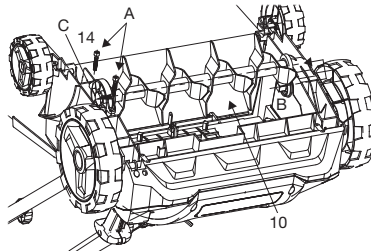

- Lift the complete roller upwards out of the machine
- Pull the bearing shell (C) (fig. 8) off the roller. Fit the bearing shell (C) to the new work roller (fig. 9)
- Slide the square drive bushing of the new roller onto the drive axle (B) of the machine (fig. 9)

fig. 9

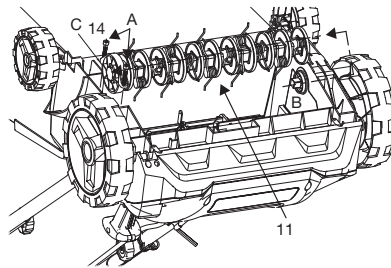

- Fit the other end of the work roller with the bearing shell (C) into the corresponding mount on the machine
- Fasten the roller with the two screws (A) and tighten these with the Allen key (fig. 9). Then turn the machine back over again

## OPERATING INSTRUCTIONS



Always keep to instructions on safety and current rules and regulations.

## HINTS AND SUGGESTIONS

### How to use the scarifier (using scarifying roller 10)

- By scarifying you remove the hardened surface, grass felt and flat-growing weeds and the crusted over grassroots are loosened up. The lawn will start to breathe again and assimilate the nourishing substances, oxygen and water. This also prevents the establishing of bacteria in the lawn felt during the wintertime.
- Cut the grass to a height of about 40 mm before scarifying. The lawn must be dry when using the machine. The best time for a scarifying is any time during the vegetative season, from end April through to September. Scarify it at least once a year. We recommend using a fertilizer straight after airing if you want a green carpet.

### How to use the raker (using rake roller 11)

- By raking you remove the dead matter, moss and weed which disfigures a lawn. The build up of dead grass provides a mat of absorbent fibres which prevents water gelling through to the ground
- Do not force your rake through grass that is longer than 75mm. The lawn must be dry when using the machine. It's recommended that your raker is used at the beginning and the end of each grass cutting season to give your lawn a thorough raking. Your raker should also be used after each mowing to remove any grass culling that may be left by your mower.

## Switching On / Off (Fig. 10 and 11)

fig. 10

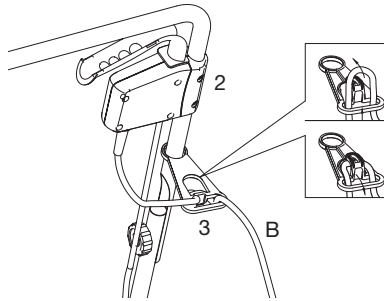

- This machine is provided with an electric safety switch against accidental starts. Push the safety lock-off button (2a) on the switchbox, then pull the switch lever (2b) towards the handle (Fig. 11). After the tool has been switched on, you do not have to hold the switchon lock (2a) any longer.

fig. 11

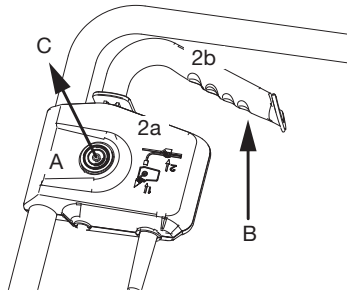

- The top handle is equipped with a cord strain relief (3) which holds the cable.



### **Danger!**

**After motor has been switched off, the roller continues to rotate for a few seconds - therefore, do not put your hands under the appliance straight away.**

## GENERAL OPERATION



**WARNING!** In some countries regulations define at what time of the day and on what special days products are allowed to be used and what restrictions apply!

Ask your community for detailed information and observe the regulations in order to preserve a peaceful neighborhood and avoid committing administrative offences!



**WARNING!** If the product strikes a foreign object stop the motor! Switch the product off, disconnect it from the power supply and let it cool down. Inspect the product thoroughly for damage! Have any damage repaired before restarting!



**WARNING!** Extensive vibration of the product during operation is an indication of damage! The product should be promptly inspected and repaired!

1. Check the product, its power cord and plug as well as accessories for damage before each use. Do not use the product if it is damaged or shows wear
2. Double check that accessories are properly fixed.
3. Push the product forward by its handle. Keep the handle dry to ensure safe support.
4. Ensure that the air vents are always unobstructed and clear. Clean them if necessary with a soft brush Blocked air vents may lead to overheating and damage the product.
5. Switch the product off immediately if you are disturbed while working by other people entering the working area. Always let the product come to complete stop before putting it down.
6. Do not overwork yourself. Take regular breaks to ensure you can concentrate on the work and have full control over the product.
7. Mow the lawn before working and fertilise afterwards
8. Make sure that the lawn is clear of stones, sticks, wire or other objects that could damage the product or its motor.
9. Select the suitable cutting depth for the actual grass height.
10. Do not work with this product on a wet lawn because it tends to stick to the underbody of the product, preventing the proper discharge of collected material, and it could also cause you to slip and fall.
11. Slowly push the product forward. Move the product at appropriate speed. Do not move it too fast to prevent the discharge opening from getting blocked and engine from useless overloading.
12. Work in slight overlapping rows. The most effective pattern for scarifying/raking lawns is straight lines along one of the sides. This will keep the rows even and ensures that all the lawn is scarified/raked without missing any spots.
13. Circle around flower beds. When reaching a flower bed in the middle of the lawn, make a row or two around the circumference of the bed
14. Pay special attention when changing direction.
15. Never tilt or transport appliance with running motor
16. Never leave the appliance unattended.
17. When leaving, disconnect the appliance from the power supply.

### Checking by an expert is necessary

- after hitting an obstacle
- if the motor comes to an immediate standstill
- if the blades of the scarifier roller are bent
- if the toothed belt is defective
- if the wire leading to the motor is damaged
- if there are other damages

### GENERAL OPERATION (Fig. 12)

We recommend the directional method of operation obtain the maximum cutting performance from your unit and to reduce the risk of the trailing the extension lead from entering the cutting path.

- Place the bulk of the supply cable on the lawn close to the starting point (position 1, Fig. 12)
- Hold the handle assembly with both hands

fig. 12

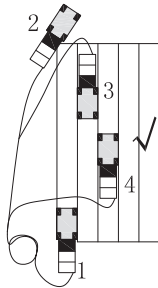

**WARNING:** Do not attempt to operate your machine with one hand - you must guide it with both hands. Do not operate your machine on sanded, concrete or wooden ground.

- Tilt the handle downwards to slightly raise the front of your unit and to reduce the risk of lawn damage while starting, depress the safety lock-off button (2a) on the switchbox and while still depressed pull the switch lever (2b) towards you. Your machine will start and you can now allow the lock-off button (2a) to be released and lower your Machine to its proper cutting position, and commence cutting



- Proceed down the cutting area as shown in Fig. 12, working from position 1 towards position 2 and, on reaching position 2, turn to the right and proceed towards position 3. Always working away from the cable. Do not adopt the method as shown in Fig. 13, working towards the cable, as this is dangerous practice

fig. 13

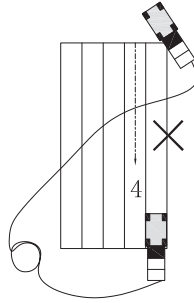

### SETTING THE WORKING DEPTH

The working depth is adjustable to 4 heights referring to below table. Pull adjustment lever (7) away from one position and move to catch in desired position.

POSITION	SCARIFIER	RAKER
1	-12 mm	-3 mm
2	-8 mm	1 mm
3	-4 mm	5 mm
4	4 mm	13 mm

## CARE AND CLEANING



### WARNING!

Before carrying out any repairs or servicing work, you must ensure that the product has been disconnected from the power supply. Repairs and maintenance work other than described within this instruction manual may be performed only by qualified specialist!

To ensure long and reliable service, carry out the following maintenance regularly. Servicing and cleaning work on the product and the removal of the guards may only be carried out after the motor has been switched off and the plug disconnected from the power supply.

1. Regularly check for obvious defects such as loose, dislodged or damaged chain and guide bar, loose fixings and worn or damaged components
2. Check that covers and guards are undamaged and correctly fitted. Carry out necessary maintenance or repairs before using the product
3. If the cutting device should happen to fail despite the care taken in manufacturing and testing, repair should be carried out by an authorized specialist
4. Do not clean the product while it is running
5. Ensure that all the fastening elements (screws, nuts, etc.) are tight at all times so that you can safely work with the product.
6. Check the product frequently for signs of wear. Replace worn or damaged parts.
7. Store your product in a dry place. To ensure a long service life all screw parts should be cleaned and then oiled.
8. Clean the product with a brush or cloth. Do not use any solvents or water to remove dirt.
9. The component that is subject to most wear is the cutting device. You should therefore check the condition of the cutting device and its mounting at regular intervals.
  - If the cutting device is worn or blunt it must be replaced immediately;
  - If the product starts to suffer from excessive vibrations, this means that the cutting device has not been balanced correctly or has suffered deformation due to impacts. In this case it must be repaired or replaced

### After use

1. Switch the product off, disconnect it from the power supply and let it cool down.
2. Check, clean and store the product as described below.
3. Turn the adjustment lever (7) to the "HIGH" position

### Collection box

1. Inspect the collection box before each use. Do not use it if you find any damage
2. Clean the collection box after operation. Let the collection box dry thoroughly before storing to avoid mildew

## **Transportation**

1. Switch the product off and disconnect it from power supply before transporting it anywhere
2. Turn the adjustment lever (7) to the "HIGH" position
3. Attach transportation guards, if applicable
4. Always transport the product by its handle
5. Protect the product from any heavy impact or strong vibrations which may occur during transportation in vehicles.
6. Secure the product to prevent it from slipping or falling over.

## TROUBLE SHOOTING



### WARNING!

Only perform the steps described in these instructions! All further inspection, maintenance and repair work must be performed by a qualified specialist! Contact a specialist if the problem cannot be solved by yourself!



### WARNING!

The product does not perform properly, or sound are abnormal, or motor cannot be started, or stopped as described, or the cutting device does not work properly, or any other irregularity, or malfunction occurs, do not attempt to repair the product by yourself  
Please contact helpline or service center.



Before carrying out any maintenance operations, cut off the electric power supply by disconnecting the plug from the extension cable.

Problem	Possible cause	Solution
Product does not start	<ul style="list-style-type: none"> <li>- Not connected to power supply</li> <li>- Power cord or plug is defective</li> <li>- Other electrical defect to the product</li> <li>- Lock-off button not pressed</li> </ul>	<ul style="list-style-type: none"> <li>- Connect to power supply</li> <li>- Check by a specialist electrician</li> <li>- Check by a specialist electrician</li> <li>- Press lock-off button first, then the On/OFF lever</li> </ul>
Product does not reach full power	<ul style="list-style-type: none"> <li>- Extension cord not suitable for operation with this product</li> <li>- Power source (e.g. generator) has too low voltage</li> <li>- Air vents are blocked</li> </ul>	<ul style="list-style-type: none"> <li>- Use a proper extension cord</li> <li>- Connect to another power source</li> <li>- Clean the air vents</li> </ul>
Poor result	<ul style="list-style-type: none"> <li>- Cutting device is dull/damaged</li> <li>- Scarified/raked material exceeds capacity</li> <li>- Scarifying/raking depth is incorrect</li> </ul>	<ul style="list-style-type: none"> <li>- Replace with a new one</li> <li>- Only scarify/rake materials according to capacity of the product</li> <li>- Adjust depth</li> </ul>

## DECLARATION OF CONFORMITY / PERFORMANCE



**Product Code: 24959/WR6005-1500**

**Product Description: 2 in 1 Electric Raker and Scarifier**

1. Toolstation Limited, Express Park, Bristol Road, Bridgwater, Somerset TA6 4RN

This declaration of conformity is issued under the sole responsibility of Toolstation

### 2. Object of the declaration

The object of the declaration described above is in conformity with the relevant Community harmonization legislation:

Supply of Machinery (Safety) Regulations 2008

2006/42/EC

Electromagnetic Compatibility Regulations 2016

2014/30/EU

The Restriction of the Use of Certain Hazardous Substances in Electrical and Electronic Equipment Regulations 2012

2011/65/EU&(EU)2015/863

Noise Emission in the Environment by Equipment for use Outdoors Regulations 2001

2000/14/EC amended by 2005/88/EC

- Conformity assessment Procedure as per Annex VI

- Measured Sound Power Level 96.75 dB(A)

- Declared Guaranteed Sound Power Level 98 dB(A)

3. References to the relevant standards used (or references to the specifications in relation to which conformity is declared:

BS EN 60335-1, BS EN 55014-1, BS EN 55014-2, BS EN IEC 61000-3-2, BS EN 61000-3-3,

BS EN 50636-2-92

4. Additional information:

Signed for and on behalf of Toolstation Limited

## ENVIRONMENTAL INFORMATION



The symbol on the product or its packaging indicates that this product must not be disposed of with your other household waste. Instead, it is your responsibility to dispose of your waste equipment by handing it over to a designated collection point for the recycling of waste electrical and electronic equipment. The separate collection and recycling of your waste equipment at the time of disposal will help conserve natural resources and ensure that it is recycled in a manner that protects human health and the environment. For more information about where you can drop off your waste for recycling, please contact your local authority, or where you purchased your product.

## GUARANTEE

Toolstation products deliver reliable service for normal, household use in domestic settings. All Toolstation products are individually tested before leaving the factory.

If you are a consumer and you experience a problem with your Toolstation product, which is found to be defective due to faulty materials or workmanship within the Guarantee Period, this Toolstation Guarantee will cover repair or - at the discretion of Toolstation – replacement with a functionally equivalent Toolstation product.

Your product is under guarantee for 2 year from the date of purchase or the date of delivery of the product, if later.

The guarantee is subject to the following provisions:

- The guarantee does not cover accidental damage, misuse, cabinet parts, knobs, or consumable items.
- The product must be correctly installed and operated in accordance with the instructions contained in this manual.
- It must be used solely for domestic purpose.
- The guarantee will be rendered invalid if the product is re-sold or has been damaged by inexpert repair.
- Specifications are subject to change without notice.
- The manufacturer disclaims any liability for the incidental or consequential damages.
- The guarantee is in addition to, and does not diminish your statutory or legal rights.

## CUSTOMER SUPPORT

[www.coreservice.co.uk](http://www.coreservice.co.uk)

Call us +44 01904 947568

Email: [support@coreservice.co.uk](mailto:support@coreservice.co.uk)

Made in China