

# User Instructions

# Mono Basin Mixer

95737 (V1)

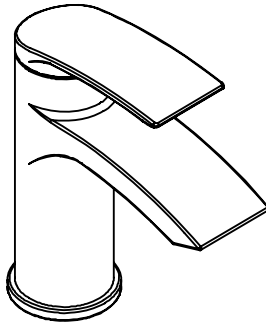

## WHAT'S IN THE BOX

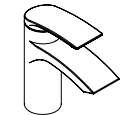

Tap Body x1



Flange x1



Sealing Washer x1



Rubber Horseshoe Washer x1



Metal Horseshoe Washer x1



Fixing Stud x1



Fixing Nut x1



Waste Body x1



Sealing Washer x1



Backnut Washer x1



Backnut x1



Braided Connector x2

If you need any help, please contact us:

0808 100 7211 or 0330 333 3303

PLEASE KEEP THESE INSTRUCTIONS FOR FUTURE REFERENCE

## TOOLS REQUIRED ( tools not supplied )

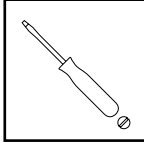

## HEALTH AND SAFETY

- Identify all components and check pack contents.
- Turn off mains water supply.
- Prior to drilling into walls, check that there are no hidden electrical wires, cables or water supply pipes. This can be checked with the aid of an electronic detector.
- Wear eye protection.
- This mixer should be installed in compliance with the UK Water Supply (Water Fittings) Regulations.

## SPECIFICATION

- The mixer is suitable for use at water supply pressures of 0.3 bar (min.) to 5 bar (max.).
- This pressure rating is determined by the manufacturer using soft water under test house conditions and may differ to the retailer's recommendation.

## ASSEMBLY AND USE

### Fitting the mixer body:

1. Fit Fixing Studs (4) to Tap Body (1) and tighten.
2. Make sure that Sealing Washer (3) has been fitted to Flange (2). Fit Flange (2) to the Tap Body (1).
3. Screw 2x Braided connectors (8) into Tap Body (1) through the hole of the flange, do not over tighten.
4. Locate the tap assembly down through the tap hole in basin.
5. Fit Rubber Horseshoe Washer (5) and Metal Horseshoe Washer (6) onto the Fixing Studs (4). And then fix Fixing Nuts (7) onto the Fixing Studs (4). Do not over tighten.
6. Fit Braided Connectors (8) to the water supply using suitable plumbing joints.
7. Fit Waste Body (9) with Sealing Washer (10) through hole in basin. It is advisable at this stage to use small bead of silicone sealant between waste body and basin.
8. Fit Backnut Washer (11) over threaded part of waste body and screw Backnut (12) onto waste body. Do not overtighten.
9. Turn on the hot and cold and mains water supply. Check for leaks immediately. It is always advisable at this stage to flush out the system. To do this, open both valves fully and allow water to flow for approximately 1 minute. This will remove any foreign matter within the installation.
10. Finally turn on all the water heating arrangements.

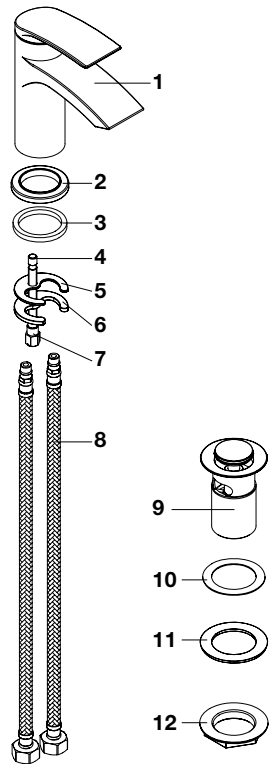

## CARE AND CLEANING

Whilst modern plating techniques are used in the manufacture of these fittings, the plating will wear if not cleaned properly. The safest way to clean your product is to wipe with a soft damp cloth. Stains can be removed using washing up liquid. All cleaning powders and liquids will damage the surface of your fitting even the non-scratch cleaners.

## TROUBLE SHOOTING

PROBLEM	CAUSE	REMEDY
No flow or low flow rate	Partially closed isolation valve.	Open isolation valve.
	Airlock or partial blockage in the supply pipework.	Flush through pipework to ensure removal of debris and any airlocks.
	Head of water is below the minimum distance required.	Refer to specification for minimum distance required.
Water dripping from taps	This is normal for a short time after using the taps.	This is caused by residual water tension, the build up of water in the tap body.
	If water continues to drip, possibly due to the ceramic disc valves	Remove valves and clean.
Taps do not turn on	Mains water supply turned off.	Turn on mains water supply.
	Closed isolation valve.	Open isolation valve.

## CUSTOMER SUPPORT

[www.toolstation.com/contact](http://www.toolstation.com/contact)

Call us 0808 100 7211

Mobile friendly 0330 333 3303

Email [info@toolstation.com](mailto:info@toolstation.com)

Made in china